



# INSTALLATION



## DELUXE OIL LINE NACELLE 8395

**FITS: '07-UP SOFTAIL MODELS (EX. '07-'08 FXSTSSE)**

### PARTS INCLUDED

- 1 Deluxe Oil Line Nacelle
- 1 Hardware Kit, including:
  - 2 10-24 x 3/8 Button Socket Cap Screws (BSCS)
  - 2 10-24 x 1-1/4 Phillips Head Pan Machine Screws (PHPMS)
  - 2 #10 Split Lock Washer
  - 1 Front Oil Fitting Clamp
  - 1 Rear Oil Fitting Clamp
- 1 Installation Instructions

*Please read and understand entire instructions before starting installation.*

### THANK YOU FOR CHOOSING KÜRYAKYN!

**IN ORDER TO PROTECT YOU AND OTHERS FROM POSSIBLE INJURY AND/OR PROPERTY DAMAGE OR LOSS, PLEASE PAY CLOSE ATTENTION TO ALL INSTRUCTIONS, WARNINGS, CAUTIONS AND ATTENTION NOTES REGARDING THE USE AND CARE OF THIS PRODUCT.**

**WARNING!** THIS INDICATION ALERTS YOU TO THE FACT THAT IGNORING THE CONTENTS DESCRIBED HEREIN CAN RESULT IN POTENTIAL DEATH OR SERIOUS INJURY.

**ATTENTION!** This indication alerts you to the fact that ignoring the contents described herein may negatively affect product performance and functionality.

### TOOLS SUGGESTED

Set of hex wrenches, Phillips head screwdriver, combination wrenches, socket set and ratchet.

**STRICTLY OBSERVE THE FOLLOWING GUIDELINES IN ORDER TO USE THE PRODUCT PROPERLY AND AVOID POTENTIALLY DANGEROUS ACCIDENTS.**

### PROCEDURE

**STEP 1** Park the motorcycle on a hard, level surface; turn off the ignition and allow the engine to cool.

**WARNING!** YOU WILL BE WORKING AROUND THE ENGINE AND EXHAUST SYSTEM DURING INSTALLATION. ENSURE THAT THE ENGINE AND EXHAUST SYSTEM HAVE FULLY COOLED TO PREVENT INJURY.

**ATTENTION!** Some applications will require loosening or removal of the exhaust for installation. The exhaust has been removed in these installation instructions for clarity.

**STEP 2** Position the rear oil fitting clamp behind the oil lines as shown in PIC. 1.

**-cont.-**

### CUSTOMER SERVICE

877.370.3604 (toll free)

### INSTALLATION QUESTIONS

techsupport@kuryakyn.com  
or call 715.247.2983

### LIMITED WARRANTY

Kuryakyn warrants that any Kuryakyn products sold hereunder, shall be free of defects in materials and workmanship for a period of one (1) year from the date of purchase by the consumer excepting the following provisions:

- Kuryakyn shall have no obligation in the event the customer is unable to provide a receipt showing the date the customer purchased the product(s).
- The product must be properly installed, maintained and operated under normal conditions.
- Kuryakyn makes no warranty, expressed or implied, with respect to any gold plated products.
- Kuryakyn shall not be liable for any consequential and incidental damages, including labor and paint, resulting from failure of a Kuryakyn product, failure to deliver, delay in delivery, delivery in non-conforming condition, or for any breach of contract or duty between Kuryakyn and a customer.
- Kuryakyn products are often intended for use in specific applications. Kuryakyn makes no warranty if a Kuryakyn product is used in applications other than intended.
- Kuryakyn electrical products are warranted for one (1) year from the date of purchase by the consumer. Components of Kuryakyn products containing L.E.D.s will be warranted for defects in materials and workmanship for 3 years from the date of purchase.
- Kuryakyn makes no warranty of any kind in regard to other manufacturer's products distributed by Kuryakyn. Kuryakyn will pass on all warranties made by the manufacturer and where possible, will expedite the claim on behalf of the customer, but ultimately, responsibility for disposition of the warranty claim lies with the manufacturer.

### ABOUT OUR CATALOG

You'll find all our innovations for H-D, GL and Metric Cruisers in our annual catalogs. Order online today—select the "CATALOGS" icon. Each Kuryakyn® product comes with a Proof-of-Purchase good for a complimentary catalog. Details in packaging.

Be sure to ask your local dealer about other Kuryakyn® products, the motorcycle parts and accessories designed for riders by riders.

©2005 Kuryakyn USA® All Rights reserved.



**STEP 3** Hold the front oil fitting clamp against the oil fittings and secure it to the rear clamp with the two included 10-24 x 1-1/4 PHPMS; tighten the two screws. See [PIC. 2](#).

**STEP 4** Maneuver the Deluxe Oil Line Nacelle into place. Slide the top section of the oil line nacelle behind the oil lines first then position the bottom section against the oil line clamp.

**STEP 5** Align the two holes in the oil line nacelle and the threaded holes in the oil line clamp.

**STEP 6** Secure the oil line nacelle to the clamp using the two included 10-24 x 3/8 BSCS; align the oil line nacelle and tighten the screws.

**STEP 7** Ensure proper clearance and operation before riding the motorcycle.

**ATTENTION!** It is the installer's responsibility to ensure that all of the fasteners (including pre-assembled) are tightened before operation of the motorcycle. Kuryakyn will not warranty components lost due to improper installation. Periodic maintenance may be required.

*Ride On!*

**Kuryakyn**<sup>®</sup>

**PIC. 1**

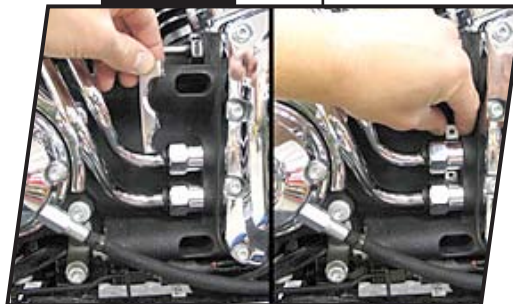

**PIC. 2**



PAGE

**2**