



INNER PRIMARY COVER

8377

MID-CONTROL DYNA

FITS: '06-UP DYNA MODELS WITH MID-MOUNT CONTROLS

PARTS INCLUDED

- 1 Inner Primary Front Cover
- 1 Inner Primary Rear Cover
- 1 Hardware Kit containing:
 - 1 1/4"-20 x 4-1/4" Socket Head Cap Screw (SHCS)
 - 1 1/4"-20 x 1-1/2" Socket Head Cap Screw (SHCS)
 - 1 10-24 High Crown Acorn Nut
 - 4 Hot Spots
 - 3 Aluminum Locating Washer
- 1 Installation Instructions

Please read and understand entire instructions before starting installation.

THANK YOU FOR CHOOSING KÜRYAKYN!

IN ORDER TO PROTECT YOU AND OTHERS FROM POSSIBLE INJURY AND/OR PROPERTY DAMAGE OR LOSS, PLEASE PAY CLOSE ATTENTION TO ALL INSTRUCTIONS, WARNINGS, CAUTIONS AND ATTENTION NOTES REGARDING THE USE AND CARE OF THIS PRODUCT.

WARNING! THIS INDICATION ALERTS YOU TO THE FACT THAT IGNORING THE CONTENTS DESCRIBED HEREIN CAN RESULT IN POTENTIAL DEATH OR SERIOUS INJURY.

ATTENTION! This indication alerts you to the fact that ignoring the contents described herein may negatively affect product performance and functionality.

TOOLS SUGGESTED

Set of hex wrenches, set of combination wrenches and a torque wrench with hex sockets/bits.

STRICTLY OBSERVE THE FOLLOWING GUIDELINES IN ORDER TO USE THE PRODUCT PROPERLY AND AVOID POTENTIALLY DANGEROUS ACCIDENTS.

PROCEDURE

STEP 1 Park the motorcycle on a hard, level surface; turn off the ignition and allow the engine to cool. Read and understand all the steps in the instructions before starting the installation.

WARNING! YOU WILL BE WORKING AROUND THE ENGINE AND EXHAUST SYSTEM DURING INSTALLATION. ENSURE THAT THE ENGINE AND EXHAUST SYSTEM HAVE FULLY COOLED TO PREVENT INJURY.

-cont.-

CUSTOMER SERVICE

877.370.3604 (toll free)

INSTALLATION QUESTIONS

techsupport@kuryakyn.com
or call 715.247.2983

LIMITED WARRANTY

Kuryakyn warrants that any Kuryakyn products sold hereunder, shall be free of defects in materials and workmanship for a period of one (1) year from the date of purchase by the consumer excepting the following provisions:

- Kuryakyn shall have no obligation in the event the customer is unable to provide a receipt showing the date the customer purchased the product(s).
- The product must be properly installed, maintained and operated under normal conditions.
- Kuryakyn makes no warranty, expressed or implied, with respect to any gold plated products.
- Kuryakyn shall not be liable for any consequential and incidental damages, including labor and paint, resulting from failure of a Kuryakyn product, failure to deliver, delay in delivery, delivery in nonconforming condition, or for any breach of contract or duty between Kuryakyn and a customer.
- Kuryakyn products are often intended for use in specific applications. Kuryakyn makes no warranty if a Kuryakyn product is used in applications other than intended.
- Kuryakyn electrical products are warranted for one (1) year from the date of purchase by the consumer. Components of Kuryakyn products containing L.E.D.s will be warranted for defects in materials and workmanship for 3 years from the date of purchase.
- Kuryakyn makes no warranty of any kind in regard to other manufacturer's products distributed by Kuryakyn. Kuryakyn will pass on all warranties made by the manufacturer and where possible, will expedite the claim on behalf of the customer, but ultimately, responsibility for disposition of the warranty claim lies with the manufacturer.

ABOUT OUR CATALOG

You'll find all our innovations for H-D, GL and Metric Cruisers in our annual catalogs. Order online today—select the "CATALOGS" icon. Each Kuryakyn product comes with a Proof-of-Purchase good for a complimentary catalog. Details in packaging.

Be sure to ask your local dealer about other Kuryakyn products, the motorcycle parts and accessories designed for riders by riders.

©2005 Kuryakyn USA All Rights reserved.



STEP 2 Remove the stock fasteners shown in [PIC.1](#); the one marked "A" will be re-used.

STEP 3 Slide the rear inner primary cover into place, insert the stock fastener removed in STEP 2 through the mounting hole and place a locating washer over the protruding end of the fastener. The tapered end of the washer will face the stock inner primary cover. Loosely secure the cover.

STEP 4 Position the front cover over the rear cover; ensure that the hole in the front cover fits over the threaded stud in the rear cover, see [PIC.2](#).

STEP 5 Loosely secure the covers together with the included acorn nut; leave the nut finger tight for now.

STEP 6 Install the included Socket Head Cap Screws shown in [PIC.3](#) with the included Locating Washers on the back side of the cover. The tapered end will face the stock inner primary cover; leave them finger tight for now.

NOTE Ensure that the covers are properly aligned and that they do not interfere with the shift linkage.

STEP 7 Torque all three of the Socket Head Cap Screws to 108-120 in-lbs (12.2-13.6 Nm).

STEP 8 Tighten the acorn nut.

STEP 9 Push the Hot Spots into the four screw heads shown in [PIC.3](#).

STEP 10 Ensure proper clearance of moving parts before operating the motorcycle.

ATTENTION! It is the installer's responsibility to ensure that all of the fasteners (including pre-assembled) are tightened before operation of the motorcycle. Kuryakyn will not warranty components lost due to improper installation. Periodic maintenance may be required.

Ride On!

Kuryakyn

PIC.1

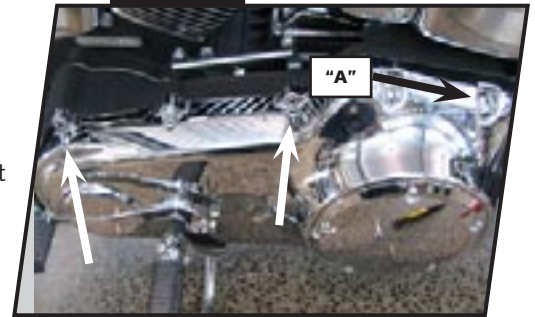

PIC.2



PIC.3

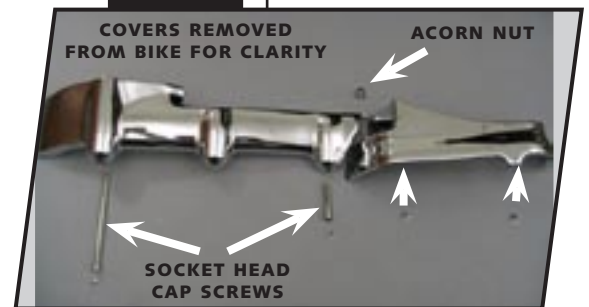

PAGE

2

INNER PRIMARY COVER

INSTALLATION