



INSTALLATION

BLUETOOTH SOUND of CHROME

834

PARTS INCLUDED

- 2 Bluetooth Speaker Assemblies
- 2 1" Handlebar Clamp Assemblies
- 2 Stereo Plug Harnesses for Bluetooth-one 8" long and one 18" long
- 1 Fuse & Noise Filter Wiring Harness
- 1 Hardware Kit Including:
 - 2 5/16"-18 x 2" Socket Head Cap Screws
 - 4 5/16" Lock Washers
 - 8 8" Cable Ties
 - 1 Dielectric Grease
 - 1 Anti-Seize Packet
- 1 Installation Instructions

Please read and understand entire instructions before starting installation.

THANK YOU FOR CHOOSING KÜRYAKYN!

IN ORDER TO PROTECT YOU AND OTHERS FROM POSSIBLE INJURY AND/OR PROPERTY DAMAGE OR LOSS, PLEASE PAY CLOSE ATTENTION TO ALL INSTRUCTIONS, WARNINGS, CAUTIONS AND NOTICES REGARDING THE USE AND CARE OF THIS PRODUCT.

WARNING

THIS INDICATION ALERTS YOU TO THE FACT THAT IGNORING THE CONTENTS DESCRIBED HEREIN CAN RESULT IN POTENTIAL DEATH OR SERIOUS INJURY.

NOTICE

This indication alerts you to the fact that ignoring the contents described herein may negatively affect product performance and functionality.

NOTICE

IF INSTALLING THIS PRODUCT FOR ANOTHER PARTY, PLEASE MAKE SURE THEY RECEIVE THIS COPY OF THE INSTALLATION INSTRUCTIONS SO THEY ARE AWARE OF THE IMPORTANT INFORMATION CONTAINED IN THEM.

TOOLS SUGGESTED

Set of Hex Wrenches, Set of Combination Wrenches, Socket Set and Ratchet

STRICTLY OBSERVE THE FOLLOWING GUIDELINES IN ORDER TO USE THE PRODUCT PROPERLY AND AVOID POTENTIALLY DANGEROUS ACCIDENTS.

STEP 1

Read and understand all steps in the instructions before starting the installation. Park the motorcycle on a hard, level surface and turn off the ignition. Let cool.

NOTICE

It is the end user's responsibility to record the Bluetooth PIN number in the box below and retain these instructions for your records. Kuryakyn does not keep records of these PIN numbers and the speakers CANNOT be reprogrammed if you lose this PIN. Kuryakyn WILL NOT issue a warranty for lost PINs. The PIN is located on the label attached to the wiring harness of the speaker and on the white connector. PIC 1

RECORD PIN NUMBER HERE OR ON BACK PAGE

834-23MC-1113

-cont.-

CUSTOMER SERVICE

877.370.3604 (toll free)

INSTALLATION QUESTIONS

techsupport@kuryakyn.com
or call 715.247.2983

LIMITED WARRANTY

Kuryakyn warrants that any Kuryakyn products sold hereunder, shall be free of defects in materials and workmanship for a period of one (1) year from the date of purchase by the consumer excepting the following provisions:

- Kuryakyn shall have no obligation in the event the customer is unable to provide a receipt showing the date the customer purchased the product(s).
- The product must be properly installed, maintained and operated under normal conditions.
- Kuryakyn makes no warranty, expressed or implied, with respect to any gold plated products.
- Kuryakyn shall not be liable for any consequential and incidental damages, including labor and paint, resulting from failure of a Kuryakyn product, failure to deliver, delay in delivery, delivery in nonconforming condition, or for any breach of contract or duty between Kuryakyn and a customer.
- Kuryakyn products are often intended for use in specific applications. Kuryakyn makes no warranty if a Kuryakyn product is used in applications other than intended.
- Kuryakyn electrical products are warranted for one (1) year from the date of purchase by the consumer. L.E.D.'S contained in components of Kuryakyn products will be warranted for defects in materials and workmanship for 3 years from the date of purchase where as all other components shall be warranted for one(1) year. This includes, but is not limited to; control modules, wiring, chrome & other components.
- Kuryakyn makes no warranty of any kind in regard to other manufacturer's products distributed by Kuryakyn. Kuryakyn will pass on all warranties made by the manufacturer and where possible, will expedite the claim on behalf of the customer, but ultimately, responsibility for disposition of the warranty claim lies with the manufacturer.

ABOUT OUR CATALOG

For purchasing Kuryakyn® products, you can receive a complete catalog free of charge.

Send the Proof-of-Purchase below with your address to: Kuryakyn, P.O. Box 339, Somerset, WI 54025.

Please indicate either Accessories Catalog for Harley-Davidson® or GL & Metric Cruisers.

Be sure to ask your local dealer about other Kuryakyn® products, the motorcycle parts and accessories designed for riders by riders.

©2005 Kuryakyn USA® All Rights reserved.

kuryakyn.com





WARNING YOU WILL BE WORKING AROUND THE ENGINE AND EXHAUST SYSTEM DURING INSTALLATION. ENSURE THAT THE ENGINE AND EXHAUST SYSTEM HAVE FULLY COOLED TO PREVENT INJURY.

Kuryakyn®

STEP 2 Cover the gas tank and front fender with a service cover, or a soft, clean blanket.

STEP 3 Determine a location to install the clamps so that there will be sufficient clearance for the speakers. PIC 2 shows several mounting options.

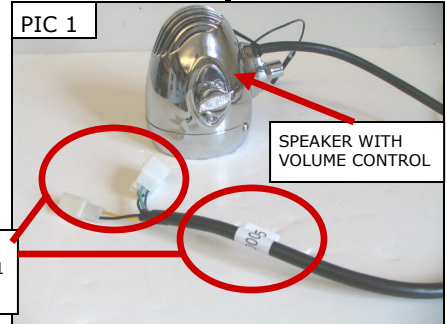

STEP 4 Remove the screws from the clamp, install the clamp on the handlebars, and make sure that no wires are being pinched; place a small amount of anti-seize to the screws and reinstall them, only tightening them enough to prevent the clamps from rotating. PIC 3

NOTE: The clamps may be installed in different directions/positions as needed for sufficient clearance.

NOTICE

Be sure to use the supplied anti-seize on all threaded fasteners before installation. This will reduce galling and make future removal of the fasteners easier.

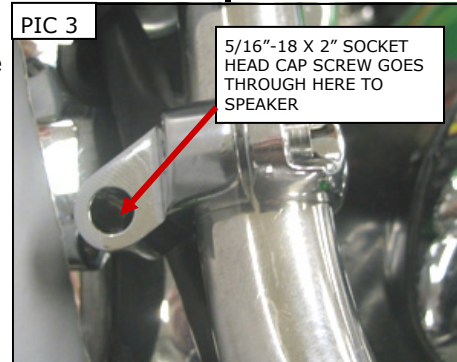

STEP 5 Place a 5/16\" lock washer on one of the 5/16\"-18 x 2\" Socket Head Cap Screws and insert it in the bracket as shown in PIC 3. Place another 5/16\" lock washer over the protruding threads and place a small amount of anti-seize to the threads and secure into the bottom of the speaker. Do not tighten yet.

NOTE: The speakers are not side specific, though we recommend placing the speaker with the volume control knob on the clutch side.

STEP 6 Sit on the bike and adjust the speakers to desired location.

NOTE: The speakers are directional and for best results need to be pointed towards the rider's head.

STEP 7 Turn the handlebars in both directions to their full stop position and ensure that there is clearance between the speakers and the gas tank, dash and other accessories in all positions.



WARNING ENSURE THAT THERE IS CLEARANCE AT ALL POINTS WHEN THE HANDLEBARS ARE TURNED, INSUFFICIENT CLEARANCE MAY CAUSE DAMAGE TO THE MOTORCYCLE OR CAN CAUSE LOSS OF CONTROL THAT COULD RESULT IN SEVERE INJURY OR DEATH.

-cont.-

PAGE
2

BLUETOOTH SOUND of CHROME

INSTALLATION

STEP 8 Adjust the speakers and clamps as necessary to achieve sufficient clearance.

STEP 9 Tighten the screws that secure the clamps and the 5/16"-18 x 2" Socket Head Cap Screws that secure the speakers.

STEP 10 Route the wiring from the speakers along the handlebars and down towards the neck; secure the wires with the included cable ties.

STEP 11 Remove the seat and/or the side cover (depending on model) to gain access to the battery.

STEP 12 Find a location under the seat (or some other out of the way area) to mount/locate the noise filter, and that the power wires from the filter will reach the terminals on the battery. PIC 4

STEP 13 Secure the noise filter with the included cable ties.

STEP 14 Route the harness from the noise filter under the gas tank towards the handlebars. Use the include cable ties from the hardware kit to secure the wiring harness out of the way of pinch points, extreme heat and moving parts.

NOTICE Secure all wiring away from any moving parts, pinch points or extreme heat. Küryakyn WILL NOT warranty any electrical component that fails due to pinched, crimped, broken, abraded, melted or frayed wires.

STEP 15 Refer to PIC. 5 and connect the wiring harnesses together using dielectric grease from the hardware kit on the connections.

NOTICE Küryakyn recommends the use of dielectric grease on electrical connections.

STEP 16 Connect the power wires from the noise filter to the terminals on the battery. The **BLACK** wire from the filter is a ground wire and needs to be attached to the negative terminal on the battery. The **RED** wire from the filter (with in-line fuse) is a power wire and needs to be attached to the positive terminal on the battery.

STEP 17 Bundle the excess wire together with a cable tie. Secure in a location that is out of the way, and away from, pinch points, moving parts or extreme heat. Secure the Bluetooth antenna (PIC 6) to your chosen location using the double-sided tape attached to it.

NOTICE Secure all wiring away from any moving parts, pinch points or extreme heat. Küryakyn WILL NOT warranty any electrical component that fails due to pinched, crimped, broken, abraded, melted or frayed wires.

STEP 18 Reinstall the seat and/or side cover.

WARNING AFTER INSTALLING THE SEAT, PULL UP ON IT TO ENSURE IT IS LOCKED INTO PLACE. A LOOSE SEAT CAN SHIFT AND CAUSE LOSS OF CONTROL RESULTING IN SERIOUS INJURY OR DEATH.

NOTICE It is the installer's responsibility to ensure that all of the fasteners (including pre-assembled) are tightened before operation of the motorcycle. Küryakyn will not warranty components lost due to improper installation. Periodic maintenance may be required.

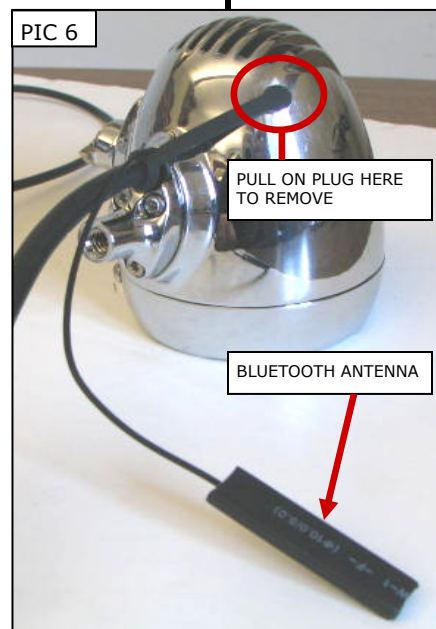
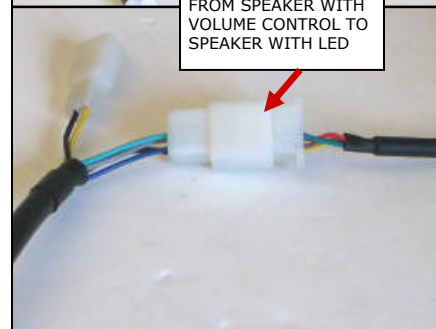
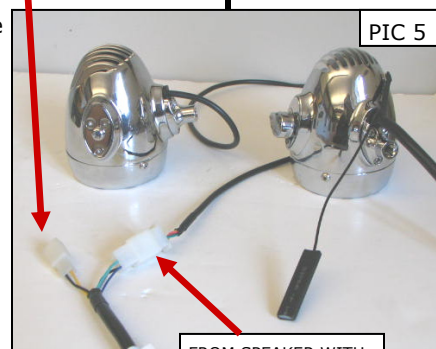
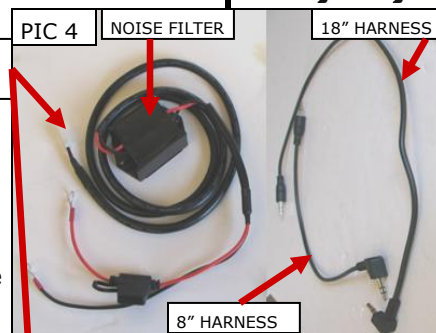

NOTICE

These speakers are designed to receive Bluetooth MUSIC ONLY! They ARE NOT designed for any other Bluetooth activities.

Küryakyn®

PAIRING THE SPEAKERS AND BLUETOOTH DEVICE

1. Turn **ON** speakers.
2. Turn **ON** Bluetooth of your device and search for the BT Speaker device named "Headset", "Kuryakyn SPK", or "Kuryakyn SPK 4.0" (depending on your device).
3. Pair the speakers to the device by entering the PIN number (PIC 1) found on the label of the wiring harness connected to the speaker with the volume control and the white connector.
4. Listen for an activation beep from the speakers. When sounded, you can turn on the music.
5. Turn speakers **OFF** when done listening to your music. If the speakers are left on without the motorcycle running, they will drain the battery as they are wired direct.

NOTE: Make sure the rubber plug is in place when not using the 3.5mm jack in the speaker housing. When removing the rubber plug to use the 3.5mm jack on the speaker, make sure to pull on the round plug and not on the rubber strap. PIC 6 Use either the 8" or 18" (PIC 4) included Stereo Plug Harness if no Bluetooth is desired.

NOTE: Depending on conditions, the maximum operating distance of the Bluetooth device from the speakers is approximately 50 FT.

NOTES ON BLUETOOTH CONNECTION

1. Manual reconnection is REQUIRED after a power down of either device or if the transmitting device is carried out of range of the speakers. The devices remain "paired" but the connection will be lost. The PIN number does not need to be re-entered unless the user has previously chosen to "forget" the Bluetooth speakers.
2. Incoming calls will interrupt the audio signal. Interruption of the signal will last as long as the incoming call rings. You may have to manually reconnect the two devices in some instances.
3. A short delay in connection time may occur if other Bluetooth devices are transmitting in the same area.
4. If you are experiencing difficulty in "pairing" or connecting with the speakers, try shutting off your Bluetooth connection for a few seconds then repeat the steps listed above to reconnect.
5. The **ONLY** PIN number that will work for your specific set of speakers is located on the white tag on the wiring harness and also on the white connector. Record the PIN number in the provided space below and keep this sheet for future use if necessary.
6. If you experience connection difficulty, shut the speakers off and allow them to "power down" for at least 30 seconds. Turn the speakers back on and try again.

RECORD PIN NUMBER HERE OR ON FRONT PAGE



WARNING

DO NOT ATTEMPT TO OPERATE THE SPEAKER VOLUME SWITCH, ADJUST YOUR MUSIC DEVICE OR RESYNC THE BLUETOOTH WHILE OPERATING THE MOTORCYCLE.

NOTICE

It is the end user's responsibility to record the Bluetooth PIN number in the box above and retain these instructions for your records. Küryakyn does not keep records of these PIN numbers and the speakers CANNOT be reprogrammed if you lose this PIN. Küryakyn WILL NOT issue a warranty for lost PINs. The PIN is located on the label attached to the wiring harness of the speaker with the On-Off Volume switch. PIC 1 on Page 2

PAGE

4

Ride On!

BLUETOOTH SOUND of CHROME

INSTALLATION

FCC STATEMENT:

FCC Caution: Any changes or modifications not expressly approved by the party responsible for compliance could void the user's authority to operate this equipment.

This device complies with Part 15 of the FCC Rules. Operation is subject to the following two conditions: (1) This device may not cause harmful interference, and (2) this device must accept any interference received, including interference that may cause undesired operation.

Note: This equipment has been tested and found to comply with the limits for a Class B digital device, pursuant to part 15 of the FCC Rules. These limits are designed to provide reasonable protection against harmful interference in a residential installation. This equipment generates, uses and can radiate radio frequency energy and, if not installed and used in accordance with the instructions, may cause harmful interference to radio communications. However, there is no guarantee that interference will not occur in a particular installation. If this equipment does cause harmful interference to radio or television reception, which can be determined by turning the equipment off and on, the user is encouraged to try to correct the interference by one or more of the following measures:

- Reorient or relocate the receiving antenna.
- Increase the separation between the equipment and receiver.
- Connect the equipment into an outlet on a circuit different from that to which the receiver is connected.
- Consult the dealer or an experienced radio/TV technician for help.

Küryakyn®

PAGE

5

Ride On!

BLUETOOTH SOUND of CHROME

INSTALLATION