



## L.E.D. HALO HEADLIGHT TRIM RING for FLST

# 7750

### PARTS INCLUDED

- 1 L.E.D. Halo Trim Ring for FLST Models with 7" Headlight
- 1 Inner Chrome Trim Ring
- 1 Hardware Kit, Including,
  - 3 4" Black Nylon Cable Ties
  - 4 Female T-Tap Scotch Lock Connectors
  - 4 Male Scotch Lock Connectors
  - 1 Wire Harness
  - 1 Dielectric Grease Pack
- 1 Installation Instructions

Please read and understand entire instructions before starting installation.

### THANK YOU FOR CHOOSING KÜRYAKYN!

**IN ORDER TO PROTECT YOU AND OTHERS FROM POSSIBLE INJURY AND/OR PROPERTY DAMAGE OR LOSS, PLEASE PAY CLOSE ATTENTION TO ALL INSTRUCTIONS, WARNINGS, CAUTIONS AND ATTENTION NOTES REGARDING THE USE AND CARE OF THIS PRODUCT.**

**WARNING!** THIS INDICATION ALERTS YOU TO THE FACT THAT IGNORING THE CONTENTS DESCRIBED HEREIN CAN RESULT IN POTENTIAL DEATH OR SERIOUS INJURY

**ATTENTION!** This indication alerts you to the fact that ignoring the contents described herein may negatively affect product performance and functionality.

**CAUTION!** This indication alerts you to the fact that ignoring the contents described herein can result in potential injury or material damage.

### TOOLS SUGGESTED

Phillips Screwdriver, Flat Blade Screwdriver, Set of Combination Wrenches

**STRICTLY OBSERVE THE FOLLOWING GUIDELINES IN ORDER TO USE THE PRODUCT PROPERLY AND AVOID POTENTIALLY DANGEROUS ACCIDENTS.**

**STEP 1** Read and understand all steps in the instructions before starting the installation. Park the motorcycle on a hard, level surface and turn off the ignition. Let cool.

**WARNING!** YOU WILL BE WORKING AROUND THE ENGINE AND EXHAUST SYSTEM DURING INSTALLATION. ENSURE THAT THE ENGINE AND EXHAUST SYSTEM HAVE FULLY COOLED TO PREVENT INJURY.

**CAUTION!** Avoid damage to the motorcycle. Protect painted surfaces with a soft cloth or blanket.

**ATTENTION!** A factory service manual may be helpful in performing this installation. Do not attempt to perform this installation if you are not confident in your ability to complete all of the steps in the procedure; consult a trained technician.

### CUSTOMER SERVICE

877.370.3604 (toll free)

### INSTALLATION QUESTIONS

techsupport@kuryakyn.com  
or call 715.247.2983

### LIMITED WARRANTY

Kuryakyn warrants that any Kuryakyn products sold hereunder, shall be free of defects in materials and workmanship for a period of one (1) year from the date of purchase by the consumer excepting the following provisions:

- Kuryakyn shall have no obligation in the event the customer is unable to provide a receipt showing the date the customer purchased the product(s).
  - The product must be properly installed, maintained and operated under normal conditions.
  - Kuryakyn makes no warranty, expressed or implied, with respect to any gold plated products.
  - Kuryakyn shall not be liable for any consequential and incidental damages, including labor and paint, resulting from failure of a Kuryakyn product, failure to deliver, delay in delivery, delivery in nonconforming condition, or for any breach of contract or duty between Kuryakyn and a customer.
- Kuryakyn products are often intended for use in specific applications. Kuryakyn makes no warranty if a Kuryakyn product is used in applications other than intended.
- Kuryakyn electrical products are warranted for one (1) year from the date of purchase by the consumer. L.E.D.'S contained in components of Kuryakyn products will be warranted for defects in materials and workmanship for 3 years from the date of purchase where as all other components shall be warranted for one(1) year. This includes, but is not limited to; control modules, wiring, chrome & other components.
- Kuryakyn makes no warranty of any kind in regard to other manufacturer's products distributed by Kuryakyn. Kuryakyn will pass on all warranties made by the manufacturer and where possible, will expedite the claim on behalf of the customer, but ultimately, responsibility for disposition of the warranty claim lies with the manufacturer.

### ABOUT OUR CATALOG

For purchasing Kuryakyn® products, you can receive a complete catalog free of charge. Send the Proof-of-Purchase below with your address to: Kuryakyn, P.O. Box 339, Somerset, WI 54025. Please indicate either Accessories Catalog for Harley-Davidson® or GL & Metric Cruisers.

Be sure to ask your local dealer about other Kuryakyn® products, the motorcycle parts and accessories designed for riders by riders.

©2005 Kuryakyn USA® All Rights reserved.



**STEP 2** Remove the screw from the bottom of the headlight trim ring and remove the trim ring. PIC 1 Set the trim ring aside, it will not be reused. If equipped, remove the rubber caps from the top of the two tabs on the top edge of the headlight housing. Set these aside, they will not be reused.

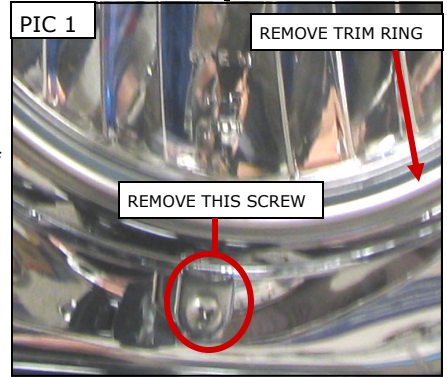

**STEP 3** If you are installing the L.E.D. Halo Trim Ring over a stock headlight, install the Inner Chrome Trim to the inside of the Trim Ring by pressing it in from the front of the front of the Halo Trim Ring. PIC 2 The Inner Chrome Trim Ring is tapered up towards the front edge and has notches on the back edge that will snap in behind the L.E.D. Halo light. If you are installing the L.E.D. Halo Trim Ring over a Kuryakyn/Truck Lite Phase 6 or Phase 7 L.E.D. headlight, the Inner Chrome Trim Ring **will not be used**. PIC 2

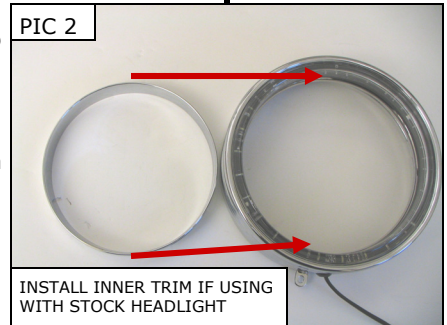

**NOTE:** If installing the L.E.D. Halo trim Ring over a Kuryakyn L.E.D. Headlight, you may have to loosen the three screws on the headlight retaining ring and gently push the light up. Tighten the screws while holding the light up as far as it will go inside the retaining ring.

**STEP 4** Line up the notches on the back edge of the L.E.D. Halo Trim Ring with the tabs on the top edge of the headlight housing and slide it on. PIC 3 Rotate the L.E.D. Halo Trim Ring clockwise around the headlight housing until the tab on the Trim Ring lines up with the tab on the bottom of the headlight bucket. Install the screw removed in Step 2. Tighten securely. PIC 4

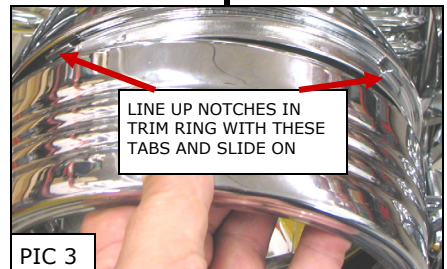

**ATTENTION!** It is the installer's responsibility to ensure that all of the fasteners (including pre-assembled) are tightened before operation of the motorcycle. Kuryakyn will not issue a warranty on components lost due to improper installation. Periodic maintenance may be required.

**STEP 5** Route the wire harness from the L.E.D. Halo light below the headlight and out the back of the headlight cowl. PIC 5 and PIC 6

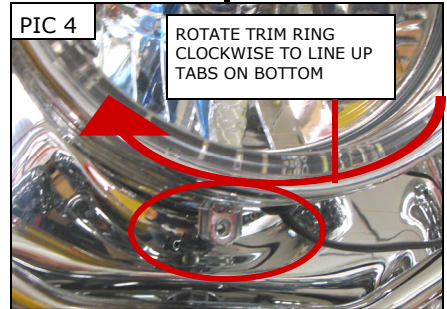

**STEP 6** Remove the seat.

**STEP 7** Plug the extension harness into the leads from the Halo Light—Red wire to Red wire, Black wire to Black wire.

**NOTE:** Wrap the connections with electrical tape to help prevent shorting out.

**ATTENTION!** Kuryakyn recommends the use of dielectric grease on electrical connections.

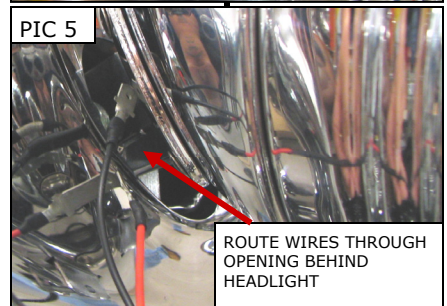

**STEP 8** **On '09 and later bikes:** Remove the nut that secures the dash to the tank. Route the extension harness under the dash and under the dash trim to the battery. PIC 7

**On '08 and earlier bikes:** Loosen the front tank bolts and remove the rear tank bolt to allow you to raise the rear of the tank. Route the extension harness under the tank and along the main harness to the battery. PIC 8 and PIC 9

-cont.-

**ATTENTION!** Secure all wiring away from any moving parts, pinch points or extreme heat. Küryakyn **WILL NOT** issue a warranty on any electrical component that fails due to pinched, crimped, broken, abraded, melted or frayed wires.

**STEP 9** Using a test light or the wiring schematic for your bike, turn the key **"ON"** and locate a **"keyed"** 12 volt power wire and a ground wire in the bike harness. Turn the key **"OFF"** and disconnect the battery. Install one of the included Female T-Tap connectors to each wire. PIC 10

**ATTENTION!** Küryakyn recommends the use of dielectric grease on electrical connections.

**STEP 10** Install one of the included Male Spade connectors to the RED wire in the extension harness and plug it into the Female T-Tap on the **"keyed"** power wire. PIC 10  
Install one of the included Male Spade connectors to the BLACK wire in the extension harness and plug it into the Female T-Tap on the ground wire. PIC 10

**STEP 11** Using the included Nylon Cable Ties, secure the extension harness out of the way of excessive heat and pinch points.

**ATTENTION!** Secure all wiring away from any moving parts, pinch points or extreme heat. Küryakyn **WILL NOT** issue a warranty on any electrical component that fails due to pinched, crimped, broken, abraded, melted or frayed wires.

**STEP 12** Reconnect the battery. Test the L.E.D. Halo Light for proper operation. Reinstall the seat.

