



**HIDDEN HORNS FOR DETACHABLES 7740**

**FITS: '93-UP ELECTRA GLIDES, ROAD KINGS, ROAD GLIDES, STREET GLIDES WITH OR WITHOUT DETACHABLE HARDWARE**

**PARTS INCLUDED**

- 1 Horn Bracket Assembly
- 1 Main Wiring Harness
- 1 Hardware Kit Including:
  - 1 Air Line Relocation Bracket
  - 1 Air Line Hose
  - 4 18" 8mm i.d. Sheathing
  - 10 Cable Ties
  - 2 Dielectric Grease Packets
  - 1 Y-Harness
  - 2 Shim Washers
  - 2 5/16-18 x 1" Hex Head Cap Screws (HHCS)
  - 2 5/16" Split Lock Washers
- 1 Installation Instructions

Please read and understand entire instructions before starting installation.

**THANK YOU FOR CHOOSING KÜRYAKYN!**

**IN ORDER TO PROTECT YOU AND OTHERS FROM POSSIBLE INJURY AND/OR PROPERTY DAMAGE OR LOSS, PLEASE PAY CLOSE ATTENTION TO ALL INSTRUCTIONS, WARNINGS, CAUTIONS AND ATTENTION NOTES REGARDING THE USE AND CARE OF THIS PRODUCT.**

**WARNING!** THIS INDICATION ALERTS YOU TO THE FACT THAT IGNORING THE CONTENTS DESCRIBED HEREIN CAN RESULT IN POTENTIAL DEATH OR SERIOUS INJURY.

**ATTENTION!** This indication alerts you to the fact that ignoring the contents described herein may negatively affect product performance and functionality.

**TOOLS SUGGESTED**

Set of hex wrenches, combination wrenches, socket set and ratchet.

**STRICTLY OBSERVE THE FOLLOWING GUIDELINES IN ORDER TO USE THE PRODUCT PROPERLY AND AVOID POTENTIALLY DANGEROUS ACCIDENTS.**

**NOTE** There are two different mounting options, please refer to the appropriate mounting section for your situation.

**MOUNTING PROCEDURE FOR MOTORCYCLES WITHOUT H-D DETACHABLE DOCKING KITS OR REAR DETACHABLE DOCKING KIT ONLY**

**STEP 1** Read and understand all steps in the instructions before starting the installation  
Park the motorcycle on a hard, level surface; turn off the ignition and allow the engine to cool.

**CUSTOMER SERVICE**  
877.370.3604 (toll free)

**INSTALLATION QUESTIONS**  
techsupport@kuryakyn.com  
or call 715.247.2983

**LIMITED WARRANTY**

Kuryakyn warrants that any Kuryakyn products sold hereunder, shall be free of defects in materials and workmanship for a period of one (1) year from the date of purchase by the consumer excepting the following provisions:

- Kuryakyn shall have no obligation in the event the customer is unable to provide a receipt showing the date the customer purchased the product(s).
- The product must be properly installed, maintained and operated under normal conditions.
- Kuryakyn makes no warranty, expressed or implied, with respect to any gold plated products.
- Kuryakyn shall not be liable for any consequential and incidental damages, including labor and paint, resulting from failure of a Kuryakyn product, failure to deliver, delay in delivery, delivery in non-conforming condition, or for any breach of contract or duty between Kuryakyn and a customer.
- Kuryakyn products are often intended for use in specific applications. Kuryakyn makes no warranty if a Kuryakyn product is used in applications other than intended.
- Kuryakyn electrical products are warranted for one (1) year from the date of purchase by the consumer. Components of Kuryakyn products containing L.E.D.s will be warranted for defects in materials and workmanship for 3 years from the date of purchase.
- Kuryakyn makes no warranty of any kind in regard to other manufacturer's products distributed by Kuryakyn. Kuryakyn will pass on all warranties made by the manufacturer and where possible, will expedite the claim on behalf of the customer, but ultimately, responsibility for disposition of the warranty claim lies with the manufacturer.

**ABOUT OUR CATALOG**

You'll find all our innovations for H-D, GL and Metric Cruisers in our annual catalogs. Order online today—select the "CATALOGS" icon. Each Kuryakyn® product comes with a Proof-of-Purchase good for a complimentary catalog. Details in packaging.

Be sure to ask your local dealer about other Kuryakyn® products, the motorcycle parts and accessories designed for riders by riders.

©2005 Kuryakyn USA® All Rights reserved.

-cont.-



**WARNING! YOU WILL BE WORKING AROUND THE ENGINE AND EXHAUST SYSTEM DURING INSTALLATION. ENSURE THAT THE ENGINE AND EXHAUST SYSTEM HAVE FULLY COOLED TO PREVENT INJURY.**

**STEP 2** Remove the right saddlebag from the motorcycle and set on a soft, clean and stable surface.

**STEP 3** Make note of the position of the rear bracket and remove the screw that secures the bracket as shown in PIC. 1.

**STEP 4** Place the horn bracket assembly on the saddlebag support bracket so that the alignment tab on the backside of the horn bracket sits in the square hole shown in PIC. 1; reinstall the rear bracket and hardware to secure the top of the horn bracket as shown in PIC. 2.

**STEP 5** Place a shim washer behind the lower bracket mounting hole and insert the 5/16-18 x 1" HHCS screw and 5/16" lock washer to secure the bracket as shown in PIC. 2.

**NOTE:** For motorcycles with rear detachable docking kit the spacer is not used; remove the screw securing the lower portion of the rear docking kit, place the horn bracket over the lower mounting hole and secure with the included screw and lock washer.

**STEP 6** Loosen the screws that secure the clamps around the horns (PIC. 2)

**WARNING! ROTATE THE HORNS TO ACHIEVE CLEARANCE WITH ALL MOVING AND NON-MOVING PARTS (FENDER, SHOCK, WHEEL, BRAKE ROTOR/CALIPER, ETC.)**

**WARNING! CHECK FOR CLEARANCE WITH THE SUSPENSION IN BOTH THE COMPRESSED AND UNCOMPRESSED POSITIONS; ONCE CLEARANCE HAS BEEN ACHIEVED IN ALL POSITIONS, TIGHTEN THE CLAMPS SECURING THE HORNS.**

**STEP 7** Proceed to the wiring section of the instructions.

**PIC. 1**

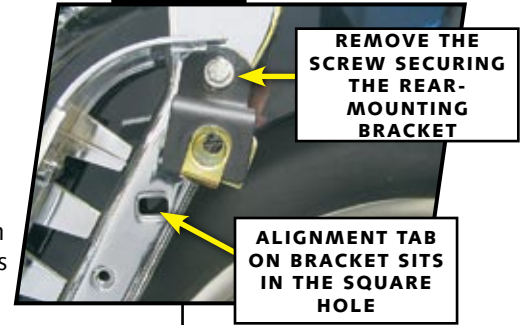

**PIC. 2**

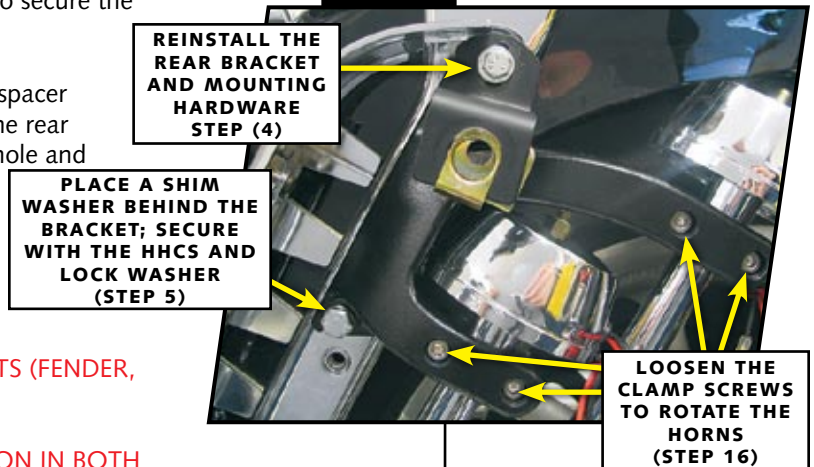

## MOUNTING PROCEDURE FOR FRONT AND REAR QUICK DETACHABLE DOCKING KITS OR FRONT ONLY QUICK DETACHABLE DOCKING KITS

**STEP 1** Read and understand all steps in the instructions before starting the installation. Park the motorcycle on a hard, level surface; turn off the ignition and allow the engine to cool.

**WARNING! YOU WILL BE WORKING AROUND THE ENGINE AND EXHAUST SYSTEM DURING INSTALLATION. ENSURE THAT THE ENGINE AND EXHAUST SYSTEM HAVE FULLY COOLED TO PREVENT INJURY.**

**STEP 2** Remove the right saddlebag from the motorcycle and set on a soft, clean and stable surface.

**STEP 3** Make note of the position of the rear bracket and remove the screw that secures the bracket as shown in PIC. 1; set the bracket and screw aside to reinstall, the spacer on the backside will not be used again.

**STEP 4** Remove the screw and nut that secure the support arm to the mounting bracket as shown in PIC. 1.

**PIC. 1**

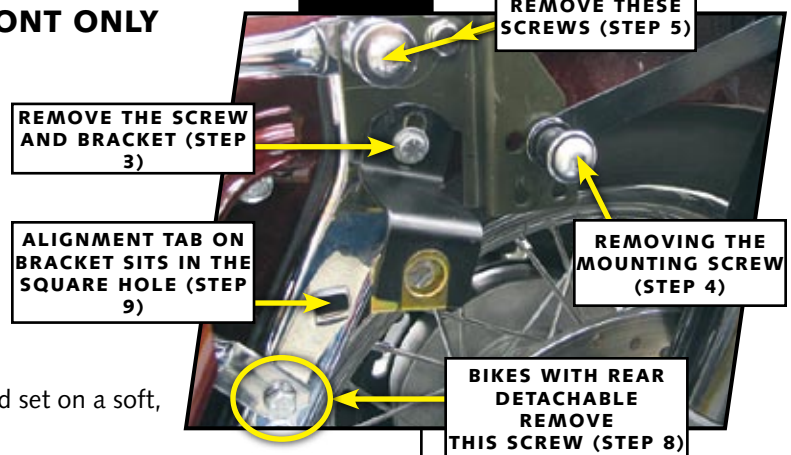

**NOTE** Some motorcycles may have one or two air fittings located on this bracket. Remove these fittings by removing the caps and the jam nuts securing the fittings.

**STEP 5** Remove the two screws that secure the mounting bracket as shown in [PIC. 1](#).

**STEP 6** Install the included air line relocation bracket, starting the two screws that were removed in STEP 5.

**NOTE** Bikes that do not have the rear detachable hardware will need to reuse the spacers that were behind the mounting bracket.

**STEP 7** Reinstall the screw and arm (removed in STEP 4), securing to the new airline relocation bracket.

**NOTE** For motorcycles with air line fittings on the right side, reinstall one fitting, jam nut in the air line relocation bracket as shown in [PIC. 2](#). Motorcycles with two fittings will need to relocate one of the fittings to the left side bracket. We have included a longer piece of air line hose to relocate the fitting to the left side. The red connections on the shocks and fittings are quick-disconnect by pressing on the red tab. ([PIC. 4](#)) You will need to refill the air suspension after replacing the airline.

**STEP 8** Remove the screw that secures the lower portion of rear docking kit as shown in [PIC. 1](#).

**NOTE** Bikes without rear detachable hardware will not need to perform STEP 8.

**STEP 9** Install the horn bracket assembly so that the top mounting hole is behind the air line bracket as shown in [PIC. 2](#) and the alignment tab on the backside of the bracket sits in the square hole shown in [PIC. 1](#).

**STEP 10** Secure the top of the horn bracket with rear bracket and screw that were removed in STEP 3. (See [PIC. 3](#))

**STEP 11** Insert the 5/16-18 x 1" HHCS screw and 5/16" lock washer to secure the lower portion of the horn bracket as shown in [PIC. 3](#); tighten the screw.

**NOTE** Bikes without rear detachable hardware will need to place a shim washer from the hardware kit behind the lower mounting hole in the horn bracket.

**STEP 12** Tighten the screws securing the airline relocation bracket installed in STEP 7.

**STEP 13** Loosen the screws that secure the clamps around the horns ([PIC.3](#));

**WARNING!** ROTATE THE HORNS TO ACHIEVE CLEARANCE WITH ALL MOVING AND NON-MOVING PARTS (FENDER, SHOCK, WHEEL, BRAKE ROTOR/CALIPER, ETC.)

**WARNING!** CHECK FOR CLEARANCE WITH THE SUSPENSION IN BOTH THE COMPRESSED AND UNCOMPRESSED POSITIONS; ONCE CLEARANCE HAS BEEN ACHIEVED IN ALL POSITIONS, TIGHTEN THE CLAMPS SECURING THE HORNS.

**STEP 14** Proceed to the wiring section of the instructions.

**Kuryakyn**

**PIC. 2**

HORN MOUNTING BRACKET BEHIND THE AIR LINE RELOCATION BRACKET

**PIC. 3**

REINSTALL THE REAR BRACKET AND SCREW (STEP 10)

SECURE WITH 5/16" HHCS AND 5/16" LOCK WASHER

LOOSEN THE CLAMP SCREWS TO ROTATE THE HORNS (STEP 11)

**PIC. 4**

OPTIONAL STEP TO RELOCATE AIR LINE FITTINGS

PRESS ON THE TAB TO RELEASE THE AIRLINE

PAGE

**3**

-cont.-



## WIRING PROCEDURE

**ATTENTION!** When routing the wiring harness, be sure to keep the wiring away from any moving parts, pinch points or extreme heat. Kuryakyn **WILL NOT** warranty any electrical component that fails due to pinched, crimped, broken, abraded, melted or frayed wires.

**STEP 1** Remove the seat from the motorcycle.

**STEP 2** Route the long red and black leads from the wiring harness behind the strut. Connect the two red leads from the Hidden Horns to the two red leads from the wiring harness. See [PIC. 1](#).

**ATTENTION!** Kuryakyn recommends the use of dielectric grease on electrical connections.

**STEP 3** Connect the two black leads from the Hidden Horns to the two black leads from the wiring harness. See [PIC. 1](#).

**NOTE** You may choose to route the wiring through the included sheathing to help protect the wires.

**STEP 3** Route the wiring harness along the frame tubes toward the battery. See [PIC. 2](#).

**STEP 4** Pass the black sheathed lead through a hole in the frame or other location free of pinch points, moving parts or extreme heat. See [PIC. 3](#).

**STEP 5** Connect the black, sheathed lead to the female terminal of the "Y" connector. See [PIC. 4](#).

**STEP 6** Connect the male terminal from the "Y" connector to the power lead from the stock horn. See [PIC. 4](#).

**STEP 7** Connect the other female terminal of the "Y" connector to the male terminal of the stock horn. See [PIC. 4](#).

**STEP 8** Reconnect the battery; connect the red lead with a fork connector from the Hidden Horns harness to the positive terminal of the battery, the black lead with a fork connector to the negative terminal.

**STEP 9** Turn on ignition and test for proper operation.

**STEP 10** Secure the remaining length of the wiring harness in the frame recess forward of the battery box. See [PIC. 5](#).

**STEP 11** Secure wiring up and out of the way of pinch points, moving parts and extreme heat using the included cable ties.

**STEP 12** Reinstall the seat and saddlebag and ensure that all fasteners have been

**NOTE** If the saddlebag does not align very well, you can remove the front mounting the included shim washer behind it and secure with the 5/16" HHCS and 5/16" lo

**ATTENTION!** It is the installer's responsibility to ensure that all of the fasteners (including pre-assembled) are tightened before operation of the motorcycle. Kuryakyn warranty components lost due to improper installation. Periodic maintenance may be required.

## OPTIONAL INSTALLATION

You can bypass your stock horn by removing the included "Y" connector from the installation. Disconnect the power lead from the stock horn; connect the black, sheathed lead to the power lead from the stock horn. See [PIC. 6](#). This allows for removal of the stock horn.

# Kuryakyn®

PIC. 1

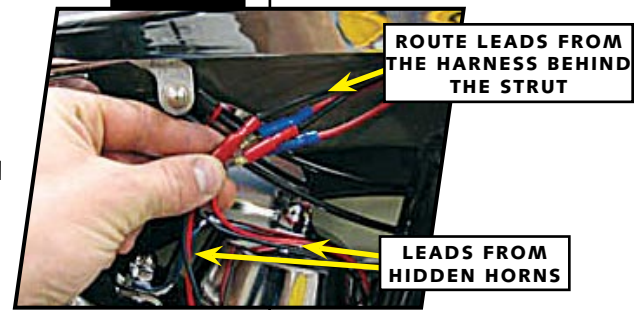

PIC. 2



PIC. 3



PIC. 4

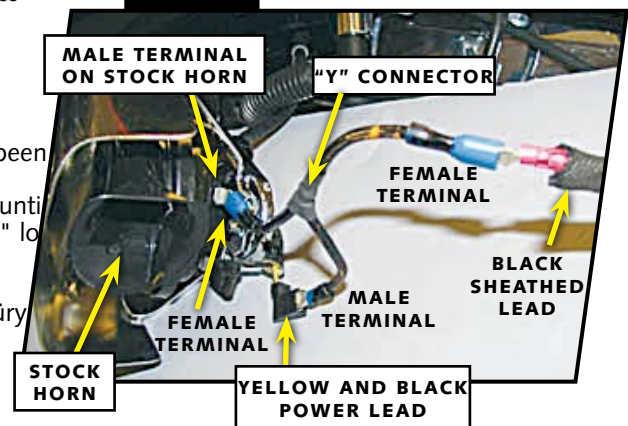

PAGE

4

PIC. 5



PIC. 6

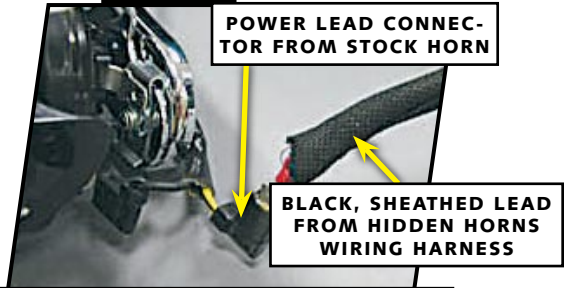

POWER LEAD CONN-  
ECTOR FROM STOCK HORN

BLACK, SHEATHED LEAD  
FROM HIDDEN HORNS  
WIRING HARNESS

THE STOCK HORN SHOWN HAS BEEN  
REMOVED FROM THE BIKE FOR CLARITY