



# INSTALLATION

## ZOMBIE LEVERS

## 7413

### PARTS INCLUDED

- 1 Clutch Lever
- 1 Brake Lever
- 2 Zombie Emblems
- 2 Grooved Emblems
- 1 Alcohol Pad
- 1 Installation Instructions

Please read and understand entire instructions before starting installation.

### THANK YOU FOR CHOOSING KÜRYAKYN!

**IN ORDER TO PROTECT YOU AND OTHERS FROM POSSIBLE INJURY AND/OR PROPERTY DAMAGE OR LOSS, PLEASE PAY CLOSE ATTENTION TO ALL INSTRUCTIONS, WARNINGS, CAUTIONS AND ATTENTION NOTES REGARDING THE USE AND CARE OF THIS PRODUCT.**

**WARNING!** THIS INDICATION ALERTS YOU TO THE FACT THAT IGNORING THE CONTENTS DESCRIBED HEREIN CAN RESULT IN POTENTIAL DEATH OR SERIOUS INJURY.

**ATTENTION!** This indication alerts you to the fact that ignoring the contents described herein may negatively affect product performance and functionality.

**CAUTION!** This indication alerts you to the fact that ignoring the contents described herein can result in potential injury or material damage.

### TOOLS SUGGESTED

Flat Blade Screwdriver, Set of Metric Combination Wrenches

**STRICTLY OBSERVE THE FOLLOWING GUIDELINES IN ORDER TO USE THE PRODUCT PROPERLY AND AVOID POTENTIALLY DANGEROUS ACCIDENTS.**

**STEP 1** Read and understand all steps in the instructions before starting the installation. Park the motorcycle on a hard, level surface and turn off the ignition.

**ATTENTION!** A factory service manual may be helpful in performing this installation. Do not attempt to perform this installation if you are not confident in your ability to complete all of the steps in the procedure; consult a trained technician.

### Clutch Side

**STEP 2** Remove the lock nut from the bottom of the pivot screw. Holding the retaining plate, remove the pivot screw from the clutch housing. Remove the lever from the housing, be sure to keep the brass barrel plunger insert, screw, lock nut and retaining plate for the new Zombie Lever. PIC 1

-cont.-

7413-21MC-1211



### CUSTOMER SERVICE

877.370.3604 (toll free)

### INSTALLATION QUESTIONS

techsupport@kuryakyn.com  
or call 715.247.2983

### LIMITED WARRANTY

Kuryakyn warrants that any Kuryakyn products sold hereunder, shall be free of defects in materials and workmanship for a period of one (1) year from the date of purchase by the consumer excepting the following provisions:

- Kuryakyn shall have no obligation in the event the customer is unable to provide a receipt showing the date the customer purchased the product(s).
  - The product must be properly installed, maintained and operated under normal conditions.
  - Kuryakyn makes no warranty, expressed or implied, with respect to any gold plated products.
  - Kuryakyn shall not be liable for any consequential and incidental damages, including labor and paint, resulting from failure of a Kuryakyn product, failure to deliver, delay in delivery, delivery in nonconforming condition, or for any breach of contract or duty between Kuryakyn and a customer.
- Kuryakyn products are often intended for use in specific applications. Kuryakyn makes no warranty if a Kuryakyn product is used in applications other than intended.
- Kuryakyn electrical products are warranted for one (1) year from the date of purchase by the consumer. L.E.D.'S contained in components of Kuryakyn products will be warranted for defects in materials and workmanship for 3 years from the date of purchase where as all other components shall be warranted for one(1) year. This includes, but is not limited to; control modules, wiring, chrome & other components.
- Kuryakyn makes no warranty of any kind in regard to other manufacturer's products distributed by Kuryakyn. Kuryakyn will pass on all warranties made by the manufacturer and where possible, will expedite the claim on behalf of the customer, but ultimately, responsibility for disposition of the warranty claim lies with the manufacturer.

### ABOUT OUR CATALOG

For purchasing Kuryakyn® products, you can receive a complete catalog free of charge. Send the Proof-of-Purchase below with your address to: Kuryakyn, P.O. Box 339, Somerset, WI 54025. Please indicate either Accessories Catalog for Harley-Davidson® or GL & Metric Cruisers.

Be sure to ask your local dealer about other Kuryakyn® products, the motorcycle parts and accessories designed for riders by riders.

©2005 Kuryakyn USA® All Rights reserved.

kuryakyn.com



**STEP 3** Install the new Zombie clutch lever with the brass barrel and plunger insert, (PIC 2 and PIC 3), and secure it with the stock bolt and retaining plate removed in Step 2. Pay close attention to the pin on the clutch safety switch (PIC 4) so that it is placed behind the tab on the lever for proper operation. If this pin is not depressed slightly when the lever is installed, you may break it off and cause the switch not to work.

**Brake Side**

**STEP 4** Remove the lock nut from the bottom of the pivot screw. Holding the retaining plate, remove the pivot screw from the brake housing. Set these aside, they will be reused. Remove the stock brake lever from the master cylinder assembly.

**STEP 5** Place a small amount of grease on the pivot screw. Check to be sure the brass bushing is in place in the new lever and place the new lever into the master cylinder — **DO NOT FORCE IT!** If it does not go in with ease, make sure the cup on the brake lever is positioned at the end of the master cylinder plunger. When the pivot pin can be inserted easily through the master cylinder housing and the lever, it is positioned correctly. Gently squeeze the brake control a few times to ensure proper operation. Reinstall the retaining plate and lock nut. Tighten securely.

**CAUTION!** As a safety precaution, we recommend testing to be certain the front brake is not dragging. To do this you may need the help of a friend. With a small jack or lift, elevate the front wheel off the ground. Spin the front wheel; it should spin freely for a couple of revolutions. If it moves with noticeable resistance or seems to stick or bind, the brakes are dragging and one should go back and review the installation to determine the cause of this brake drag before the motorcycle is operated.

**WARNING!** ENSURE PROPER BRAKE LIGHT OPERATION BEFORE RIDING THE MOTORCYCLE. VISIBILITY IS A MAJOR CONCERN FOR MOTORCYCLISTS. BRAKE LIGHT MALFUNCTION COULD RESULT IN DEATH OR SERIOUS INJURY.

**STEP 8** Clean the flat spot on the levers as circled in PIC 6 with the included alcohol cleaning pad & allow the area to dry.

**ATTENTION!** Ensure the area of installation is free of grease, oil, dirt or other debris to ensure proper adhesion. Küryakyn WILL NOT warranty any parts lost due to improper installation.

**ATTENTION!** The adhesive will not bond correctly if applied at temperatures less than 50° F. Do not attempt this installation in temperatures less than 50° F.

**STEP 9** Choose which emblem you wish to install (Zombie or Grooved); using the back of your fingernail, rub the backing of the adhesive pad to activate the catalyst.

**STEP 10** Remove the adhesive backing and install the emblem, ensuring that the aligning pins will be placed so that the emblem is in the correct orientation; press and hold in place for one minute, full bonding strength will occur in 24 hours.

**ATTENTION!** It is the installer's responsibility to ensure that all of the fasteners (including pre-assembled) are tightened before operation of the motorcycle. Küryakyn will not issue a warranty on components lost due to improper installation. Periodic maintenance may be required.

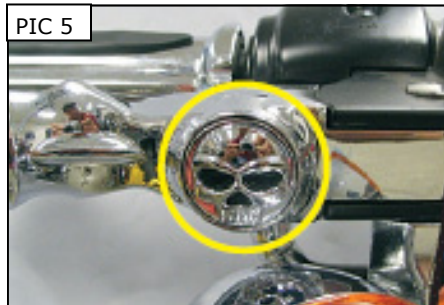
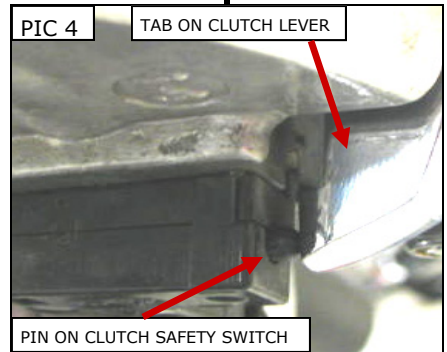
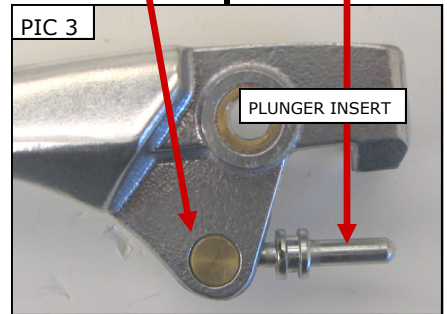
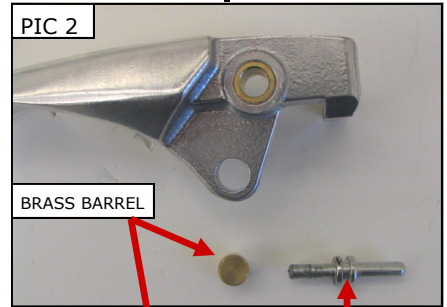
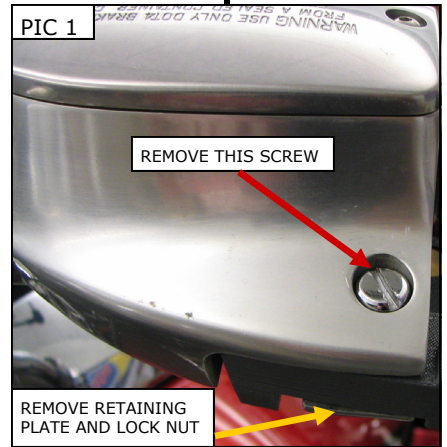

*Ride On!*