



INSTALLATION

SKINNI MINI STRIP LIGHTS

5041

PARTS INCLUDED

- 2 Skinni Mini Lights
- 1 Hardware Kit Containing:
 - 4 Male Spade Connectors
 - 4 Female T-Tap Connectors
 - 1 Alcohol Pad
 - 1 Dielectric Grease Package
- 1 Installation Instructions

Please read and understand entire instructions before starting installation.

THANK YOU FOR CHOOSING KÜRYAKYN!

IN ORDER TO PROTECT YOU AND OTHERS FROM POSSIBLE INJURY AND/OR PROPERTY DAMAGE OR LOSS, PLEASE PAY CLOSE ATTENTION TO ALL INSTRUCTIONS, WARNINGS, CAUTIONS AND ATTENTION NOTES REGARDING THE USE AND CARE OF THIS PRODUCT.

WARNING! THIS INDICATION ALERTS YOU TO THE FACT THAT IGNORING THE CONTENTS DESCRIBED HEREIN CAN RESULT IN POTENTIAL DEATH OR SERIOUS INJURY

ATTENTION! This indication alerts you to the fact that ignoring the contents described herein may negatively affect product performance and functionality.

CAUTION! This indication alerts you to the fact that ignoring the contents described herein can result in potential injury or material damage.

TOOLS SUGGESTED

Set of Hex Wrenches, Combination Wrenches, Wire Stripper/Crimper, Ammonia Based Cleaner such as Window Cleaner, Scissors or Razor Knife, Silicone Sealer

STRICTLY OBSERVE THE FOLLOWING GUIDELINES IN ORDER TO USE THE PRODUCT PROPERLY AND AVOID POTENTIALLY DANGEROUS ACCIDENTS.

FOR INSTALLATION AROUND GL 1800 HEADLIGHTS

STEP 1 Read and understand all steps in the instructions before starting the installation. Park the motorcycle on a hard, level surface and turn off the ignition.

STEP 2 Pull the mirror boot away from the fairing to expose the mirror wiring and the bolts securing the outer fairing.

STEP 3 Unlock the windshield. As shown in PIC 1, remove the hardware securing the outer fairing in place. Keep this hardware, it will be re-used later.

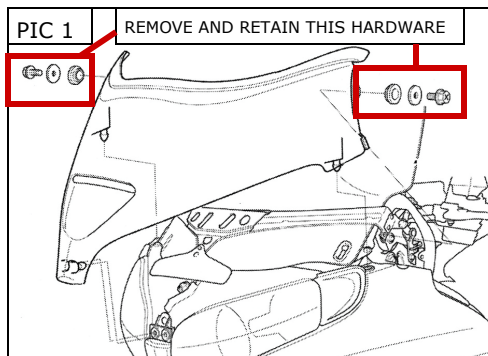

CUSTOMER SERVICE

877.370.3604 (toll free)

INSTALLATION QUESTIONS

techsupport@kuryakyn.com
or call 715.247.2983

LIMITED WARRANTY

Kuryakyn warrants that any Kuryakyn products sold hereunder, shall be free of defects in materials and workmanship for a period of one (1) year from the date of purchase by the consumer excepting the following provisions:

- Kuryakyn shall have no obligation in the event the customer is unable to provide a receipt showing the date the customer purchased the product(s).
 - The product must be properly installed, maintained and operated under normal conditions.
 - Kuryakyn makes no warranty, expressed or implied, with respect to any gold plated products.
 - Kuryakyn shall not be liable for any consequential and incidental damages, including labor and paint, resulting from failure of a Kuryakyn product, failure to deliver, delay in delivery, delivery in nonconforming condition, or for any breach of contract or duty between Kuryakyn and a customer.
- Kuryakyn products are often intended for use in specific applications. Kuryakyn makes no warranty if a Kuryakyn product is used in applications other than intended.
- Kuryakyn electrical products are warranted for one (1) year from the date of purchase by the consumer. L.E.D.'S contained in components of Kuryakyn products will be warranted for defects in materials and workmanship for 3 years from the date of purchase where as all other components shall be warranted for one(1) year. This includes, but is not limited to; control modules, wiring, chrome & other components.
- Kuryakyn makes no warranty of any kind in regard to other manufacturer's products distributed by Kuryakyn. Kuryakyn will pass on all warranties made by the manufacturer and where possible, will expedite the claim on behalf of the customer, but ultimately, responsibility for disposition of the warranty claim lies with the manufacturer.

ABOUT OUR CATALOG

For purchasing Kuryakyn® products, you can receive a complete catalog free of charge. Send the Proof-of-Purchase below with your address to: Kuryakyn, P.O. Box 339, Somerset, WI 54025. Please indicate either Accessories Catalog for Harley-Davidson® or GL & Metric Cruisers.

Be sure to ask your local dealer about other Kuryakyn® products, the motorcycle parts and accessories designed for riders by riders.

©2005 Kuryakyn USA® All Rights reserved.



STEP 4 Examine the lights carefully. As shown in PIC 2, notice the markings on the light specifying the direction the light is emitted. Keep this in mind before installing the lights. The light is emitted from the positive side. This is marked with a + sign.

NOTE: This is important when deciding the left and right side.

ATTENTION! Ensure the area of installation is free of grease, oil, dirt or other debris including wax/polish products and bugs to ensure proper adhesion. Küryakyn WILL NOT issue a warranty on any parts lost due to improper installation.

ATTENTION! The adhesive will not bond correctly if applied at temperatures less than 50°F. Do not attempt this installation in temperatures less than 50°F.

STEP 5 Clean the edge of the light with the included alcohol pad. Starting on the right side, as shown in PIC 3, remove the adhesive backing and start the Skinni mini light at the bottom corner of the headlamp with the LED pointed forward.

STEP 6 As shown in PIC 4, wrap the Skinni mini light around the edge of the headlamp with the wire leads ending toward the mirrors.

STEP 7 With the Skinni Mini lights stuck in place, strip the end of the wires back far enough so you may double the exposed wire and insert each into a male spade and crimp. PIC 5

NOTE: Solid Black Wire = Ground
Black Wire with White Stripe = Power

CAUTION! Avoid potential electrical shock! Disconnect the battery before starting this procedure.

STEP 8 Behind the mirror boot, as shown in PIC 6, locate the stock turn signal wiring. Starting on the right side, locate the green wire and the blue wire with a white stripe.

NOTE: Green Wire = Ground
Blue Wire with White Stripe = Power

STEP 9 Clamp one female t-tap connector over each wire. Make sure the clamps are locked completely around the wires. PIC 7

STEP 10 Connect the male spade on the power wire to the female T-Tap on the blue wire with white stripe. Connect the male spade on the negative wire to the female T-tap on the green wire.

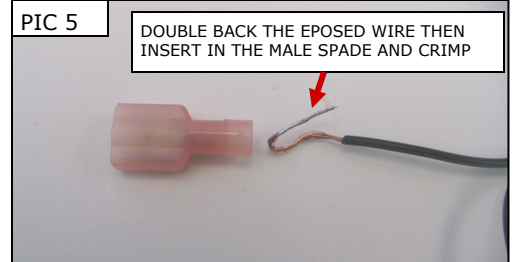
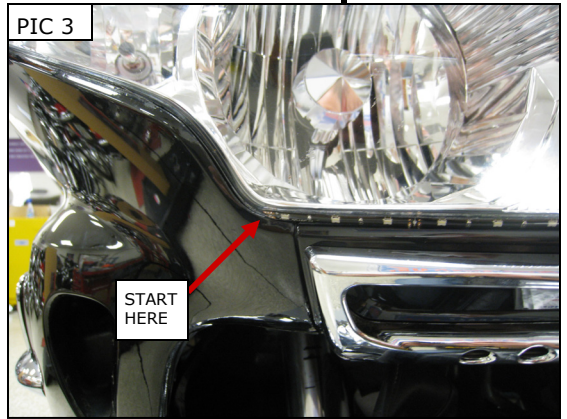
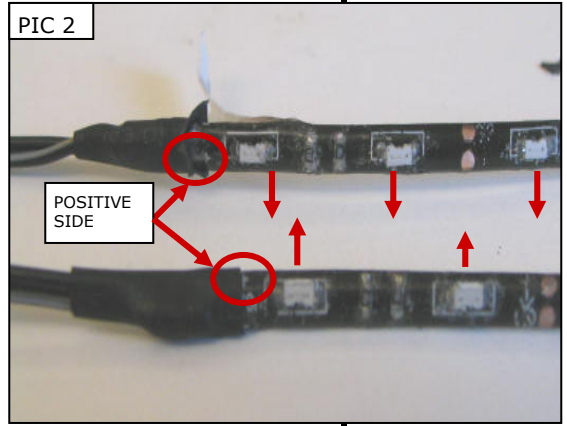

LEFT SIDE Installation

STEP 11 Follow Steps 4-7 for the left side.

STEP 12 Behind the mirror boot, as shown in PIC 8, locate the stock turn signal wiring. On the left side, locate the green wire and the orange wire with a white stripe.

NOTE: Green Wire = Ground
Orange Wire with White Stripe = Power

ATTENTION! Küryakyn recommends the use of dielectric grease on electrical connections.

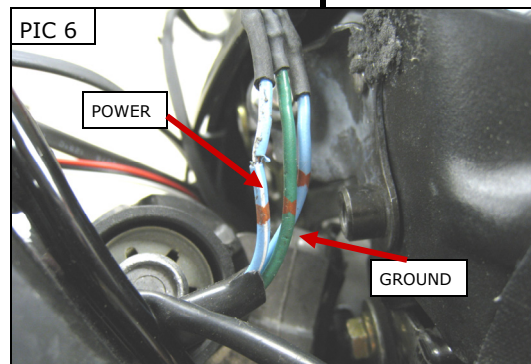

STEP 13 Clamp one female t-tap connector over each wire. Make sure the clamps are locked completely around the wires. PIC 7

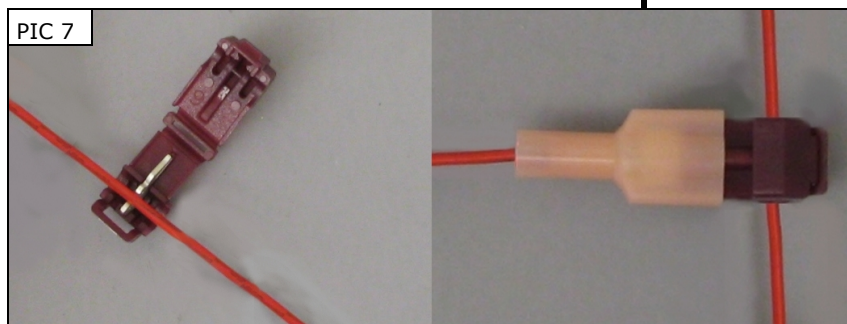

STEP 14 Connect the male spade on the power wire to the female T-Tap on the orange wire with white stripe. Connect the male spade on the negative wire to the female T-tap on the green wire. Reconnect the battery and check that the lights illuminate correctly.

WARNING! ENSURE PROPER LIGHT OPERATION BEFORE RIDING THE MOTORCYCLE. VISIBILITY IS A MAJOR CONCERN FOR MOTORCYCLISTS. A LIGHT MALFUNCTION COULD RESULT IN DEATH OR SERIOUS INJURY.

STEP 15 Tuck all wiring away and replace the outer fairing. Secure using the hardware removed in Step 3. Make sure the windshield is locked in place before operating motorcycle.

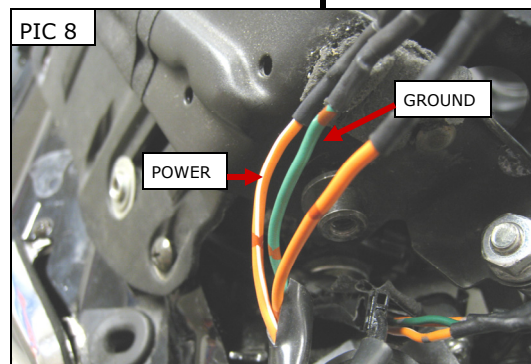

ATTENTION! Secure all wiring away from any moving parts, pinch points or extreme heat. Küryakyn WILL NOT issue a warranty on any electrical component that fails due to pinched, crimped, broken, abraded, melted or frayed wires

ATTENTION! It is the installer's responsibility to ensure that all of the fasteners (including pre-assembled) are tightened before operation of the motorcycle. Küryakyn will not issue a warranty on components lost due to improper installation. Periodic maintenance may be required.

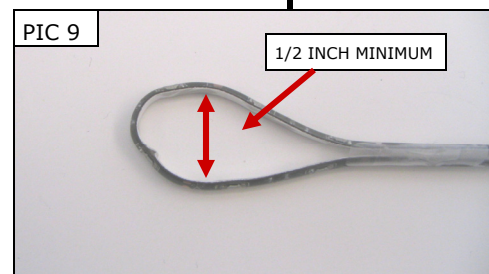

Universal Installation

STEP 1 Test fit the Skinni mini light to the desired mounting area. Lights are single circuit.

NOTE: The strip lights are side emitting and side specific. See PIC 2.

-cont.-

STEP 2 If necessary, the lights may be trimmed to custom lengths (every 2 lights). Always cut the LED lights from the end opposite the wire leads. Küryakyn recommends using silicone to seal the cut end to prevent corrosion.

STEP 3 Clean the mounting area with an ammonia based surface cleaner. Dry the area completely. Wipe the area with the included alcohol pad to remove any residue and dry completely.

ATTENTION! Ensure the area of installation is free of grease, oil, dirt or other debris including wax/polish products and bugs to ensure proper adhesion. Küryakyn WILL NOT issue a warranty on any parts lost due to improper installation.

ATTENTION! The adhesive will not bond correctly if applied at temperatures less than 50°F. Do not attempt this installation in temperatures less than 50°F.

Skinni Mini Wire Function

NOTE: Solid Black Wire = Ground
Black Wire with White Stripe = Power

STEP 4 Test fit the Skinni Mini lights in the desired location.

NOTE: The Skinni Mini lights are will not make a 90 degree bend. This will break the circuit board. The smallest bend they will form is 1/2". PIC 9 on Page 3

STEP 5 Apply the lights to the clean mounting area. Run the power wire to the desired power source and the ground to a good ground source.

STEP 6 With the Skinni Mini lights stuck in place, strip the end of the wires back far enough so you may double the exposed wire and insert each into a male spade and crimp. PIC 5 on Page 2

STEP 7 Find a keyed power wire and a ground wire for the lights.

CAUTION! Avoid potential electrical shock! Disconnect the battery before starting this procedure.

ATTENTION! Küryakyn recommends the use of dielectric grease on electrical connections.

STEP 8 Clamp one female T-Tap over each. PIC 7 on Page 3

STEP 9 Connect the male spade on the power wire to the female T-Tap on the power wire. Connect the male spade on the negative wire to the female T-tap on the ground wire. Reconnect the battery and check that the lights illuminate correctly.

WARNING! ENSURE PROPER LIGHT OPERATION BEFORE RIDING THE MOTORCYCLE. VISIBILITY IS A MAJOR CONCERN FOR MOTORCYCLISTS. A LIGHT MALFUNCTION COULD RESULT IN DEATH OR SERIOUS INJURY.

ATTENTION! Secure all wiring away from any moving parts, pinch points or extreme heat. Küryakyn WILL NOT issue a warranty on any electrical component that fails due to pinched, crimped, broken, abraded, melted or frayed wires.

Ride On!