



INSTALLATION

BULLET LIGHT FRONT TURN SIGNAL CONVERSION 5011

FITS: '94-UP FLHT, FLHTC, FLHTCU, FLHR, FLHRC & '96-UP FLSTC

PARTS INCLUDED

- 1 Mount Kit
 - 1 Right Mount
 - 1 Left Mount
 - 2 Large Pivot Dome
 - 2 Small Pivot Dome
 - 2 1.275 (OD) / .621 (ID) Washer
- 1 Hardware Kit
 - 2 5/16-24 x 5/8" Socket Head Cap Screw (SHCS)
 - 2 5/16" Hot Spots
 - 1 1/4" Short Hex Wrench
 - 2 5/16-18 x 1" BSCS
 - 2 5/16-18 Hex Nut
 - 2 5/16 Tooth Washer
- 1 Wiring Kit
 - 2 36" Power Wires
 - 2 4-Pin AMP Connector
 - 1 6-Pin AMP Connector
 - 2 Spade Receptacle
 - 8 Butt Connectors
 - 6 4" Cable Ties
 - 1 Dielectric Grease Pack
- 2 Amber Bullet Lights w/Smoke Lens
- 1 Installation Instructions

Please read and understand entire instructions before starting installation.

THANK YOU FOR CHOOSING KÜRYAKYN!

IN ORDER TO PROTECT YOU AND OTHERS FROM POSSIBLE INJURY AND/OR PROPERTY DAMAGE OR LOSS, PLEASE PAY CLOSE ATTENTION TO ALL INSTRUCTIONS, WARNINGS, CAUTIONS AND ATTENTION NOTES REGARDING THE USE AND CARE OF THIS PRODUCT.

WARNING! THIS INDICATION ALERTS YOU TO THE FACT THAT IGNORING THE CONTENTS DESCRIBED HEREIN CAN RESULT IN POTENTIAL DEATH OR SERIOUS INJURY.

CAUTION! This indication alerts you to the fact that ignoring the contents described herein can result in potential injury or material damage.

ATTENTION! This indication alerts you to the fact that ignoring the contents described herein may negatively affect product performance and functionality.

TOOLS SUGGESTED

Set of Hex Wrenches, Test Light, Wire Cutter, Wire Stripper, Socket Set and Ratchet

STRICTLY OBSERVE THE FOLLOWING GUIDELINES IN ORDER TO USE THE PRODUCT PROPERLY AND AVOID POTENTIALLY DANGEROUS ACCIDENTS.

CUSTOMER SERVICE
877.370.3604 (toll free)

INSTALLATION QUESTIONS
techsupport@kuryakyn.com
or call 715.247.2983

LIMITED WARRANTY

Küryakyn warrants that any Küryakyn products sold hereunder, shall be free of defects in materials and workmanship for a period of one (1) year from the date of purchase by the consumer excepting the following provisions:

- Küryakyn shall have no obligation in the event the customer is unable to provide a receipt showing the date the customer purchased the product(s).
- The product must be properly installed, maintained and operated under normal conditions.
- Küryakyn makes no warranty, expressed or implied, with respect to any gold plated products.
- Küryakyn shall not be liable for any consequential and incidental damages, including labor and paint, resulting from failure of a Küryakyn product, failure to deliver, delay in delivery, delivery in nonconforming condition, or for any breach of contract or duty between Küryakyn and a customer.
- Küryakyn products are often intended for use in specific applications. Küryakyn makes no warranty if a Küryakyn product is used in applications other than intended.
- Küryakyn electrical products are warranted for one (1) year from the date of purchase by the consumer. Components of Küryakyn products containing L.E.D.s will be warranted for defects in materials and workmanship for 3 years from the date of purchase.
- Küryakyn makes no warranty of any kind in regard to other manufacturer's products distributed by Küryakyn. Küryakyn will pass on all warranties made by the manufacturer and where possible, will expedite the claim on behalf of the customer, but ultimately, responsibility for disposition of the warranty claim lies with the manufacturer.

ABOUT OUR CATALOG

You'll find all our innovations for H-D, GL and Metric Cruisers in our annual catalogs. Order online today—select the "CATALOGS" icon. Each Küryakyn® product comes with a Proof-of-Purchase good for a complimentary catalog. Details in packaging.

Be sure to ask your local dealer about other Küryakyn® products, the motorcycle parts and accessories designed for riders by riders.

©2005 Küryakyn USA® All Rights reserved.



kuryakyn.com

PROCEDURE

FOR FLH MODELS

STEP 1 Read and understand all steps in the instructions before starting the installation. Park the motorcycle on a hard, level surface; turn off the ignition and allow the engine to cool.

ATTENTION! A factory service manual may be helpful in performing this installation. Do not attempt to perform this installation if you are not confident in your ability to complete all of the steps in the procedure; consult a trained technician.

STEP 2 Remove the three Torx screws securing the windscreen to the fairing; set them aside. (FIG. 1)

STEP 3 Remove the four Torx screws securing the outer fairing to the inner fairing. (FIG.1)

CAUTION! Avoid damage to the motorcycle. Protect painted surfaces with a soft cloth or blanket.

ATTENTION! Assistance is recommended to hold and support the outer fairing after all of the Torx screws have been removed to prevent damage.

STEP 4 Unplug the headlight connector and gently set the outer fairing on a soft, sturdy surface.

STEP 5 Remove the passing lamp trim ring and glass, remove the light bulb. (PIC 1) Cut the grey wire 2" from the light bulb connector.

STEP 6 Remove the stock front turn signal lights and mounts. Pull the gray wire out from the bottom and remove the nut holding the passing lamp in place.

STEP 7 On the passing lamps, replace the stock pivot dome and washer with the chrome Large Pivot Domes and 1.275" OD washers provided in the kit.

STEP 8 Identify the left and right side Bullet Light Mounts. (PIC 2)

STEP 9 Place the small pivot dome on to the Bullet Light Mount and install the assembly on the stud coming down from the Passing Lamp. Using the stock nut removed in Step 6, align the passing lamp and Bullet Light Mount, and then tighten the assembly in place. (PIC 3)

STEP 10 Route the black 36" Power Wire up through the Bullet Light Mount and stud from the Passing Lamp. Using a butt connector, connect the black Power Wire with the grey wire (from step 5) coming from the passing lamp bulb.

STEP 11 Mount the Bullet Lights to the mount using the 5/16-24 x 5/8". Be sure that the Black Power Wire and Bullet Light Wiring is routed through the Bullet Light Mount and exits out the cut-away on the mount. (PIC 4 and 5)

STEP 12 With the new Bullet Light Wiring and Power Wire, follow the stock turn signal wiring up through the fairing. Locate and separate the stock turn signal connector. The connector is located on the inside of the inner fairing. There will be one purple wire, one blue wire and one black wire coming out of the connector. (PIC 6)

-cont.-

Kuryakyn®

FIG. 1

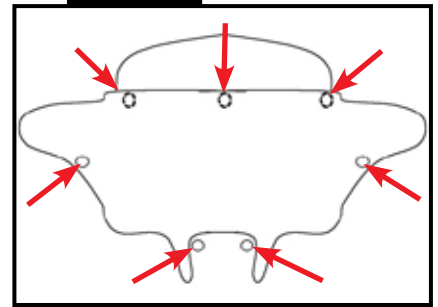

PIC. 1

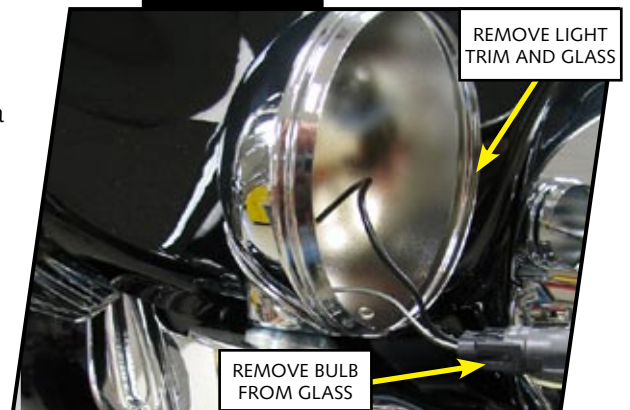

PIC. 2

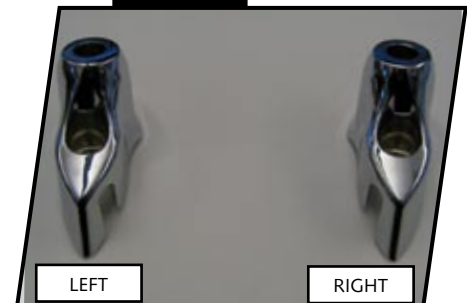

PIC. 3



PAGE
2

STEP 13 Using a 4-Pin or 6-Pin Amp Connector (depending on year), insert the 3 wires from the Bullet Light Wiring and the Power Wire. Be sure that the wires match up across the connectors. The black power wire will line up across from the grey wire. (PIC 7)

STEP 14 Plug the new (4 or 6 pin) Amp Connector in to the stock connector in the fairing.

STEP 15 Check all connections and test the turn signal and passing lamp function.

STEP 16 Tie any loose wires away from moving part or pinch points.

STEP 17 Reassemble the passing lamps and fairing in the reverse order in which they were disassembled.

ATTENTION! Kuryakyn recommends the use of dielectric grease on all electrical connections.

ATTENTION! It is the installer's responsibility to ensure that all of the fasteners (including pre-assembled) are tightened before operation of the motorcycle. Kuryakyn will not issue a warranty on components lost due to improper installation. Periodic maintenance may be required.

FOR FLSTC MODELS

ATTENTION! A factory service manual may be helpful in performing this installation. Do not attempt to perform this installation if you are not confident in your ability to complete all of the steps in the procedure; consult a trained technician.

STEP 1 Locate the 6-pin AMP connector that joins the stock front turn signals to the rest of the wiring harness. This is normally under the right side of the fuel tank toward the front (PIC 8). Unplug this connector.

STEP 2 Remove the 2 bolts on the left side that hold the handlebar triptree shrouding together. Locate the 2-pin connector (2 grey wires) that connect to the passing lamp switch. Disconnect the connector.

STEP 3 Remove the passing lamp trim ring and glass, remove the light bulb. (PIC 1) Cut the grey wire 2" from the light bulb connector.

STEP 4 Remove the stock front turn signal lights and mounts. Pull the gray wire out from the bottom and remove the nut holding the passing lamp in place.

STEP 5 On the passing lamps, replace the stock pivot dome and washer with the chrome Large Pivot Domes and 1.275" OD washers provided in the kit.

STEP 6 Identify the left and right side Bullet Light Mounts. (PIC 2)

STEP 7 Place the small pivot dome on to the Bullet Light Mount and install the assembly on the stud coming down from the Passing Lamp. Using the stock nut removed in Step 3, align the passing lamp and Bullet Light Mount, and then tighten the assembly in place. (PIC 3)

STEP 8 Route the black 36" Power Wire up through the Bullet Light Mount and stud from the Passing Lamp. Using a butt connector, connect the black Power Wire with the grey wire (from step 3) coming from the passing lamp bulb.

STEP 9 Mount the Bullet Lights to the mount using the 5/16-24 x 5/8". Be sure that the Black Power Wire and Bullet Light Wiring is routed through the Bullet Light Mount and exits out the cut-away on the mount (PIC 4 and 5). Make sure wires are not pinched and move freely.

ATTENTION! Secure all wiring away from any moving parts, pinch points or extreme heat. Kuryakyn WILL NOT issue a warranty on any electrical component that fails due to pinched, crimped, broken, abraded, melted or frayed wires.

Kuryakyn®

PIC. 4

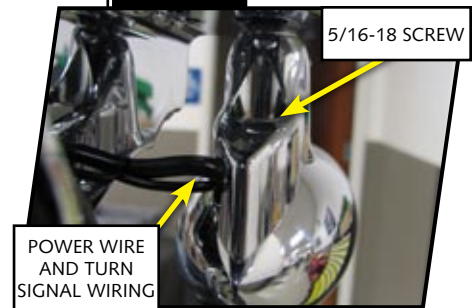

PIC. 5



PIC. 6

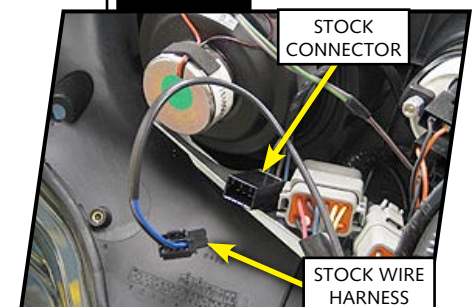

PIC. 7

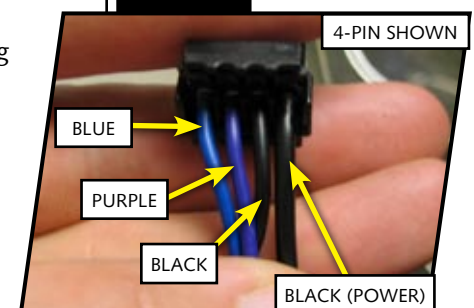

STEP 10 Cut the non-switch side of the 2-pin connector (Step 2) (PIC 9) about 2 inches from the connector. Using a butt connector, connect one of the black power wires to each of the grey wires from the 2-pin connector.

STEP 11 With the new Bullet Light Wiring, follow the stock turn signal wiring to the 6-pin AMP connector from Step 1 (FLSTC procedure).

STEP 12 Using the supplied 6-Pin Amp Connector, insert the wires from the Bullet Light Wiring. Be sure that the wire colors match up across the connector. (PIC 10)

NOTE *The right side turn signal violet wire should line up across from the brown wire on the stock connector.*

STEP 13 Check all connections and test the turn signal and passing lamp function.

STEP 14 Tie any loose wires away from moving part or pinch points.

STEP 15 Reassemble the passing lamps and reinstall the fuel tank in the reverse order in which they were disassembled.

ATTENTION! Küryakyn recommends the use of dielectric grease on all electrical connections.

ATTENTION! It is the installer's responsibility to ensure that all of the fasteners (including pre-assembled) are tightened before operation of the motorcycle. Küryakyn will not issue a warranty on components lost due to improper installation. Periodic maintenance may be required.

UNIVERSAL MOUNTING WITH P-CLAMPS

The 5/16-18 x 1-1/4" BSCS, 5/16 Tooth Washer and 5/16-18 Hex Nut are included in the hardware kit for mounting to P-Clamps or similar clamping devices.

Insert the 5/16 BSCS through the light mount from the inside.

Slide the 5/16 BSCS with light mount through the mounting hole in the universal clamp being used.

Adjust the light mount to desired orientation and secure with the 5/16 Tooth Washer and 5/16 Hex Nut included in the hardware kit.

ATTENTION! It is the installer's responsibility to ensure that all of the fasteners (including pre-assembled) are tightened before operation of the motorcycle. Küryakyn will not issue a warranty on components lost due to improper installation. Periodic maintenance may be required.

Ride On!

PIC. 8



PIC. 9



PIC. 10

