



INSTALLATION

FORK MOUNTED DRIVING LIGHTS

5008

PARTS INCLUDED

- 1 Right Fork Mount Assembly
- 1 Left Fork Mount Assembly
- 2 H3 Driving Light Assemblies
- 1 12-Pin Wiring Adapter
- 1 Hardware Kit for Fork Mount Driving Lights, Including:
 - 6 5/16"-18 Nylock Nuts
 - 2 5/16"-18 x 7/8 Socket Head Cap Screws
 - 4 5/16"-18 x 1-3/4" Hex Head Cap Screws
 - 4 5/16"-18 X 2-3/4" Hex Head Cap Screws
 - 2 #10-24 X 1/4" Button Head Cap Screws
 - 2 5/16" Internal Tooth Lock Washers
 - 4 5/16" Flat Washers
 - 2 Loop Strap: Nylon-Black
 - 2 Anti-Seize packets
- 1 Wiring Components, Including:
 - 1 60" Main Power Wire Assembly
 - 1 48" Power Wire Assembly
 - 2 2" Ground Wire Assemblies
- 1 All-Purpose Lighting Installation Kit Including:
 - 1 Dielectric Grease Pack
 - 6 Female T-Taps
 - 6 Insulated Male Spade Connectors
 - 2 3-Terminal AMP Connectors—White
 - 2 Large 4-Pin AMP Connector Housings
 - 2 AMP 6-Circuit Plugs
 - 1 24" "Y" Wire Assembly—White
 - 12 6" Cable Ties
- 1 Installation Instructions

Please read and understand entire instructions before starting installation.

THANK YOU FOR CHOOSING KÜRYAKYN!

IN ORDER TO PROTECT YOU AND OTHERS FROM POSSIBLE INJURY AND/OR PROPERTY DAMAGE OR LOSS, PLEASE PAY CLOSE ATTENTION TO ALL INSTRUCTIONS, WARNINGS, CAUTIONS AND NOTICES REGARDING THE USE AND CARE OF THIS PRODUCT.

WARNING

THIS INDICATION ALERTS YOU TO THE FACT THAT IGNORING THE CONTENTS DESCRIBED HEREIN CAN RESULT IN POTENTIAL DEATH OR SERIOUS INJURY.

NOTICE

This indication alerts you to the fact that ignoring the contents described herein may negatively affect product performance and functionality.

CAUTION

This indication alerts you to the fact that ignoring the contents described herein can result in potential injury.

NOTICE

IF INSTALLING THIS PRODUCT FOR ANOTHER PARTY, PLEASE MAKE SURE THEY RECEIVE THIS COPY OF THE INSTALLATION INSTRUCTIONS SO THEY ARE AWARE OF THE IMPORTANT INFORMATION CONTAINED IN THEM.

CUSTOMER SERVICE

877.370.3604 (toll free)

INSTALLATION QUESTIONS

techsupport@kuryakyn.com
or call 715.247.2983

LIMITED WARRANTY

Kuryakyn warrants that any Kuryakyn products sold hereunder, shall be free of defects in materials and workmanship for a period of one (1) year from the date of purchase by the consumer excepting the following provisions:

- Kuryakyn shall have no obligation in the event the customer is unable to provide a receipt showing the date the customer purchased the product(s).
- The product must be properly installed, maintained and operated under normal conditions.
- Kuryakyn makes no warranty, expressed or implied, with respect to any gold plated products.
- Kuryakyn shall not be liable for any consequential and incidental damages, including labor and paint, resulting from failure of a Kuryakyn product, failure to deliver, delay in delivery, delivery in nonconforming condition, or for any breach of contract or duty between Kuryakyn and a customer.
- Kuryakyn products are often intended for use in specific applications. Kuryakyn makes no warranty if a Kuryakyn product is used in applications other than intended.
- Kuryakyn electrical products are warranted for one (1) year from the date of purchase by the consumer. L.E.D.'S contained in components of Kuryakyn products will be warranted for defects in materials and workmanship for 3 years from the date of purchase where as all other components shall be warranted for one(1) year. This includes, but is not limited to; control modules, wiring, chrome & other components.

• Kuryakyn makes no warranty of any kind in regard to other manufacturer's products distributed by Kuryakyn. Kuryakyn will pass on all warranties made by the manufacturer and where possible, will expedite the claim on behalf of the customer, but ultimately, responsibility for disposition of the warranty claim lies with the manufacturer.

ABOUT OUR CATALOG

For purchasing Kuryakyn® products, you can receive a complete catalog free of charge. Send the Proof-of-Purchase below with your address to: Kuryakyn, P.O. Box 339, Somerset, WI 54025. Please indicate either Accessories Catalog for Harley-Davidson® or GL & Metric Cruisers.

Be sure to ask your local dealer about other Kuryakyn® products, the motorcycle parts and accessories designed for riders by riders.

©2005 Kuryakyn USA® All Rights reserved.



kuryakyn.com

TOOLS SUGGESTED

Set of Hex Wrenches, Combination Wrenches, Torx Wrenches, Long Screwdriver, Test Light, Wire Strippers/Crimpers

STRICTLY OBSERVE THE FOLLOWING GUIDELINES IN ORDER TO USE THE PRODUCT PROPERLY AND AVOID POTENTIALLY DANGEROUS ACCIDENTS.

STEP 1 Read and understand all steps in the instructions before starting the installation. Park the motorcycle on a hard, level surface and turn off the ignition. Let cool.

NOTE: This kit includes a 12-Pin Wiring Adapter that places control of the driving lights on the motorcycle's Accessory switch. If you already have accessories wired to this switch, you will have to choose an alternative wiring method (sold separately). Alternatives include replacing the stock Accessory switch with a Kuryakyn Double Rocker Switch, P/N 2201, or adding a Kuryakyn Universal Driving Light Wiring Relay Kit, P/N's 2202 or 2328. If you have an empty switch location on the dash, you could purchase an OEM switch from an authorized H-D dealership.

⚠ WARNING IT IS THE INSTALLERS RESPONSIBILITY TO ENSURE THAT THE INSTALLATION OF THIS ACCESSORY DOES NOT EXCEED THE MAXIMUM AMPERAGE OF THE CHOSEN CIRCUIT. EXCEEDING THE MAXIMUM ALLOWABLE AMPERAGE MAY LEAD TO CIRCUIT FAILURE WHICH COULD RESULT IN SERIOUS INJURY OR DEATH.

⚠ WARNING A FACTORY SERVICE MANUAL WILL BE HELPFUL IN PERFORMING THIS INSTALLATION. DO NOT ATTEMPT TO PERFORM THIS INSTALLATION IF YOU ARE NOT CONFIDENT IN YOUR ABILITY TO COMPLETE ALL OF THE STEPS IN THE PROCEDURE; CONSULT A TRAINED TECHNICIAN. IMPROPER INSTALLATION COULD RESULT IN SERIOUS INJURY OR DEATH.

STEP 2 Identify the right and left (sitting on the bike) mounting arms. PIC 1

STEP 3 Remove the Button Head Cap Screw located on the bottom of the light assembly. Slightly rotate the front light bezel clockwise and remove from the light housing. PIC 2 Remove the driving light from the housing and set aside. **Make note of the positioning of the rubber gasket and locating ring for reassembly.**

STEP 4 Take the black 48" power wire, (with a male and female bullet) and route it into the pivot arm from the bottom and into the small opening in the bottom of the light housing. Leave about three to four inches inside of the light housing. PIC 3

STEP 5 Take one of the 5/16"-18 x 7/8" Socket Head Cap Screws and route it through the bottom of the pivot arm and into the bottom of the light housing.

STEP 6 On the inside of the light housing, slide the 5/16" Internal Tooth Lock Washer over the cap screw. Then take the 2" Ground Cable and slide that over the cap screw. Secure it with the 5/16"-18 Nylock Nut making sure you have enough clearance with the power wire. PIC 4 Check to see if the power wire moves freely and is not affected with securing the light housing to the pivot arm.

STEP 7 Route the black power wire from the light housing under the pivot arm. Secure it to the bottom of the pivot arm with the black Loop Strap with the #10-24 X 1/4" Button Head Cap Screw. PIC 5

-cont.-

Kuryakyn

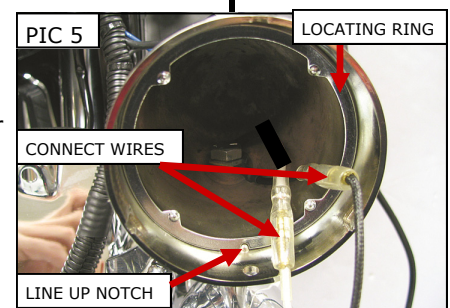
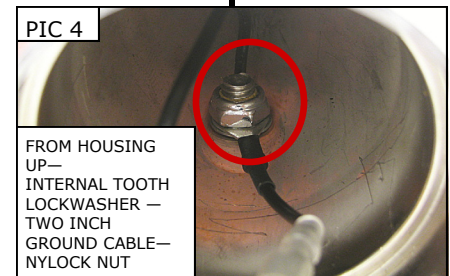
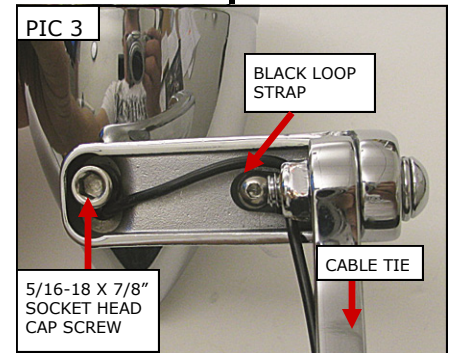
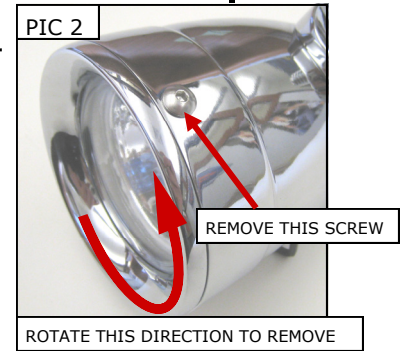
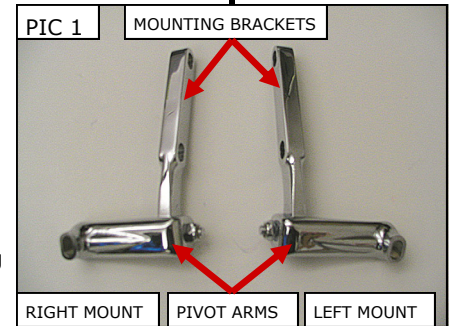

**PAGE
2**

FORK MOUNTED DRIVING LIGHTS

INSTALLATION

NOTICE

Secure all wiring from the newly installed and/or from existing parts, away from any moving parts, pinch points or extreme heat. Kuryakyn WILL NOT issue a warranty on any electrical component that fails due to pinched, crimped, broken, abraded, melted or frayed wires.

Kuryakyn®

STEP 8

Secure the black power cable to the fork mount with the supplied cable ties. Route the wire on the top of the mount to keep clear of any moving components. PIC 3

STEP 9

Insert the metal locating ring (removed in Step 3) inside of the housing making sure to line up the little notch on the bottom. PIC 5

STEP 10

With the light in hand, connect the male bullet connectors on the white and black wires on the light to the female bullet connectors on the two black wires in the housing. **WHITE** wire from the light goes to the **BLACK 48"** wire lead from Step 4 The **BLACK** wire from the light goes to the **BLACK 2"** wire lead from Step 6. PIC 5 Insert the light into the housing with the four slots on the back of the light lining up with the four notches on the metal locating ring.

STEP 11

After the light is installed, place rubber gasket (removed in Step 3) in to the housing (thick end first) with the notch to the bottom.

STEP 12

Place chrome trim on the front of the light housing. Make sure to line up the three notches on the trim ring to the housing. Slightly turn clockwise to lock the trim ring to the housing. Fasten it with the Button Head Cap Screw on the bottom of the housing.

STEP 13

Repeat STEP 3 through STEP 12 for the left driving light using the 60" Power Wire.

Procedure for Mounting the Lights

STEP 14

Fold the tabs back that secure the fender bolts. Remove the two right side fender bolts that are on the inside of the front fender. Set aside they will not be reused. **On Trike model:** Fold the tabs back that secure the nylock nuts on the inside of the fender. Remove the hex head cap screws, plates and nuts. Set them aside, they will not be reused. Retain the washers, they will be reused.

STEP 15

Mount the right side driving light to the fender with the 5/16"-18 x 1-3/4" Hex Head Cap Screws (Trikes will use two of the included 5/16"-18 X 2-3/4" Hex Head Cap Screws and two of the included nylock nuts. Use the washers from Step 1 under the head of each cap screw. PIC 6). Slide the 5/16" Flat Washers between the fender and the light mounting bracket to obtain adequate clearance. Leave snug for now.

STEP 16

Route the power wire up the brake line, behind the lower triple tree, and to the bottom of the fairing. Secure it to the brake line with the provided cable ties.



ENSURE THAT THE INSTALLATION OF THIS PRODUCT DOES NOT CONTACT ANY OTHER COMPONENTS, ESPECIALLY MOVING/ROTATING COMPONENTS (WHEEL, TIRE, VALVE STEM, WHEEL WEIGHTS, ETC.). CONTACT BETWEEN MOVING AND STATIONARY COMPONENTS CAN CAUSE DAMAGE LEADING TO LOSS OF CONTROL RESULTING IN SERIOUS INJURY OR DEATH.

STEP 17

Use a motorcycle jack to lift the front wheel off of the ground; spin the wheel to ensure that there is no contact between ANY parts. Lower the bike to the ground.

STEP 18

Tighten the fender bolts to 16-20ft-lbs. Repeat Steps 14-18 for the left side.

Wiring On '98 and Later Electra Glides, '06 and Later Street Glides and '09 and Later OEM H-D Trike Models to use Accessory Switch

STEP 19

Remove the outer fairing and windscreen as described in the service manual. Unplug the headlight connector and gently set the outer fairing on a soft, sturdy surface. Remove the seat and disconnect the battery.

-cont.-

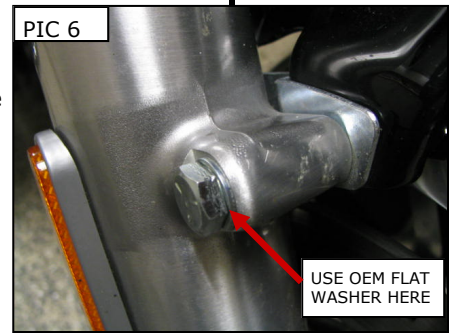



Avoid potential electrical shock! Disconnect the battery before starting this procedure.

NOTICE

Avoid damage to the motorcycle. Protect painted surfaces with a soft cloth or blanket.

NOTICE

Assistance is recommended to secure the outer fairing after all of the Torx screws have been removed to prevent damage.

STEP 20

Locate the 12-Pin wiring adapter from the wiring kit. Locate the 12-Pin connector on the OEM wiring harness. This connector is located on the inside of the right (sitting on bike) fairing support bracket, below the radio. PIC 7 Disconnect the OEM 12-Pin connector.

NOTICE

Küryakyn recommends the use of dielectric grease on electrical connections.

STEP 21

Apply some of the included dielectric grease to each end of the wiring adapter and plug it into the OEM harness. PIC 8 Connect the included white "Y" wire to the insulated female spade on the wiring adapter. Secure the excess wiring out of harms way. **Proceed to Step 27.**

NOTICE

Secure all wiring from the newly installed and/or from existing parts, away from any moving parts, pinch points or extreme heat. Küryakyn WILL NOT issue a warranty on any electrical component that fails due to pinched, crimped, broken, abraded, melted or frayed wires.

Wiring Road Glides Models to use Accessory Switch

STEP 22

Remove the gauge shroud and outer fairing as described in the service manual.

STEP 23

Locate and disconnect the 12-Pin connector in the dash housing. PIC 9

NOTICE

Küryakyn recommends the use of dielectric grease on electrical connections.

STEP 24

Locate the 12-pin wiring adapter from the wiring kit. Apply some of the included dielectric grease to each 12-Pin connector and plug it into the OEM connectors. PIC 10

STEP 25

Route the power wire for the driving lights out under the bottom of the dash, along the OEM harness beside the neck, to the front of the inner fairing. PIC 11

STEP 26

Apply some dielectric grease to the insulated female spade on the power wire and connect it to the supplied white "Y" wire. Secure any excess wiring out of harms way with the included cable ties.

NOTICE

Secure all wiring from the newly installed and/or from existing parts, away from any moving parts, pinch points or extreme heat. Küryakyn WILL NOT issue a warranty on any electrical component that fails due to pinched, crimped, broken, abraded, melted or frayed wires.

All Models Using Accessory Switch

STEP 27

Connect the power wires from the light housings to the white "Y" power wire in the fairing. Secure any excess wire out of harms way with the included cable ties.

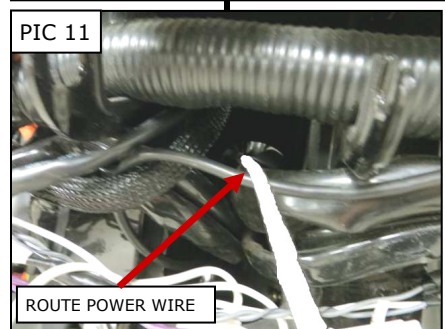
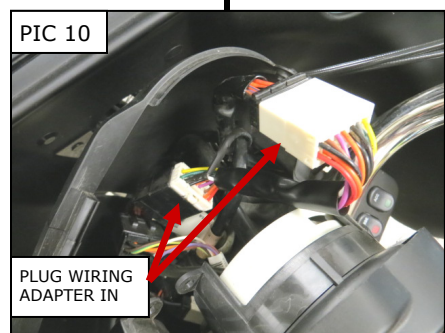
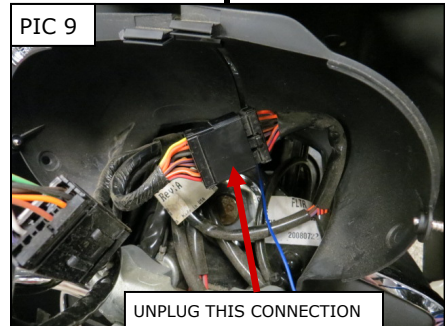
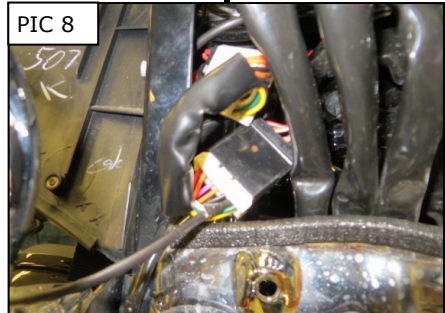
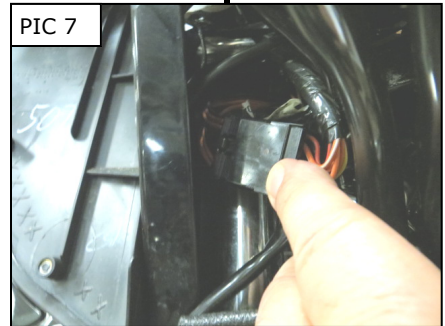

NOTICE

Secure all wiring from the newly installed and/or from existing parts, away from any moving parts, pinch points or extreme heat. Küryakyn WILL NOT issue a warranty on any electrical component that fails due to pinched, crimped, broken, abraded, melted or frayed wires.

Küryakyn®

STEP 28

Reconnect the battery. Replace the seat. Turn the ignition on and check to make sure that the running lights function and the turn signals operate. Flip the switch for the driving lights, ensuring that both are operating properly.

WARNING

ENSURE PROPER LIGHT OPERATION BEFORE RIDING THE MOTORCYCLE. VISIBILITY IS A MAJOR CONCERN FOR MOTORCYCLISTS. A LIGHTING MALFUNCTION COULD RESULT IN DEATH OR SERIOUS INJURY.

WARNING

AFTER INSTALLING THE SEAT, PULL UP ON IT TO ENSURE IT IS LOCKED INTO PLACE. A LOOSE SEAT CAN SHIFT AND CAUSE LOSS OF CONTROL RESULTING IN SERIOUS INJURY OR DEATH.

STEP 29

Reinstall the outer fairing and the windscreen as outlined in the service manual.

NOTICE

It is the end user's responsibility to ensure that all of the fasteners (including pre-assembled) are tightened before operation of the motorcycle. Küryakyn will not provide warranty coverage on products or components lost due to improper installation or lack of maintenance. Periodic inspection and maintenance are required on all fasteners.

FOR UNIVERSAL WIRING ON ANY MODEL WITHOUT A 12-PIN CONNECTOR

NOTE: Küryakyn recommends using one of our Driving Light and Switch/Relay Harnesses, P/N 2202 or P/N 2328 (following their included instructions) to power the lights to prevent overloading a circuit on the bike. You may install the black power wires from the driving lights using the female t-tap connectors and connect them to a "keyed" power source. The lights draw approximately 6 amps. **Before connecting the power wires to a circuit check to make sure that the circuit can handle the additional load.**

WARNING

IT IS THE INSTALLERS RESPONSIBILITY TO ENSURE THAT THE INSTALLATION OF THIS ACCESSORY DOES NOT EXCEED THE MAXIMUM AMPERAGE OF THE CHOSEN CIRCUIT. EXCEEDING THE MAXIMUM ALLOWABLE AMPERAGE MAY LEAD TO CIRCUIT FAILURE WHICH COULD RESULT IN SERIOUS INJURY OR DEATH.

STEP 30

If you decide to install the lights to the existing wiring on the bike, proceed as follows. Using a test light or wiring schematic, with the key in the "ON" position, locate a keyed 12-volt power wire to power the driving lights. Once you have located a keyed 12-volt power source, turn the key to the "OFF" position. Remove the seat and disconnect the battery.

CAUTION

Avoid potential electrical shock! Disconnect the battery before starting this procedure.

NOTICE

Küryakyn recommends the use of dielectric grease on electrical connections.

STEP 31

Take one of the included female T-Tap connectors and place it on the desired power wire. Locate the included "Y" wire, place a small amount of dielectric grease on the female T-Tap connector and insert the male spade connector on the "Y" wire into the female T-Tap connector installed on the "keyed" power wire. Take the black power wires from each light and connect them to the female spades on the "Y" wire. Secure all excess wiring out of harms way with the included cable ties.

-cont.-

PAGE

5

FORK MOUNTED DRIVING LIGHTS

INSTALLATION

NOTICE

Secure all wiring from the newly installed and/or from existing parts, away from any moving parts, pinch points or extreme heat. Küryakyn WILL NOT issue a warranty on any electrical component that fails due to pinched, crimped, broken, abraded, melted or frayed wires.

Küryakyn®

STEP 32

These driving lights are self-grounding so you will not need to hook up any negative leads.

STEP 33

Once all connections are connected, reconnect the battery. Reinstall the seat. Turn the key to the "ON" position and check to ensure the lights work properly.

WARNING

ENSURE PROPER LIGHT OPERATION BEFORE RIDING THE MOTORCYCLE. VISIBILITY IS A MAJOR CONCERN FOR MOTORCYCLISTS. A LIGHTING MALFUNCTION COULD RESULT IN DEATH OR SERIOUS INJURY.

WARNING

AFTER INSTALLING THE SEAT, PULL UP ON IT TO ENSURE IT IS LOCKED INTO PLACE. A LOOSE SEAT CAN SHIFT AND CAUSE LOSS OF CONTROL RESULTING IN SERIOUS INJURY OR DEATH.

STEP 34

If lights do not work, go over the wire connections and check all plugs to see if they are plugged-in correctly. You may also have to use a test light again check if the spade/T-Tap connectors are in the proper locations.

NOTICE

It is the end user's responsibility to ensure that all of the fasteners (including pre-assembled) are tightened before operation of the motorcycle. Küryakyn will not provide warranty coverage on products or components lost due to improper installation or lack of maintenance. Periodic inspection and maintenance are required on all fasteners.

ADJUSTING THE DRIVING LIGHTS

WARNING

IT IS THE INSTALLERS RESPONSIBILITY TO ADJUST THE NEW DRIVING LIGHTS TO THE PATTERN RECOMMENDED IN THE SERVICE MANUAL FOR LOW BEAM ON THE HEADLIGHT. FAILURE TO PROPERLY ADJUST THE LIGHT PATTERN MAY DISTRACT ONCOMING DRIVERS RESULTING IN SERIOUS INJURY OR DEATH.

WARNING

ENSURE THAT THE INSTALLATION OF THIS PRODUCT DOES NOT CONTACT ANY OTHER COMPONENTS, ESPECIALLY MOVING/ROTATING COMPONENTS (WHEEL, TIRE, VALVE STEM, WHEEL WEIGHTS, ETC.). CONTACT BETWEEN MOVING AND STATIONARY COMPONENTS CAN CAUSE DAMAGE LEADING TO LOSS OF CONTROL RESULTING IN SERIOUS INJURY OR DEATH.

STEP 35

For up and down adjustment, loosen the fastener that secures the pivot arm to the fender bracket and tilt the assembly in the desired direction. When the light is in the desired position, tighten the fastener securely. PIC 12

STEP 36

For side to side adjustment, loosen the fastener that secures the light to the pivot arm and rotate the assembly in the desired direction. When the light is in the desired position, tighten the fastener securely. PIC 12

NOTICE

It is the end user's responsibility to ensure that all of the fasteners (including pre-assembled) are tightened before operation of the motorcycle. Küryakyn will not provide warranty coverage on products or components lost due to improper installation or lack of maintenance. Periodic inspection and maintenance are required on all fasteners.

PIC 12

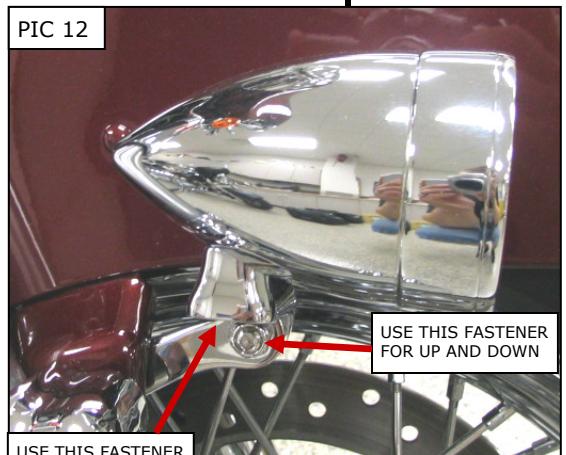

PAGE

6

Ride On!

FORK MOUNTED DRIVING LIGHTS

INSTALLATION