



INSTALLATION

ERGO II/6" ARMS with ISO WINGS

4057

PARTS INCLUDED

- 1 Ergo II Upper Mount — Left
- 1 Ergo II Upper Mount — Right
- 2 Ergo II Lower Mounts
- 2 Chrome Swingarms
- 2 Clevis Mounts Containing:
 - 2 3/8"-16 x 1" Socket Head Cap Screw— Chrome
 - 2 "D" Spring Washers
- 1 Set of ISO Wings
- 1 Hardware Kit Including:
 - 2 Adjustable Stops for Ergo II
 - 2 1/2"-13 x 1-1/4" Button Socket Cap Screw— Chrome
 - 2 1/2" Flat Washer—**NOT USED**
 - 2 1/2" Wave Washer
 - 8 1/4"-20 x 3/4" Socket Head Cap Screw
 - 4 3/8"-16 x 5/8" SSS Cup Point Fasteners
 - 4 1/8" x 5/16" Roll Pins
 - 2 1/2"-13 x 1" Hex Head Cap Screw
 - 2 1/2" Internal Tooth Lock Washer — Chrome
 - 1 Anti-seize
 - 2 Black Rubber Thread Plugs
- 1 Installation Instructions

Please read and understand entire instructions before starting installation.

THANK YOU FOR CHOOSING KÜRYAKYN!

IN ORDER TO PROTECT YOU AND OTHERS FROM POSSIBLE INJURY AND/OR PROPERTY DAMAGE OR LOSS, PLEASE PAY CLOSE ATTENTION TO ALL INSTRUCTIONS, WARNINGS, CAUTIONS AND NOTICES REGARDING THE USE AND CARE OF THIS PRODUCT.

WARNING

THIS INDICATION ALERTS YOU TO THE FACT THAT IGNORING THE CONTENTS DESCRIBED HEREIN CAN RESULT IN POTENTIAL DEATH OR SERIOUS INJURY.

NOTICE

This indication alerts you to the fact that ignoring the contents described herein may negatively affect product performance and functionality.

NOTICE

IF INSTALLING THIS PRODUCT FOR ANOTHER PARTY, PLEASE MAKE SURE THEY RECEIVE THIS COPY OF THE INSTALLATION INSTRUCTIONS SO THEY ARE AWARE OF THE IMPORTANT INFORMATION CONTAINED IN THEM.

TOOLS SUGGESTED

Set of Hex Wrenches, Socket Set with Ratchet

STRICTLY OBSERVE THE FOLLOWING GUIDELINES IN ORDER TO USE THE PRODUCT PROPERLY AND AVOID POTENTIALLY DANGEROUS ACCIDENTS.

STEP 1

Read and understand all steps in the instructions before starting the installation. Park the motorcycle on a hard, level surface and turn off the ignition. Let cool.

NOTE: Not all hardware will be used in this application.

CUSTOMER SERVICE

877.370.3604 (toll free)

INSTALLATION QUESTIONS

techsupport@kuryakyn.com
or call 715.247.2983

LIMITED WARRANTY

Kuryakyn warrants that any Kuryakyn products sold hereunder, shall be free of defects in materials and workmanship for a period of one (1) year from the date of purchase by the consumer excepting the following provisions:

- Kuryakyn shall have no obligation in the event the customer is unable to provide a receipt showing the date the customer purchased the product(s).
 - The product must be properly installed, maintained and operated under normal conditions.
 - Kuryakyn makes no warranty, expressed or implied, with respect to any gold plated products.
 - Kuryakyn shall not be liable for any consequential and incidental damages, including labor and paint, resulting from failure of a Kuryakyn product, failure to deliver, delay in delivery, delivery in nonconforming condition, or for any breach of contract or duty between Kuryakyn and a customer.
- Kuryakyn products are often intended for use in specific applications. Kuryakyn makes no warranty if a Kuryakyn product is used in applications other than intended.

• Kuryakyn electrical products are warranted for one (1) year from the date of purchase by the consumer. L.E.D.'S contained in components of Kuryakyn products will be warranted for defects in materials and workmanship for 3 years from the date of purchase where as all other components shall be warranted for one(1) year. This includes, but is not limited to; control modules, wiring, chrome & other components.

• Kuryakyn makes no warranty of any kind in regard to other manufacturer's products distributed by Kuryakyn. Kuryakyn will pass on all warranties made by the manufacturer and where possible, will expedite the claim on behalf of the customer, but ultimately, responsibility for disposition of the warranty claim lies with the manufacturer.

ABOUT OUR CATALOG

For purchasing Kuryakyn® products, you can receive a complete catalog free of charge. Send the Proof-of-Purchase below with your address to: Kuryakyn, P.O. Box 339, Somerset, WI 54025. Please indicate either Accessories Catalog for Harley-Davidson® or GL & Metric Cruisers.

Be sure to ask your local dealer about other Kuryakyn® products, the motorcycle parts and accessories designed for riders by riders.

©2005 Kuryakyn USA® All Rights reserved.



kuryakyn.com

WARNING YOU WILL BE WORKING AROUND THE ENGINE AND EXHAUST SYSTEM DURING INSTALLATION. ENSURE THAT THE ENGINE AND EXHAUST SYSTEM HAVE FULLY COOLED TO PREVENT INJURY.

NOTICE Use the supplied anti-seize for any chrome-to-chrome fasteners; this will prevent galling and make future removal of fasteners easier.

INSTALLING CLAMP AND SWINGARM ASSEMBLY ON THE ENGINE GUARD

STEP 2 Locate the left mount; the mounts are side specific (PIC 1) so be sure you have the correct mount before attempting the installation. Visually inspect the angle where the swingarm will be attached. The mount should be angled slightly back, toward the rider, **NOT** forward.

STEP 3 Remove the four 1/4"-20 fasteners securing the mount together and separate the upper and lower halves.

STEP 4 Insert the adjustable stop into the lower half of the mount. Thread two of the included 3/8"-16 set screws into the bottom of the mount. PIC 2 Install the mount onto the engine guard. Loosely secure the mount with the four 1/4"-20 fasteners. Do not tighten at this time. PIC 2 Secure the swingarm to the cogged mount using the 1/2"-13 x 1-1/4" Button Socket Cap Screw and wave washer making sure the cogs on the swingarm line up with the cogs on the mount. The swingarm must be positioned level with or above the engine guard. FIG 1

WARNING FOOTPEGS MUST BE INSTALLED SO THEY WILL FOLD UPWARD AND REARWARD IF HIT BY ANY OBJECT. FAILURE TO ADJUST THE FOOTPEGS TO OPERATE IN THIS MANNER COULD RESULT IN SERIOUS INJURY OR DEATH.

STEP 5 Insert two roll pins into the clevis positioning holes. PIC 3

STEP 6 Insert the 1/2"-13 x 1" Hex Head Cap Screw and internal tooth lock washer through the swingarm and thread it into the clevis. Determine the desired angle of the foot peg using the positioning holes in the swingarm. Make sure the roll pins line up with two holes on the swingarm and tighten the cap screw. The roll pins will be pressed into place in the swingarm as you tighten the clevis finger tight. PIC 4

STEP 7 While pushing down lightly on the swingarm, adjust the two set screws (PIC 2) below the adjustable stop to fine tune the foot peg angle.

STEP 8 Tighten the four fasteners on the bottom of the clamp; pushing down lightly on the swingarm while tightening the fasteners to take up any slack between the mount and the engine.

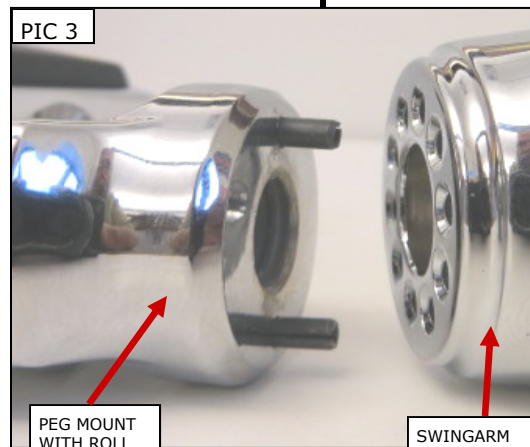
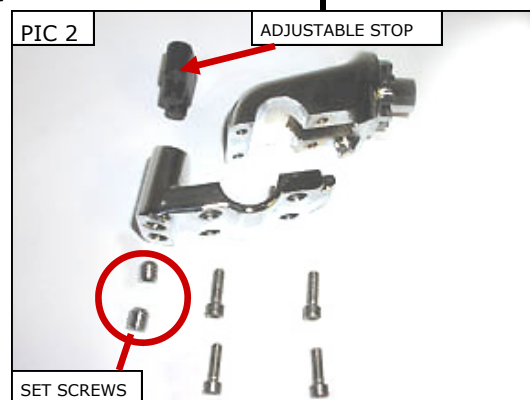
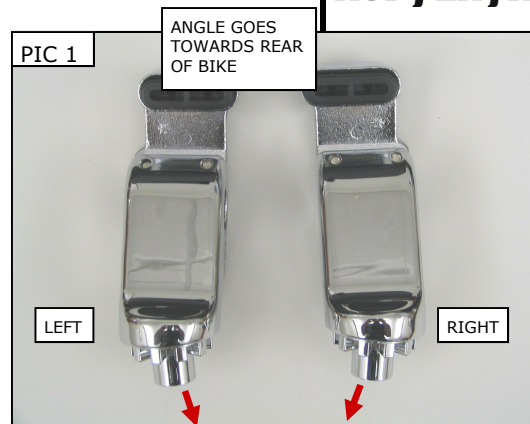

STEP 9 Repeat Steps 2 through 8 for the right side.

ADJUSTING THE POSITION OF SWINGARM AND ISO WINGS

STEP 10 **Adjust for Longer or Shorter Inseam Lengths:**

- Loosen the 1/2"-13 Button Head Fastener securing the swingarm to the mount. Pull the swingarm out of the interlocking cogs.
- Rotate the swing arm to the desired position then push the arm back into the interlocking cogs; be sure the swingarm is either level with the engine guard, or above the engine guard. **NEVER position the swingarm below the engine guard!** FIG 1 Retighten the 1/2"-13 fastener.

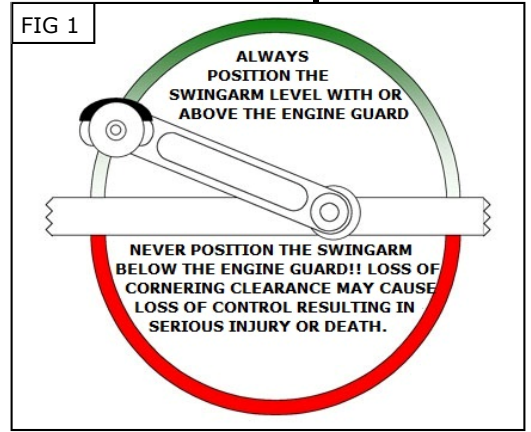

WARNING IT IS THE INSTALLERS RESPONSIBILITY TO ENSURE THERE IS SUFFICIENT CORNERING CLEARANCE BEFORE RIDING. ALWAYS POSITION THE SWINGARM EITHER LEVEL WITH, OR ABOVE THE ENGINE GUARD. POSITIONING THE SWINGARM BELOW THE ENGINE GUARD WILL GREATLY DECREASE CORNERING CLEARANCE WHICH MAY CAUSE LOSS OF CONTROL RESULTING IN SERIOUS INJURY OR DEATH.

STEP 11 **Adjust the Clevis Angle:**

- Loosen the 1/2"-13 Hex Head fastener securing the swingarm to the clevis. Pull outward on the clevis and ISO Wing to clear the roll pins.
- Rotate the clevis and ISO Wing assembly to the desired angle then push the assembly back into the swing arm, making sure the roll pins in the clevis line up with the holes on the swingarm, and re-tighten the fasteners. Install the black thread plug in the swingarm. PIC 5

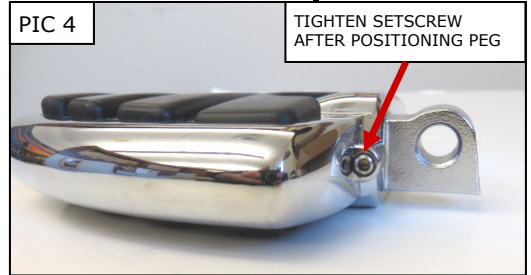

STEP 12 **Adjust the Peg Angle:**

To assist in holding the ISO Wing in the desired position, there is a setscrew on the side of the peg. PIC 4 Loosen the setscrew, then loosen the peg adjustment fastener (PIC 5) and rotate the peg to the desired position. Re-tighten the peg adjustment fastener, then tighten the setscrew.

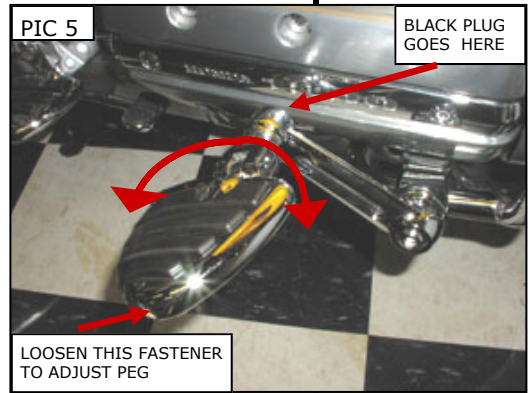

STEP 13 PIC 5 shows the complete assembly.

NOTICE It is the installer's responsibility to ensure that all of the fasteners (including pre-assembled) are tightened before operation of the motorcycle. Küryakyn will not provide warranty coverage on products or components lost due to improper installation or lack of maintenance. Periodic inspection and maintenance are required on all fasteners.