



INSTALLATION

FAIRING SCOOPS with WHITE RUNNING LIGHTS

3903

THANK YOU FOR CHOOSING KÜRYAKYN!

PROTECT YOURSELF AND OTHERS FROM POSSIBLE INJURY AND/OR PROPERTY DAMAGE OR LOSS. PAY CLOSE ATTENTION TO ALL INSTRUCTIONS, WARNINGS, CAUTIONS, AND NOTICES REGARDING THE INSTALLATION, USE, AND CARE OF THIS PRODUCT.

WARNING

THIS INDICATION ALERTS YOU TO THE FACT THAT IGNORING THE CONTENTS DESCRIBED HEREIN CAN RESULT IN POTENTIAL DEATH OR SERIOUS INJURY.

CAUTION

This indication alerts you to the fact that ignoring the contents described herein can result in minor or moderate potential injury.

NOTICE

This indication alerts you to the fact that ignoring the contents described herein may negatively affect product performance and functionality or damage the product itself or the product to which it is being attached.

MAKE SURE THE FOLLOWING PARTS HAVE BEEN INCLUDED IN THE KIT:

- 1 Left Fairing Scoop with L.E.D. Accent
- 1 Right Fairing Scoop with L.E.D. Accent
- 1 Hardware Kit Containing:
 - 1 Long Adapter Harness
 - 1 "Y" Wire Harness
 - 1 Alcohol Pad
 - 4 Cable Keepers
 - 8 4" Cable Ties
- 1 Installation Instructions

TOOLS SUGGESTED

Small flat-blade screwdriver, warm soapy water and a clean rag, ammonia based cleaner (Windex), masking tape

NOTICE

This copy of installation instructions contains important information. Ensure that the end user receives this copy and is aware of its importance for future reference.

NOTE:

In the following instructions, left and right may be referred to as "clutch-side" (left) and "brake-side" (right) for clarity.

STEP 1

Read and understand all steps in the instructions before starting the installation. Park the motorcycle on a hard, level surface and turn off the ignition.

NOTICE

Ensure the area of installation is free of grease, oil, dirt or other debris including wax/polish products and bugs to ensure proper adhesion. Kuryakyn WILL NOT issue a warranty on any parts lost due to improper installation.

CUSTOMER SERVICE

877.370.3604 (toll free)

INSTALLATION QUESTIONS

techsupport@kuryakyn.com
or call 715.247.2983

LIMITED WARRANTY

Kuryakyn warrants that any Kuryakyn products sold hereunder, shall be free of defects in materials and workmanship for a period of one (1) year from the date of purchase by the consumer excepting the following provisions:

- Kuryakyn shall have no obligation in the event the customer is unable to provide a receipt showing the date the customer purchased the product(s).
- The product must be properly installed, maintained and operated under normal conditions.
- Kuryakyn makes no warranty, expressed or implied, with respect to any gold plated products.
- Kuryakyn shall not be liable for any consequential and incidental damages, including labor and paint, resulting from failure of a Kuryakyn product, failure to deliver, delay in delivery, delivery in nonconforming condition, or for any breach of contract or duty between Kuryakyn and a customer.
- Kuryakyn products are often intended for use in specific applications. Kuryakyn makes no warranty if a Kuryakyn product is used in applications other than intended.
- Kuryakyn electrical products are warranted for one (1) year from the date of purchase by the consumer. L.E.D.'S contained in components of Kuryakyn products will be warranted for defects in materials and workmanship for 3 years from the date of purchase where as all other components shall be warranted for one(1) year. This includes, but is not limited to; control modules, wiring, chrome & other components.

- Kuryakyn makes no warranty of any kind in regard to other manufacturer's products distributed by Kuryakyn. Kuryakyn will pass on all warranties made by the manufacturer and where possible, will expedite the claim on behalf of the customer, but ultimately, responsibility for disposition of the warranty claim lies with the manufacturer.

ABOUT OUR CATALOG

For purchasing Kuryakyn® products, you can receive a complete catalog free of charge.

Send the Proof-of-Purchase below with your address to: Kuryakyn, P.O. Box 339, Somerset, WI 54025.

Please indicate either Accessories Catalog for Harley-Davidson® or GL & Metric Cruisers.

Be sure to ask your local dealer about other Kuryakyn® products, the motorcycle parts and accessories designed for riders by riders.

©2005 Kuryakyn USA® All Rights reserved.



kuryakyn.com

BIKE PREP:

STEP 2

Thoroughly clean the areas shown in PIC 1, 2, and 3 with soapy water and a clean rag. It is important to clean the outside of the fairing as well as the inside. Rinse and dry completely. Wipe the areas with the included alcohol pad to remove any residue. Allow the surfaces to dry completely.

INSTALL THE FAIRING SCOOPS:

STEP 3

Test fit Fairing Scoops with White Running Lights to the area shown in PIC 2. Make any reference marks with a non-permanent marker or masking tape. PIC 2

NOTICE

The adhesive will not bond correctly if applied at temperatures less than 50°F. Do not attempt this installation in temperatures less than 50°F.

STEP 4

Rub the backing paper of the Fairing Scoop with your fingernail to activate the adhesive. Remove the backing paper and attach the Fairing Scoop to the fairing using the reference marks/tape. PIC 2 Hold in place for one minute, full bonding will occur in 24 hours.

NOTICE

If the motorcycle is to be operated before the 24 hour cure time has expired, use a good quality masking or painter's tape over the Fairing Scoop to hold it in place until the cure time is over.

STEP 5

Repeat **STEPS 3 and 4** for the other side.

Step 6

Rub the backing paper on one of the included Cable Keepers to activate the adhesive. Remove the backing paper and stick it to the inside of the fairing as shown in PIC 3. Stick the other three Cable Keepers along the inside of the fairing as shown in PIC 4. Ensure that you stick the Keepers to clean dry surfaces. Hold each one in place for one minute, full bonding will occur in 24 hours.

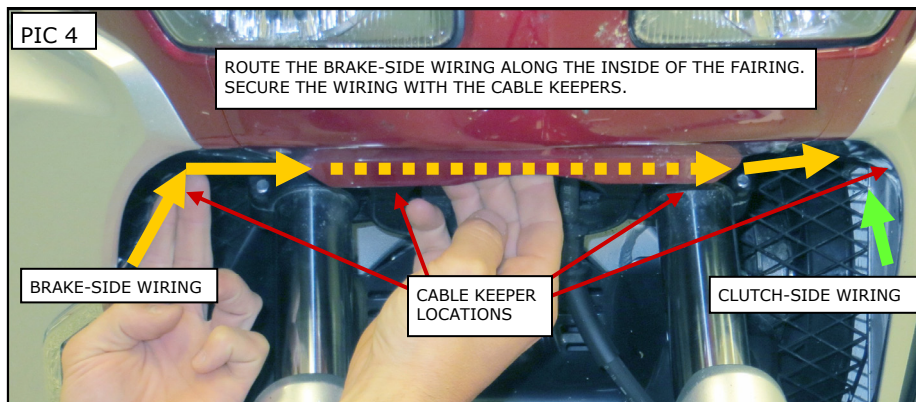

Step 7

Route the brake-side wiring along the inside of the fairing as shown in PIC 4. Secure the wiring in the Cable Keepers. Ensure that the Cable Keepers snap shut.

STEP 8

Secure the clutch-side wiring in the Cable Keeper. PIC 4 Ensure that the Cable Keeper snaps shut.

-cont.-

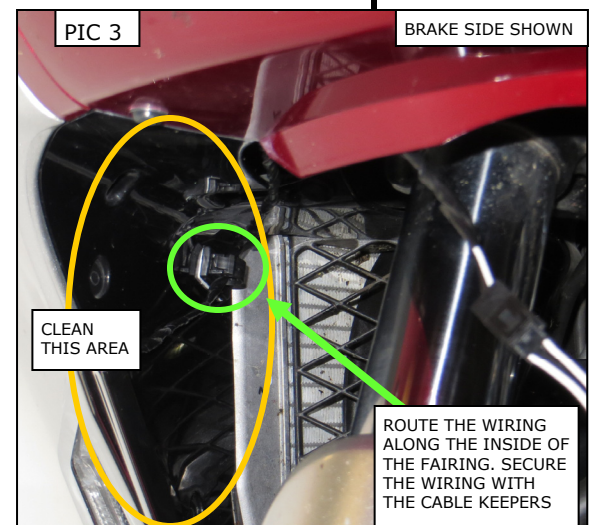
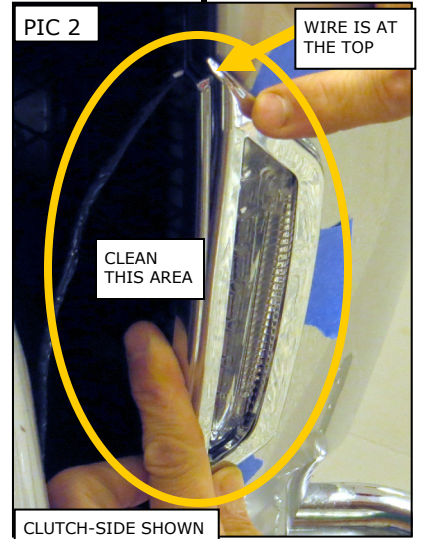
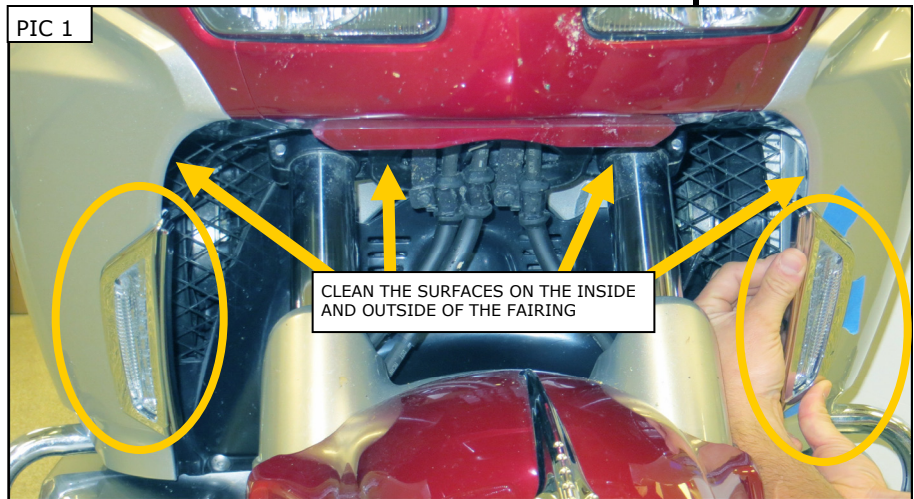

INSTALL THE WIRING HARNESSES:

Kuryakyn®

STEP 9

Use a small flat blade screwdriver to CAREFULLY pry the edge of the clutch-side fairing trim up as shown in PIC 5. Start at the bottom side as shown in PIC 5. Making your way up the side, gently pull up on the trim to release the tabs from the fairing. PIC 6 The bottom two tabs may take considerable force to release. **Be Patient and Careful.**

STEP 10

Open the side compartment. PIC 7 Use the screwdriver to push in the center of the four pop rivets. Pull the pop rivets straight out and set them aside for later use.

STEP 11

Remove the side compartment and set it aside.

STEP 12

Looking into the side-compartment area, you should be able to see through to the front fender area. Route the double connector-side of the included Long Adapter Harness through the inside the fairing as shown in PIC 8. Aim for the front fender area.

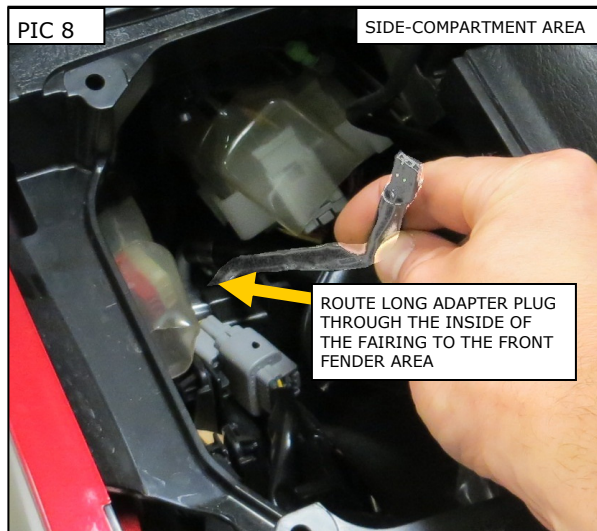

STEP 13

Locate the **RED** OEM connector in the clear plastic boot shown in PIC 9.

NOTICE

Kuryakyn recommends the use of dielectric grease on ALL electrical connections.

STEP 14

Apply some of the included dielectric grease to the open ends of the OEM **RED** connector and the included "Y" Wire Harness.

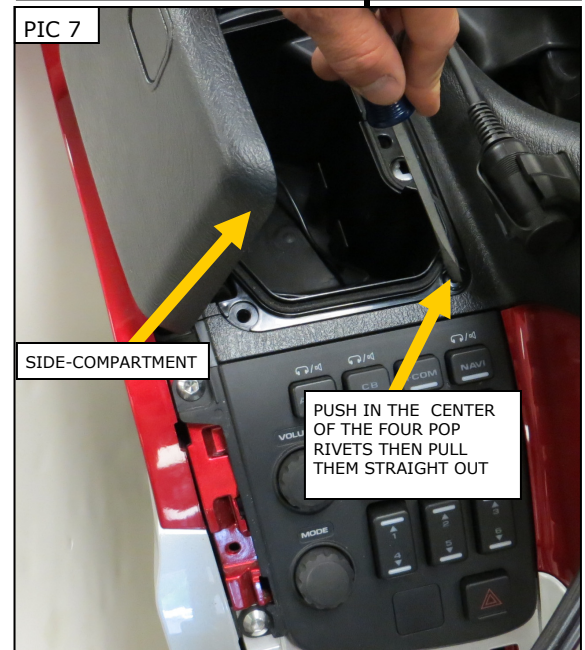
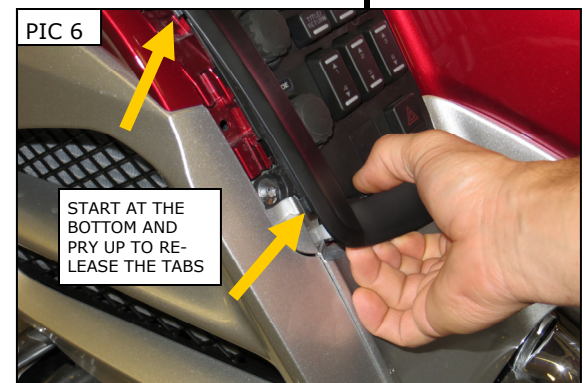
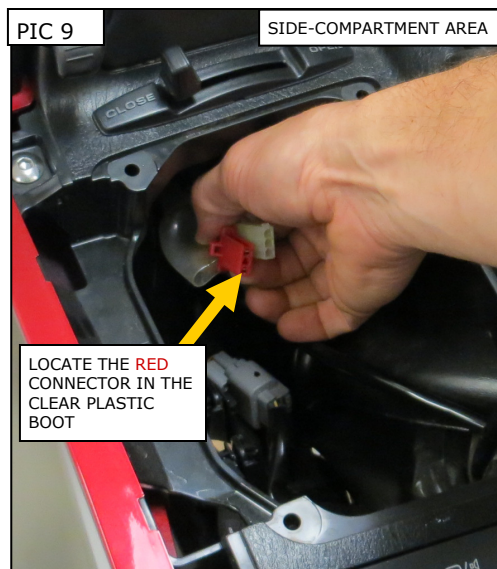

PAGE
3

-cont.-

STEP 15

Refer to PIC 10. Connect the included "Y" Wire Harness to the **RED** OEM connector.

STEP 16

Apply some of the dielectric grease to the open ends of the 3-pin connectors on the included Long Adapter Harness and "Y" Harness. Join the 3-pin connectors to each other as shown in PIC 11.

STEP 17

Move to the front fender area of the bike and apply some dielectric grease to the connectors from the Fairing Scoop lights to the double-connector-side of the Long Adapter Harness. Join the connectors together.

STEP 18

Turn the ignition on and test for proper function of the lights.

STEP 19

Secure all wiring out of harms way with the included cable ties. Collect any extra length of wire in the glove box area. Secure any extra wiring with Cable Ties away from the front fender/fairing area.

NOTICE

Secure all wiring away from any moving parts, pinch points or extreme heat. Kuryakyn WILL NOT warranty any electrical component that fails due to pinched, crimped, broken, abraded, melted or frayed wires.

STEP 20

Refer to PIC 12 and 13. Push the center pin as shown to "reset" the pop rivet.

STEP 21

Reinstall the side compartment in the reverse order it was removed. Insert the pop rivets in their holes and press the center pin down to secure the side compartment in the fairing..

STEP 22

Reinstall the fairing trim. Hook the top of the trim into the fairing and press the tabs into place moving toward the bottom.

STEP 23

Ensure that ALL lights on the bike properly function before riding the bike.

WARNING

VISIBILITY IS A MAJOR CONCERN FOR MOTORCYCLISTS. A LIGHT MALFUNCTION COULD RESULT IN DEATH OR SERIOUS INJURY. ENSURE PROPER LIGHT OPERATION BEFORE RIDING THE MOTORCYCLE.

Kuryakyn®

PIC 10

CONNECT THE INCLUDED "Y"-WIRE HARNESS TO THE **RED** CONNECTOR

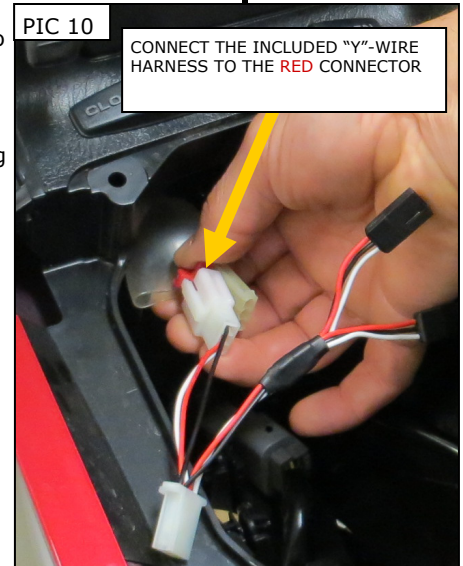

PIC 11

3-PIN CONNECTOR FROM LONG ADAPTER HARNESS

3-PIN CONNECTOR FROM "Y" WIRE HARNESS

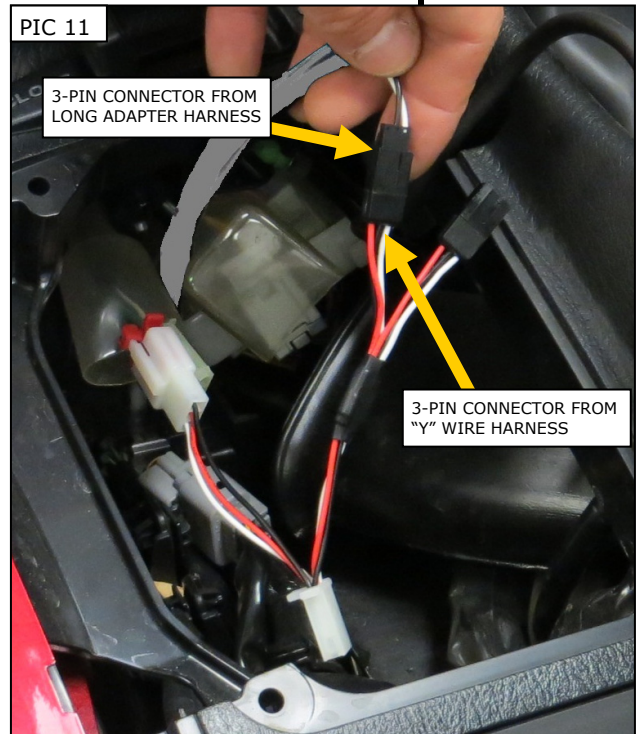

PIC 12

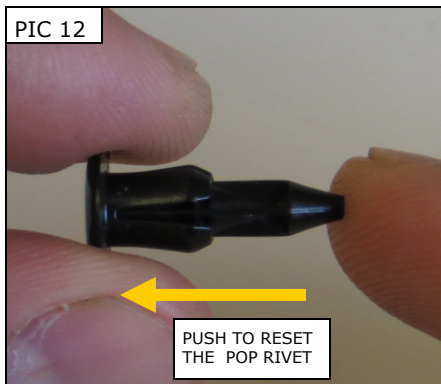

PIC 13

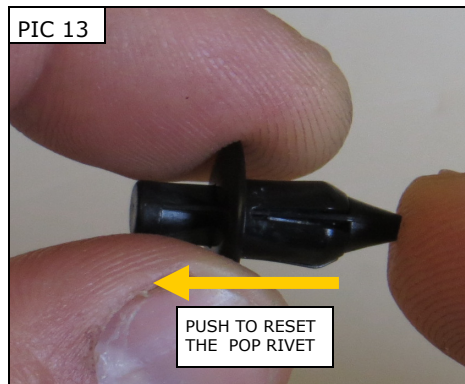
*Ride On!*

PAGE
4