



TOP DRIVING LIGHT MOUNTS

2282

OR TURN SIGNAL MOUNTS FOR VTX

FITS: '03-UP VTX1300 R, S, C AND '02-UP VTX 1800 R, S, C & F
NOTE: WILL NOT WORK WITH WINDSHIELDS THAT RUN ALONG THE SIDE OF THE HEADLIGHT OR WITH KÜRYAKYN DRIVING LIGHT BAR (P/N 4001).

PARTS INCLUDED

- 1 Right Mount Bracket
- 1 Left Mount Bracket
- 2 5/16" External Tooth Lock Washer
- 1 Installation Instructions

REQUIRES

Silver Bullets P/N 2336, 2337, 2367 or similar product that mounts with 5/16 mounting hole. (Sold Separately.)

Not all of the included parts will be used during this installation.

SUGGESTED Use P/N 2328 Universal Wiring and Relay Kit when installing Halogen Silver Bullets. (Sold Separately.)

Please read and understand entire instructions before starting installation.

THANK YOU FOR CHOOSING KÜRYAKYN!

CAUTION! Ensure that the installation of this product does not interfere with the proper operation of the motorcycle before riding.

ATTENTION! It is the installer's responsibility to ensure all fasteners (including pre-assembled) are tightened before operation of the motorcycle. Kuryakyn will not warranty components lost due to improper installation. Periodic maintenance may be required.

ATTENTION! Secure all wiring away from any moving parts, pinch points or extreme heat. Kuryakyn WILL NOT warranty any electrical component that fails due to pinched, crimped, broken, abraded, melted or frayed wires.

NOTE Installation is shown on a 2006 VTX1800F and a 2003 VTX1800R, while representative of typical procedure, there may be minor differences when installed on other models.

NOTE Avoid damage to motorcycle. Protect painted surfaces with soft cloth or blanket.

NOTE Do not overload the driving light/turnsignal circuit.

TOOLS SUGGESTED

Set of hex wrenches, set of combination wrenches, socket set and ratchet

-cont.-

CUSTOMER SERVICE

877.370.3604 (toll free)

INSTALLATION QUESTIONS

techsupport@kuryakyn.com
or call 715.247.2983

LIMITED WARRANTY

Kuryakyn warrants that any Kuryakyn products sold hereunder, shall be free of defects in materials and workmanship for a period of one (1) year from the date of purchase by the consumer excepting the following provisions:

- Kuryakyn shall have no obligation in the event the customer is unable to provide a receipt showing the date the customer purchased the product(s).
- The product must be properly installed, maintained and operated under normal conditions.
- Kuryakyn makes no warranty, expressed or implied, with respect to any gold plated products.
- Kuryakyn shall not be liable for any consequential and incidental damages, including labor and paint, resulting from failure of a Kuryakyn product, failure to deliver, delay in delivery, delivery in nonconforming condition, or for any breach of contract or duty between Kuryakyn and a customer.
- Kuryakyn products are often intended for use in specific applications. Kuryakyn makes no warranty if a Kuryakyn product is used in applications other than intended.
- Kuryakyn electrical products are warranted for one (1) year from the date of purchase by the consumer. Components of Kuryakyn products containing L.E.D.s will be warranted for defects in materials and workmanship for 3 years from the date of purchase.
- Kuryakyn makes no warranty of any kind in regard to other manufacturer's products distributed by Kuryakyn. Kuryakyn will pass on all warranties made by the manufacturer and where possible, will expedite the claim on behalf of the customer, but ultimately, responsibility for disposition of the warranty claim lies with the manufacturer.

ABOUT OUR CATALOG

You'll find all our innovations for H-D, GL and Metric Cruisers in our annual catalogs. Order online today—select the "CATALOGS" icon. Each Kuryakyn product comes with a Proof-of-Purchase good for a complimentary catalog. Details in packaging.

Be sure to ask your local dealer about other Kuryakyn products, the motorcycle parts and accessories designed for riders by riders.

©2005 Kuryakyn USA All Rights reserved.



PROCEDURE

STEP 1 Park the motorcycle on a hard, level surface; turn off the ignition.

STEP 2 Remove the stock head light mounting hardware on the right side (rider's perspective); set it aside it will be re-used.

STEP 3 Loosen the stock head light mounting hardware on the left side to ease installation.

STEP 4 Locate the right bracket. See [FIG.1](#) and [PIC.1](#).

STEP 5 Install the driving lights/turnsignals (sold separately) on the light mounts. Refer to the instructions included with the new driving lights/turnsignals for further information; do not connect the wires at this point.

STEP 6 Position the light mount UNDER the stock headlight bracket. See [PIC.1](#).

STEP 7 Reinstall the stock fastener through the headlight bracket, the included 5/16 external tooth lock washer, the driving light/turn signal mount and lower triple clamp.

STEP 8 Reinstall the stock nut; finger-tighten for now.

STEP 9 Remove the stock head light mounting hardware on the left side and set it aside for now, it will be re-used.

STEP 10 Locate the left side bracket. See [FIG.1](#).

STEP 11 Install the driving lights/turnsignals (sold separately) on the light mounts. Refer to the instructions included with the new driving lights/turnsignals for further information; do not connect the wires at this point.

STEP 12 Position the light mount UNDER the stock headlight bracket.

STEP 13 Reinstall the stock fastener through the headlight bracket, 5/16 external tooth lock washer, the driving light/turn signal mount and lower triple clamp.

STEP 14 Reinstall the stock nut; finger-tighten for now.

STEP 15 Connect the driving light/turn signal wires (sold separately). Refer to the instructions included with the lights for more information.

STEP 16 Align the driving light/turn signal mounts straight ahead and tighten all fasteners.

ATTENTION! Secure all wiring away from any moving parts, pinch points or extreme heat. Kuryakyn WILL NOT warranty any electrical component that fails due to pinched, crimped, broken, abraded, melted or frayed wires.

CAUTION! Ensure that the installation of this product does not interfere with the proper operation of the motorcycle before riding.

Kuryakyn

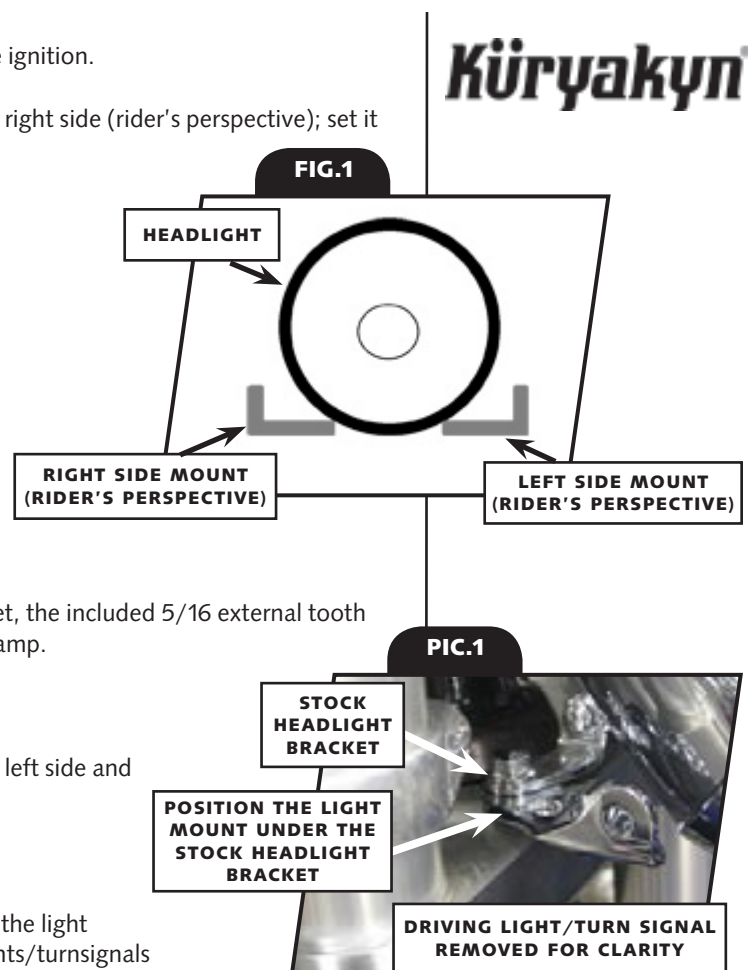

Ride On!

PAGE
2

DRIVING LIGHT/TURN SIGNAL MOUNTS INSTALLATION