



INSTALLATION

FUEL DOOR/GPS ACCESSORY MOUNT 1691

PARTS INCLUDED

- 1 Fuel Door GPS/Accessory Mount
- 1 Hardware Kit, including:
 - 4 #8-32 X 1" Phillips Head Pan Screws
 - 4 #8 Flat Washers
 - 4 #8 Nylon Insert Locknuts
 - 2 2" X 3/4" Foam Pads
 - 2 8" X 1/2" Hook and Loop Straps
 - 4 6" Black Nylon Cable Ties
 - 2 #8-32 x 1/4" Slotted Hex Head Screws
 - 2 Cord Keepers
- 1 Installation Instructions

Not all of the included parts will be used during this installation. Please read and understand entire instructions before starting installation.

Please read and understand entire instructions before starting installation.

THANK YOU FOR CHOOSING KÜRYAKYN!

IN ORDER TO PROTECT YOU AND OTHERS FROM POSSIBLE INJURY AND/OR PROPERTY DAMAGE OR LOSS, PLEASE PAY CLOSE ATTENTION TO ALL INSTRUCTIONS, WARNINGS, CAUTIONS AND ATTENTION NOTES REGARDING THE USE AND CARE OF THIS PRODUCT.

WARNING! THIS INDICATION ALERTS YOU TO THE FACT THAT IGNORING THE CONTENTS DESCRIBED HEREIN CAN RESULT IN POTENTIAL DEATH OR SERIOUS INJURY.

ATTENTION! This indication alerts you to the fact that ignoring the contents described herein may negatively affect product performance and functionality.

CAUTION! This indication alerts you to the fact that ignoring the contents described herein can result in potential injury or material damage.

TOOLS SUGGESTED

Set of Hex Wrenches, Set of Combination Wrenches, Phillips Screwdriver, Blade Screwdriver

STRICTLY OBSERVE THE FOLLOWING GUIDELINES IN ORDER TO USE THE PRODUCT PROPERLY AND AVOID POTENTIALLY DANGEROUS ACCIDENTS.

STEP 1 Read and understand all steps in the instructions before starting the installation. Park the motorcycle on a hard, level surface and turn off the ignition.

STEP 2 Open the fuel door to gain access to the backside of the lock assembly.

-cont.-

1691-21HD-0711



CUSTOMER SERVICE

877.370.3604 (toll free)

INSTALLATION QUESTIONS

techsupport@kuryakyn.com
or call 715.247.2983

LIMITED WARRANTY

Kuryakyn warrants that any Kuryakyn products sold hereunder, shall be free of defects in materials and workmanship for a period of one (1) year from the date of purchase by the consumer excepting the following provisions:

- Kuryakyn shall have no obligation in the event the customer is unable to provide a receipt showing the date the customer purchased the product(s).
 - The product must be properly installed, maintained and operated under normal conditions.
 - Kuryakyn makes no warranty, expressed or implied, with respect to any gold plated products.
 - Kuryakyn shall not be liable for any consequential and incidental damages, including labor and paint, resulting from failure of a Kuryakyn product, failure to deliver, delay in delivery, delivery in nonconforming condition, or for any breach of contract or duty between Kuryakyn and a customer.
- Kuryakyn products are often intended for use in specific applications. Kuryakyn makes no warranty if a Kuryakyn product is used in applications other than intended.
- Kuryakyn electrical products are warranted for one (1) year from the date of purchase by the consumer. L.E.D.'S contained in components of Kuryakyn products will be warranted for defects in materials and workmanship for 3 years from the date of purchase where as all other components shall be warranted for one(1) year. This includes, but is not limited to; control modules, wiring, chrome & other components.
- Kuryakyn makes no warranty of any kind in regard to other manufacturer's products distributed by Kuryakyn. Kuryakyn will pass on all warranties made by the manufacturer and where possible, will expedite the claim on behalf of the customer, but ultimately, responsibility for disposition of the warranty claim lies with the manufacturer.

ABOUT OUR CATALOG

For purchasing Kuryakyn® products, you can receive a complete catalog free of charge. Send the Proof-of-Purchase below with your address to: Kuryakyn, P.O. Box 339, Somerset, WI 54025. Please indicate either Accessories Catalog for Harley-Davidson® or GL & Metric Cruisers.

Be sure to ask your local dealer about other Kuryakyn® products, the motorcycle parts and accessories designed for riders by riders.

©2005 Kuryakyn USA® All Rights reserved.



kuryakyn.com

STEP 3 Remove the large lock nut securing the lock to the fuel door. See PIC.1. Set the lock nut aside; it will be re-used. Remove the lock assembly and set it aside; it will be re-used.

CAUTION! Avoid damage to the motorcycle. Protect painted surfaces with a soft cloth or blanket.

STEP 4 Remove the gas cap and set it aside; stuff a clean dry rag into the filler hole to prevent small parts from falling into the fuel tank.

WARNING! GASOLINE FUMES ARE EXTREMELY FLAMMABLE! WORK IN A WELL VENTILATED AREA AWAY FROM OPEN FLAMES, SPARKS OR OTHER SOURCES OF IGNITION.

STEP 5 Remove the two screws shown in PIC.1; set them aside, they will not be re-used.

STEP 6 Carefully remove the bracket securing the fuel door to the fuel tank trim. See PIC.2. Set the bracket aside for now, it will be re-used.

STEP 7 Locate the new Fuel Door GPS/Accessory Mount. Position the Fuel Door Mount so that the bosses on the underside fit over the hinge pin in the fuel tank trim. See PIC.3.

STEP 8 Assemble the bracket from Step 6 and the new Fuel Door Mount in the reverse order they were removed. Secure the bracket with the two included #8-32 x 1/4 SHHS. Do not over tighten the two screws.

STEP 9 Install the existing lock and lock nut in the reverse order it was removed in STEP 3.

ATTENTION! It is the installer's responsibility to ensure that all of the fasteners (including preassembled) are tightened before operation of the motorcycle. Küryakyn will not warranty components lost due to improper installation. Periodic maintenance may be required.

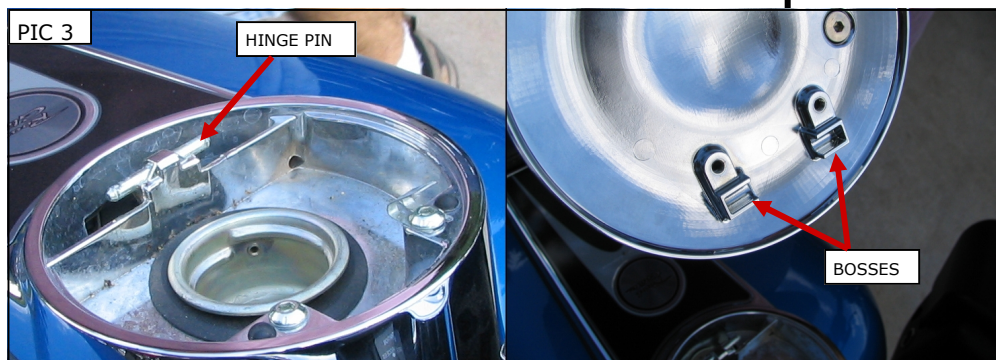
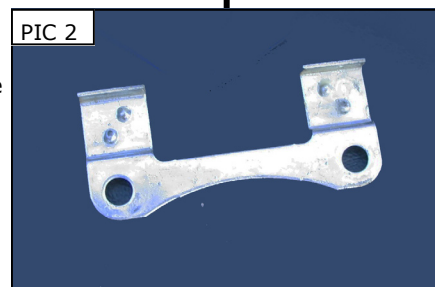
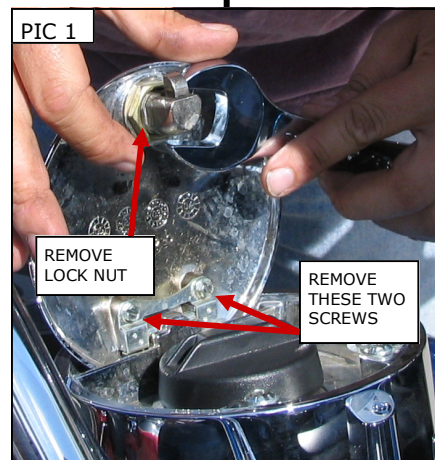

STEP 10 Remove the rag and install the gas cap.

STEP 11 Test for proper operation of the lock and fuel door.

CAUTION! Ensure that the installation of this product does not interfere with the proper operation of the motorcycle before riding.

Adjustment Procedure

STEP 1 Loosen the thumbscrew (located on the left side of the mount) enough to disengage the splines. PIC 4

STEP 2 Adjust the mount to the desired angle and tighten the thumbscrew. Ensure that the splines fully engage.

-cont.-

Attaching GPS/Accessories

NOTE: Works well with Kuryakyn Accessory Pouches and Ram Device Holders.

- The 4-hole AMPS pattern ("A" in PIC.4) is common to many GPS and satellite radio docking cradles. The included #8-32 X 1" Phillips Head Screws, #8 Flat Washers and #8 nylon insert lock nuts can be used to mount cradles to the stainless steel mounting plate. You may use any combination of slots and hardware to securely mount your accessory to the mounting plate.

ATTENTION! It is the installer's responsibility to ensure that all of the fasteners (including preassembled) are tightened before operation of the motorcycle. Küryakyn will not warranty components lost due to improper installation. Periodic maintenance may be required.

- Hook and loop strap keepers ("B" in PIC.4).
- General-purpose mounting slots ("C" in PIC.4).
- Belt clip retainer ("D" in PIC.4).
- The adhesive foam has been included for vibration dampening where necessary.
- The included cable ties and cord keepers have been included to secure accessory wiring out of the way of pinch points, extreme heat and moving parts.
- The stainless steel mounting plate can be drilled and tapped to accommodate different mounting patterns.

CAUTION! Avoid damage to the motorcycle. Protect painted surfaces with a soft cloth or blanket.

ATTENTION! Secure all wiring away from any moving parts, pinch points or extreme heat. Küryakyn WILL NOT warranty any electrical component that fails due to pinched, crimped, broken, abraded, melted or frayed wires.

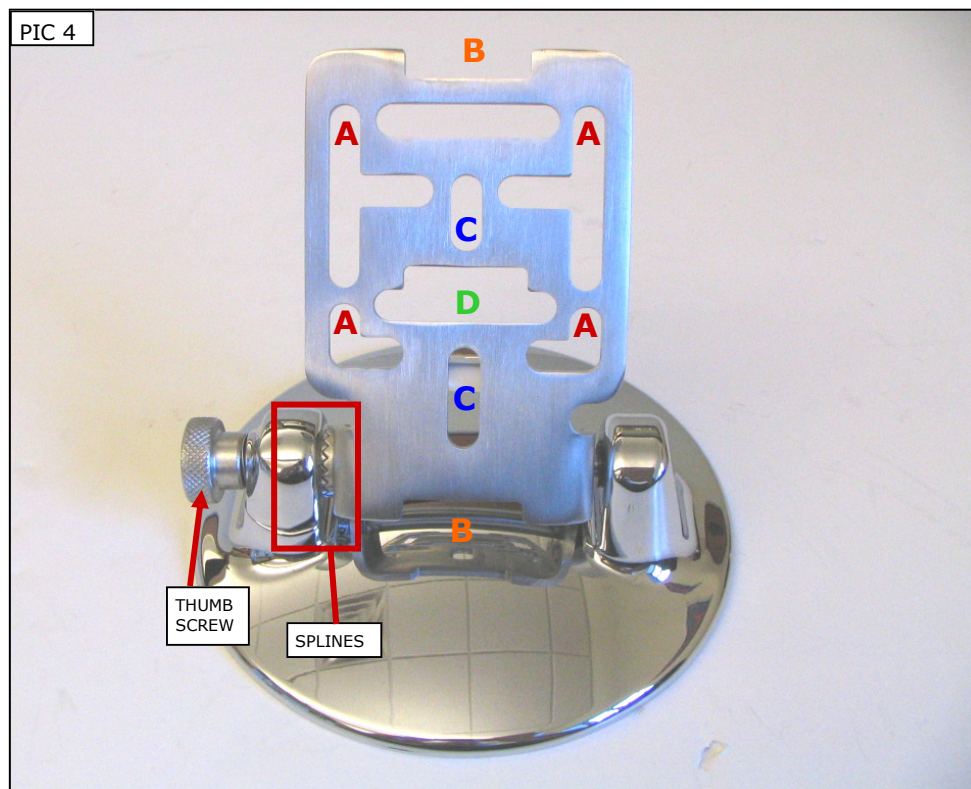

Ride On!