



**AKRAPOVIC SLIP-ON, SLIP-ON STREET LEGAL, SLIP-ON SP SERIES & SLIP-ON SP
SERIES STREET LEGAL EXHAUST SYSTEM**

**for the
YAMAHA YZF R1 (2007-)**

Congratulations on purchasing an Akrapovic exhaust system. Please read these installation instructions carefully. If you have any trouble installing the system please contact your authorized dealer!

IMPORTANT INFORMATION

Exclusion of Certain Liability

1. The manufacturer, importer or dealer shall not be liable for any incidental damage including personal injury or any other damages caused by improper installation or operation of the Akrapovic exhaust system. When installing the Akrapovic exhaust system be careful that the exhaust system does not touch other parts sensitive to high temperature.
2. Akrapovic makes no representation or warranties with regard to damage caused by the improper installation, use and maintenance of the Akrapovic exhaust system. The warranty is limited to defects recognized by our technical department and to normal use, and excludes items subject to normal wear (gaskets and damping wool). The guarantee is void in case of accident, modification, improper or competition use.
3. Do not attempt to install the Akrapovic exhaust system on a motorcycle for which it was not made or tested by Akrapovic.
4. When the exhaust system gets very hot during operation, be careful not to burn yourself on the exhaust system or parts which are in direct contact with it, even when the motor is not running. Also protect other people, especially children, from the injuries mentioned above.
5. In some cases Akrapovic exhaust system kits contain chemical products (ceramic anti-seizing grease; bolt sealant). Handle with care, do not inhale or swallow. Avoid excessive contact with skin, eyes or mucous membranes. Keep out of reach of children.
6. Technical specifications of Akrapovic exhaust systems and related products subject to change without notice.

Trademarks

The Akrapovic Exhaust System Technology logo is a registered trademark of Akrapovic d.d.

Akrapovic website

Information about Akrapovic exhaust systems and related products is available on the Akrapovic website at:
<http://www.akrapovic-exhaust.com/>

Copyright

No part of the Akrapovic exhaust system or its documentation may be reproduced or distributed in any form or by any means without the prior written authorization of the Akrapovic company.

© Akrapovic d.d. All rights reserved.

Symbols

The following symbols are used throughout these installation instructions:



INSTALLATION INSTRUCTIONS



BEFORE INSTALLING CHECK SCHEMATIC OF THE EXHAUST SYSTEM!



IF ANY ITEMS IN THE AKRAPOVIC EXHAUST SYSTEM PACKAGE ARE MISSING PLEASE CONTACT YOUR AUTHORIZED DEALER. KEEP THE SCHEMATIC FOR FUTURE REFERENCE.



THESE INSTALLATION INSTRUCTIONS MUST BE READ CAREFULLY IN ORDER TO ENSURE PROPER INSTALLATION AND OPERATION OF THE AKRAPOVIC EXHAUST SYSTEM.



THE EXHAUST SYSTEM CAN BE EXTREMELY HOT. ALLOW THE MOTORCYCLE TO COOL DOWN BEFORE BEGINNING INSTALLATION.



WE ADVISE YOU TO LEAVE INSTALLATION TO A QUALIFIED SERVICEMAN. IMPROPER INSTALLATION MAY RESULT IN A SHORTER LIFETIME OF THE EXHAUST SYSTEM AND/OR DAMAGE TO THE MOTORCYCLE.



IN CASE OF OPTIONAL Y-LINK PIPE THE HOMOLOGATION IS NOT VALID!

REMOVAL OF STOCK EXHAUST SYSTEM

1. put the motorcycle on a side stand, we recommend a racing stand
2. unlock and remove the rear passengers seat (**Figure 1**)
3. unscrew the bolts from the drivers seat and remove the seat (**Figure 2**)
4. unscrew the bolts from the fastback and remove the fastback (**Figure 3, 4, 5**)
5. unscrew the bolts from the plastic cover of the muffler hanging bracket and remove the cover (**Figure 6**)
6. unscrew and remove the heat shield (**Figure 7, 8, 9**)
7. unscrew the bolt from the link pipe metal clamp (muffler – link pipe connection) (**Figure 10**), the bolt from the muffler hanging bracket and remove the muffler; perform the process on both sides of the motorcycle (**Figure 11, 12**)

IN CASE OF OPTIONAL Y-LINK PIPE ONLY: REMOVAL OF STOCK Y- LINK PIPE

8. unscrew the bolts from the rider's footrest bracket and rear brake stop switch – do not disconnect the brake fluid tube! (**Figure 13, 14**)
9. unscrew and remove the lower part of the cowling (**Figure 15, 16, 17**)
10. unscrew and remove the lambda sensor (**Figure 18**)
11. unscrew the bolt from the Y-link pipe metal clamp (Y-link pipe - collector connection) (**Figure 19**)
12. unscrew the bolts from the Y-link pipe metal brackets and remove the Y-link pipe (**Figure 20, 21, 22, 23**)

IN CASE OF OPTIONAL Y-LINK PIPE ONLY: INSTALLATION OF THE AKRAPOVIC SLIP-ON EXHAUST SYSTEM WITH OPTIONAL Y-LINK PIPE

installing the independent link pipe:

1. make sure the Akrapovic Y-link pipe and metal clamp is correctly oriented (**Figure 24**)
2. install the stock Alu heatsheald onto the Akrapovic optional Y-link pipe; use two stock bolts and washers (**Figure 25, 26**)
3. slide the Y-link pipe onto the collector (**Figure 27**)
4. fasten the Y-link pipe to the chassis hanging brackets (**Figure 28, 29**)
5. attach lambda sensor (**Figure 30**)
6. tighten the bolt from the Y-link pipe metal clamp (Y-link pipe - collector connection) (**Figure 31**)
7. make sure the Y-link pipe is not touching the engine or frame of the motorcycle
8. reattach the lower part of the cowling, footrest bracket and rear brake stop switch in the reverse order from the order in which they were removed (**Figure 32, 33, 34**)

INSTALLATION OF THE AKRAPOVIC SLIP-ON EXHAUST SYSTEM

installing the muffler with link pipe:

1. make sure the metal clamps are correctly oriented (**Figure 35**)
2. correctly position the carbon-fiber clamp and slide it onto the muffler. **WARNING:** open the clamp to slightly wider than the diameter of the outer sleeve of the muffler – do not scrape it along the muffler outer sleeve! (**Figure 36**)
3. position the muffler correctly and slide it onto the outlet side of the stock Y-link pipe or in case of Akrapovic optional Y-link pipe onto the outlet side of the Akrapovic Y-link pipe (**Figure 37**)
4. tighten the carbon-fiber clamp onto the stock chassis hanging bracket on the frame ; – use the spacer, bolt, washer and nut supplied in the Akrapovic kit. Do not fully tighten. Make sure the additional parts from the Akrapovic kit are correctly installed (**Figure 38, 39, 40, 41, 42**)
5. tighten the metal clamp on the link pipe (**Figure 43**)
6. perform the process on both sides of the motorcycle
7. make sure the mufflers are not touching other parts of the motorcycle
8. reattach the stock heatsheald ; use Akrapovic aluminium spacer and bolt (**Figure 44, 45, 46**)

final installation:

1. tighten the bolts on all of the brackets and clamps to which the exhaust system and the other dismantled parts of the motorcycle are attached
2. clean grease spots:
 - a. muffler – carbon-fiber outer sleeve: use a soft dry cloth
 - b. muffler – titanium outer sleeve: use a soft cloth sprayed with a multi-purpose spray lubricant (WD-40 or equivalent)
 - c. muffler – carbon-fiber outlet cap: use a soft dry cloth
 - d. titanium link pipes (muffler): use a soft cloth sprayed with a multi-purpose spray lubricant (WD-40 or equivalent)
 - e. stainless steel link pipes: use a soft cloth sprayed with a contact cleaner, then wipe with a soft dry cloth
 - f. stainless steel optional Y-link pipe: use a soft cloth sprayed with a contact cleaner, then wipe with a soft dry cloth

Cleaning will prevent spots from burning onto the surface. Do not use aggressive chemical cleaners, because they can damage the sticker.

3. install all of the dismantled stock parts and cowlings in the reverse order from the order in which they were removed
4. position of the installed Akrapovic Slip-on or Slip-on SP series system (**Figure 47, 48**)

Check the operation of the brakes and suspension. Make sure all the bolts are sufficiently tightened. In case the exhaust system touches the cowling or other parts repeat the adjustment of the exhaust system or contact your authorized dealer.

! IT IS NORMAL IF WHITE SMOKE COMES OUT OF THE MUFFLER ON FIRST OPERATION.

! DO NOT STAND BEHIND THE MUFFLER ON FIRST OPERATION.

MAINTENANCE OF THE AKRAPOVIC EXHAUST SYSTEM

1. Clean the titanium muffler outer sleeve with a multi-purpose spray lubricant (WD-40 or equivalent) and carbon fiber outer sleeve with soft and dry cloth. Do not use aggressive chemical cleaners, because they can damage the sticker. A change in the color of the exhaust system is normal due to the high temperatures.
2. The wearing out of the muffler silencing material depends on the type of the motor and riding style. Contact your dealer/serviceman if visible changes appear on muffler's outer sleeve or the noise level is increased.
3. Periodically ensure that all the bolts and springs are sufficiently tight.

Photos:

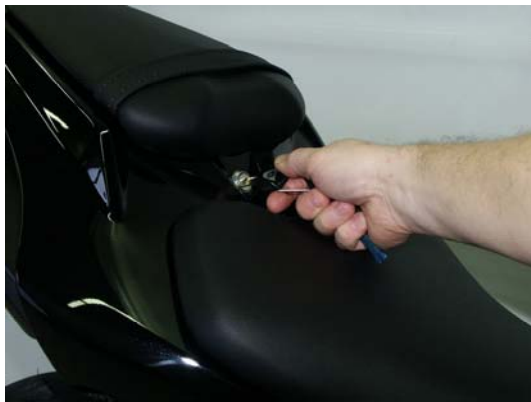

Figure 1



Figure 2



Figure 3



Figure 4



Figure 5



Figure 6



Figure 7



Figure 8



Figure 9



Figure 10



Figure 11



Figure 12

FOR OPTIONAL Y-LINK PIPE ONLY: REMOVAL OF STOCK Y- LINK PIPE



Figure 13

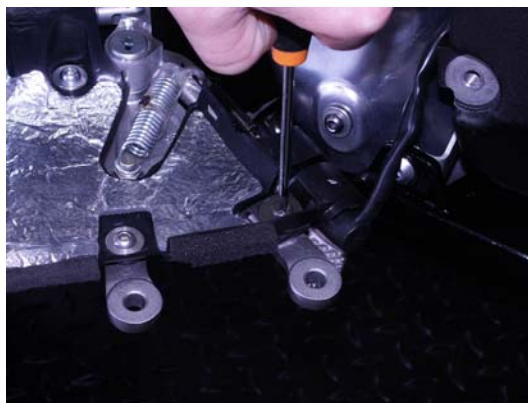

Figure 14

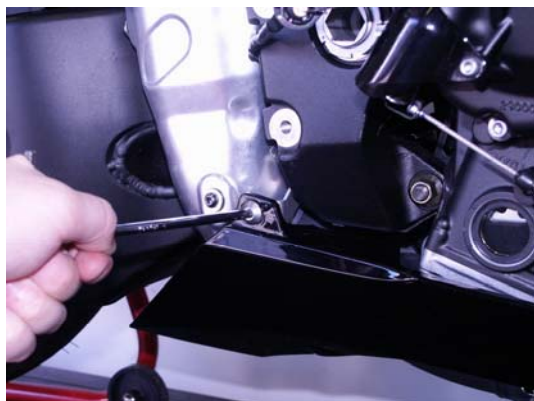

Figure 15



Figure 16



Figure 17



Figure 18



Figure 19



Figure 20



Figure 21



Figure 22



Figure 23

FOR OPTIONAL Y-LINK PIPE ONLY: INSTALATION OF AKRAPOVIC Y-LINK PIPE



Figure 24



Figure 25



Figure 26



Figure 27



Figure 28

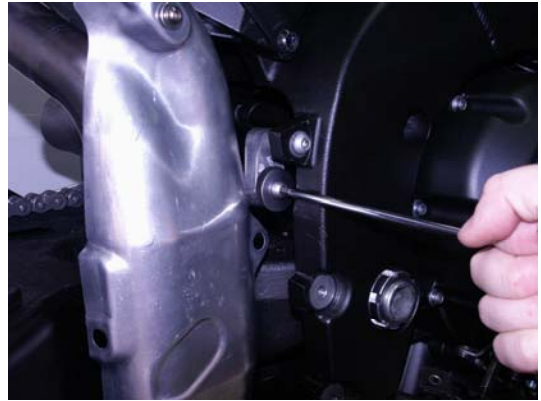

Figure 29



Figure 30



Figure 31

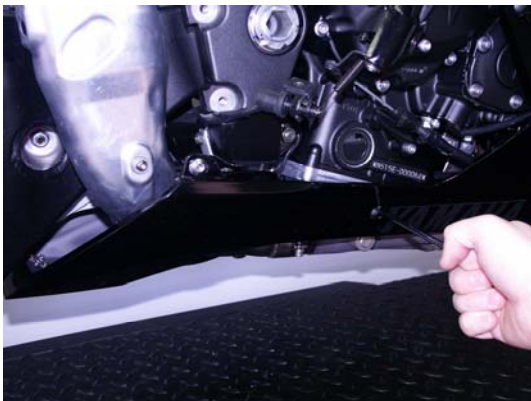

Figure 32



Figure 33



Figure 34



Figure 35



Figure 36



Figure 37



Figure 38

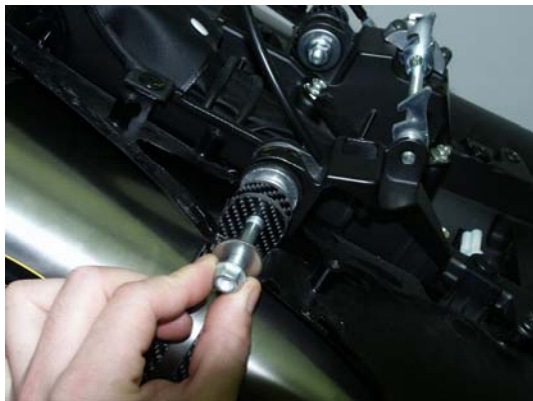

Figure 39

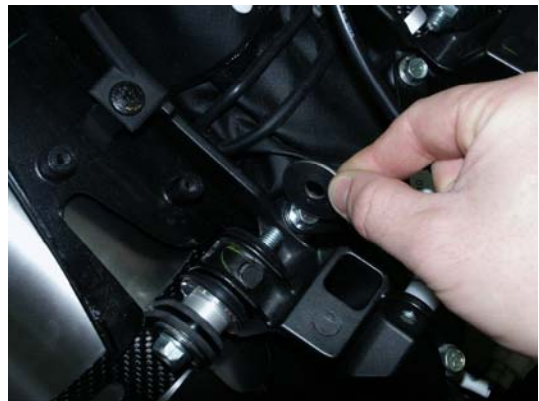

Figure 40



Figure 41



Figure 42



Figure 43



Figure 44



Figure 45



Figure 46



Figure 47



Figure 48

YAMAHA YZF R1 2007 / SLIP ON LINE

Product code: S-Y10SO8-DTC
S-Y10SO8-DTT

(L-Y10SO8) LINK PIPE OPTIONAL

(M-Y10SO8-DTCL) TITANIUM/CARBON-FIBER OUTER SLEEVE MUFFLER/LEFT
(M-Y10SO8-DTTL) FULL TITANIUM MUFFLER/LEFT

(P-MCCD12) CARBON-FIBER CLAMP FOR CARBON-FIBER OUTER SLEEVE MUFFLER
(P-MCTD12) CARBON-FIBER CLAMP FOR TITANIUM OUTER SLEEVE MUFFLER

(P-HF238) FITTING ASSEMBLY

(P-HF239) FITTING PART

(P-HF107) FITTING ASSEMBLY

(M-Y10SO8-DTCR) TITANIUM/CARBON-FIBER OUTER SLEEVE MUFFLER/RIGHT
(M-Y10SO8-DTTR) FULL TITANIUM MUFFLER/RIGHT

(P-ST2A) STICKER

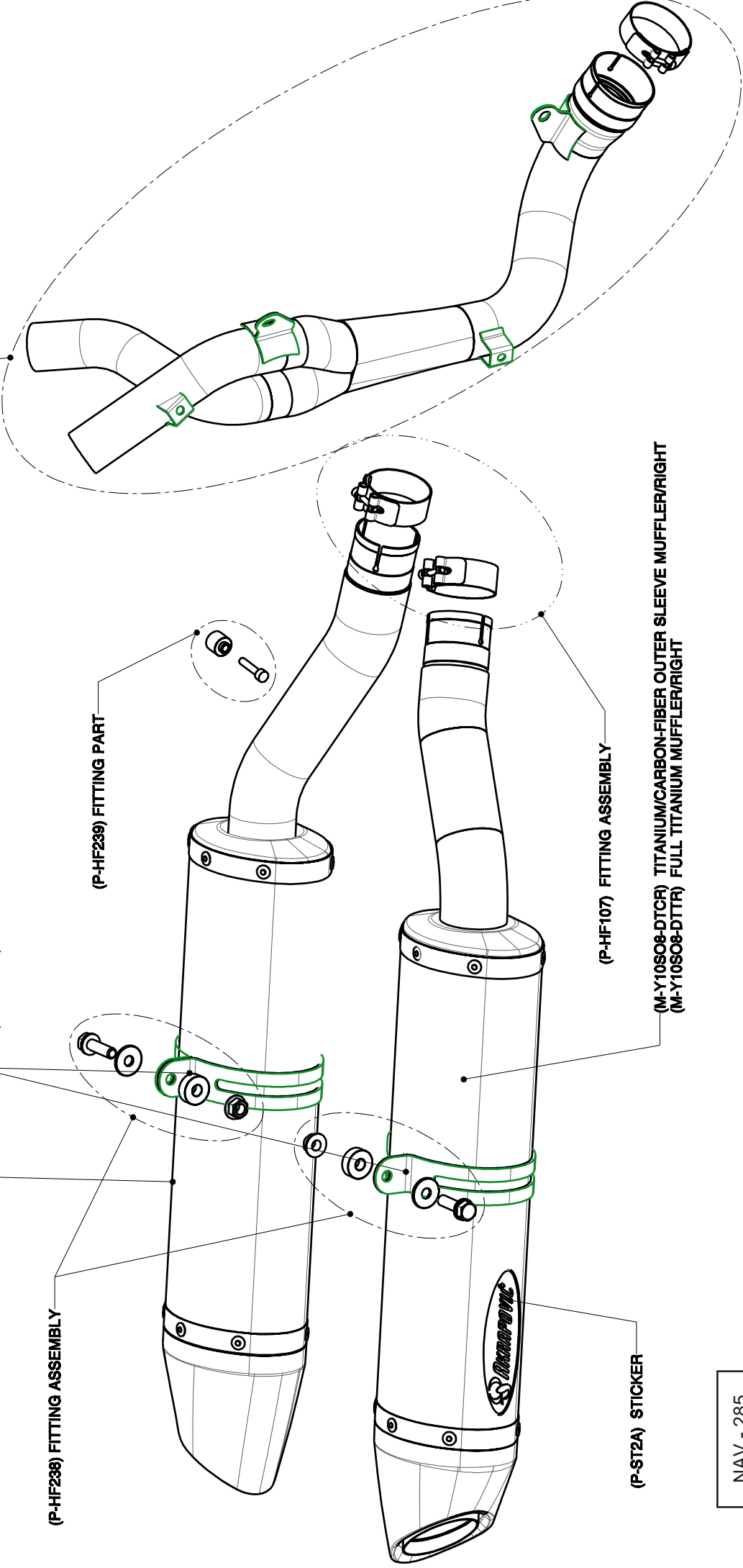

YAMAHA YZF R1 2007 / SLIP ON LINE STREET LEGAL (E3)

Product code: S-Y10SO8-HDTC
S-Y10SO8-HDTT

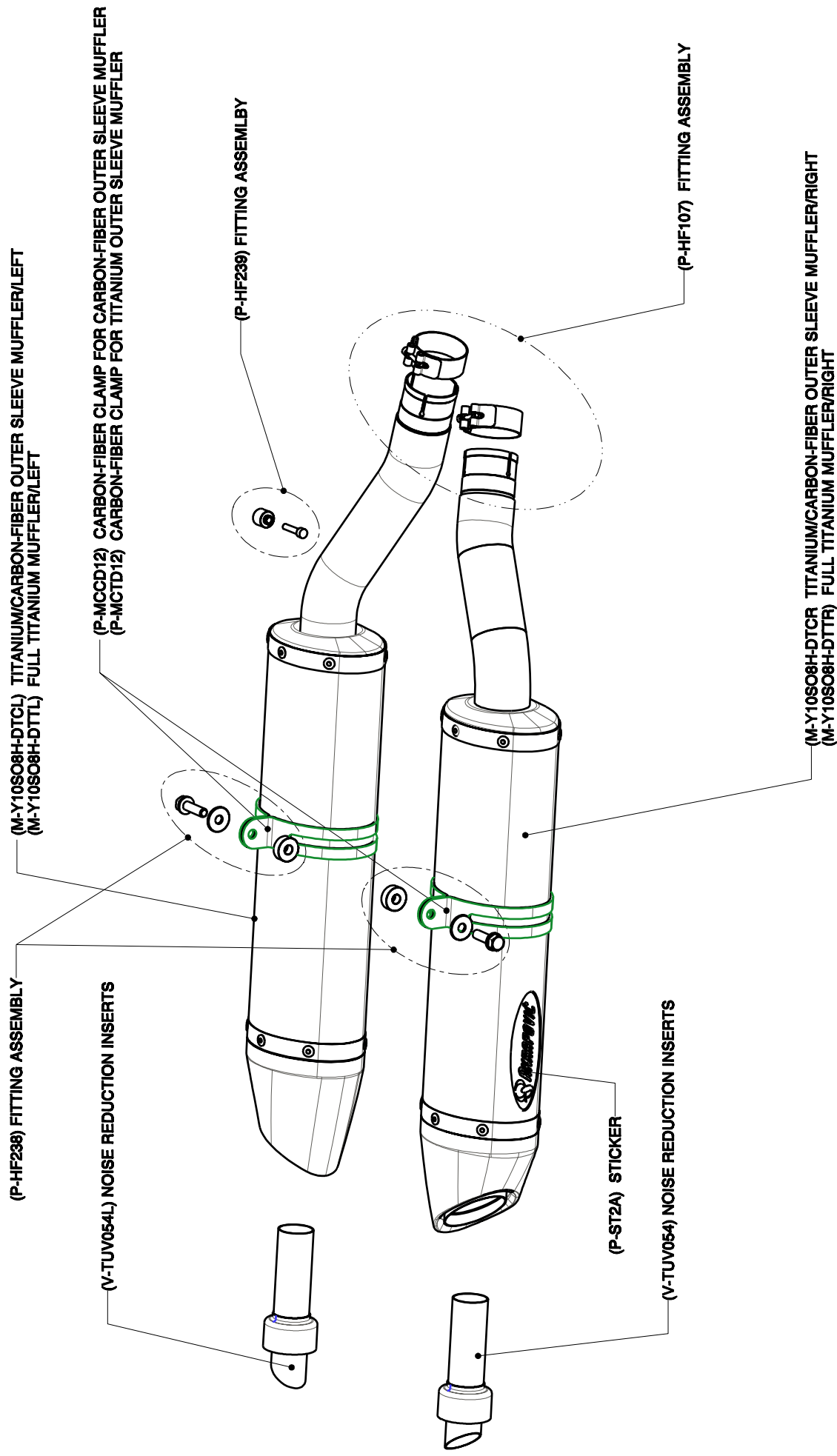

YAMAHA YZF R1 2007 / SLIP ON LINE SP SERIES

Product code:SS-Y10SO8-DC
SS-Y10SO8-DT

L-Y10SO8 LINK PIPE OPTIONAL

P-MCCD12 CARBON-FIBER CLAMP FOR CARBON-FIBER OUTER SLEEVE MUFFLER
P-MCTD12 CARBON-FIBER CLAMP FOR TITANIUM OUTER SLEEVE MUFFLER

MS-Y10SO8-DCL MUFFLER:SS INLET CAP/CARBON-FIBER OUTER SLEEVE/SS OUTLET CAP
MS-Y10SO8-DTL MUFFLER:SS INLET CAP/TITANIUM OUTER SLEEVE/SS OUTLET CAP

P-HF238 FITTING ASSEMBLY

P-HF239 FITTING PART

P-HF107 FITTING ASSEMBLY

MS-Y10SO8-DCR MUFFLER:SS INLET CAP/CARBON-FIBER OUTER SLEEVE/SS OUTLET CAP
MS-Y10SO8-DTR MUFFLER:SS INLET CAP/TITANIUM OUTER SLEEVE/SS OUTLET CAP

PS-ST2A STICKER

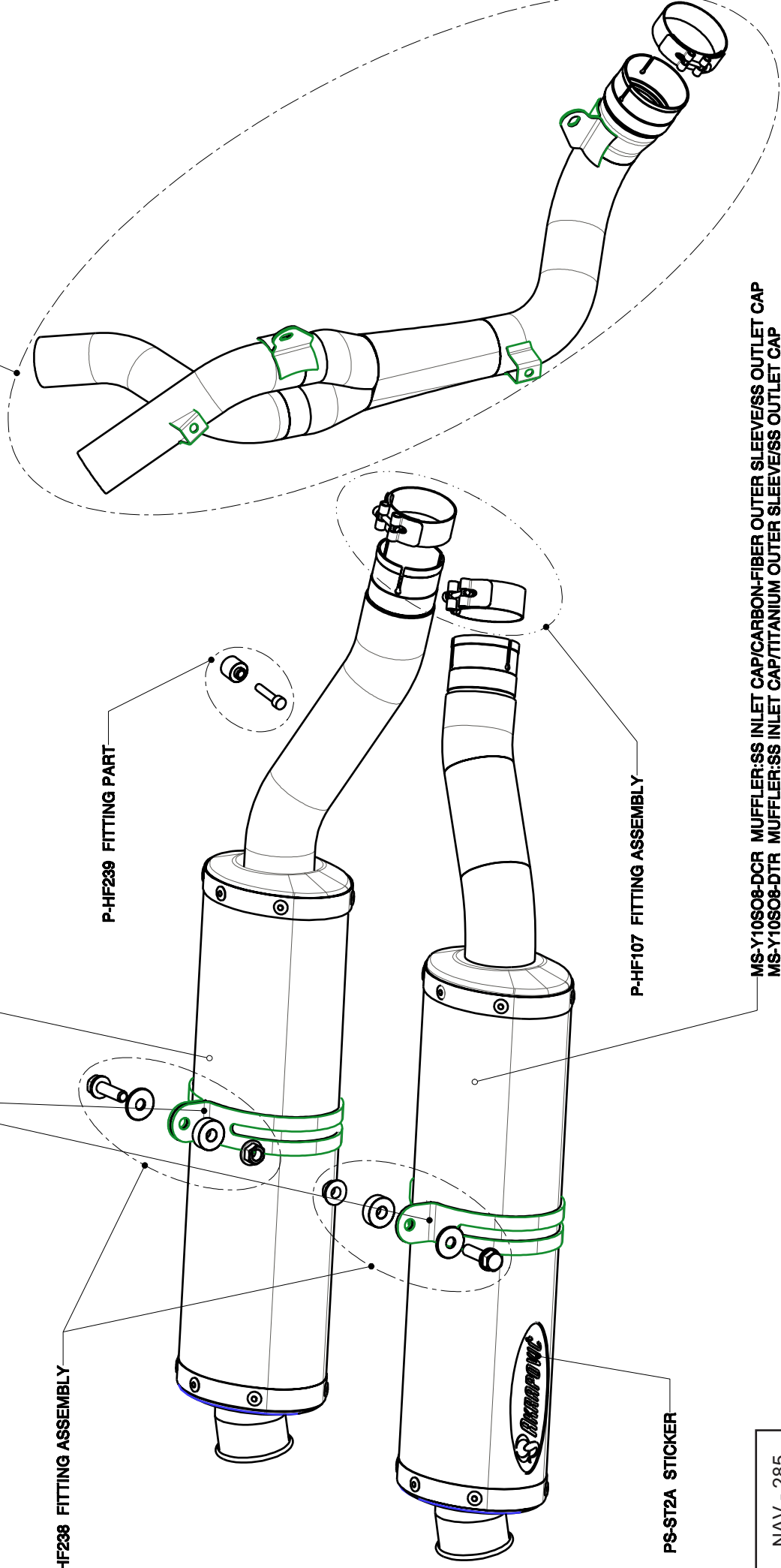

YAMAHA YZF R1 2007 / SLIP ON LINE SP SERIES STREET LEGAL (E3)

Product code:SS-Y10SO8-HDC
SS-Y10SO8-HDT

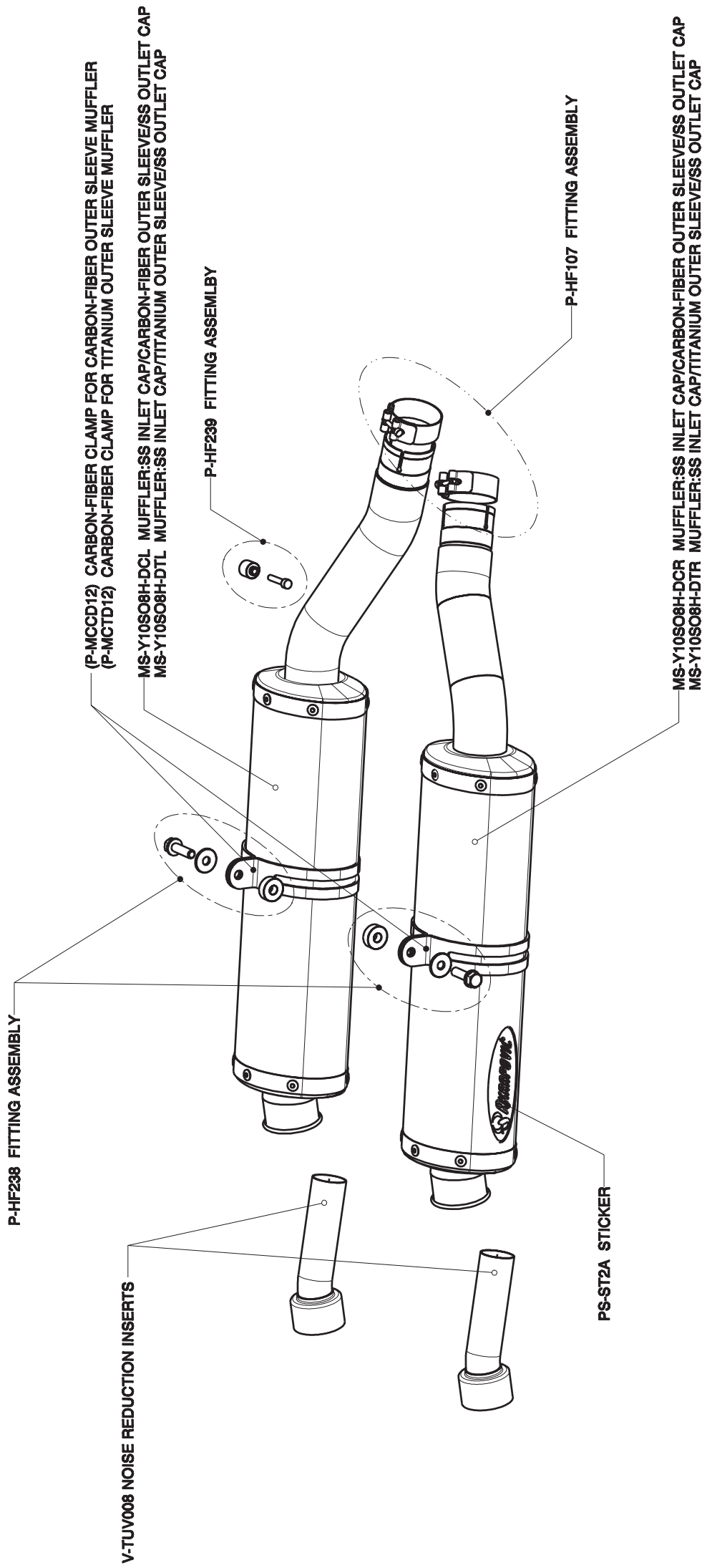

YAMAHA YZF R1 2007/ Complete exhaust system/ EVOLUTION LINE tube set with Street legal SLIP ON Mufflers, Model year: 2007

**Product code: S-Y10R10-DTC/1
S-Y10R10-DTT/1**

WARNING! IN CASE OF COMBINATION WITH EVOLUTION TUBE SET THE SLIP-ON HOMOLOGATION IS NOT VALID!

